

- Revisions**
- "B" - Mar., 1979
  - "C" - Jan., 1980
  - "D" - May, 1980
  - "E" - Dec., 1981
  - "F" - Jun., 1983
  - G - Sept., 1985
  - H - Apr., 1986
  - I - Dec., 1987

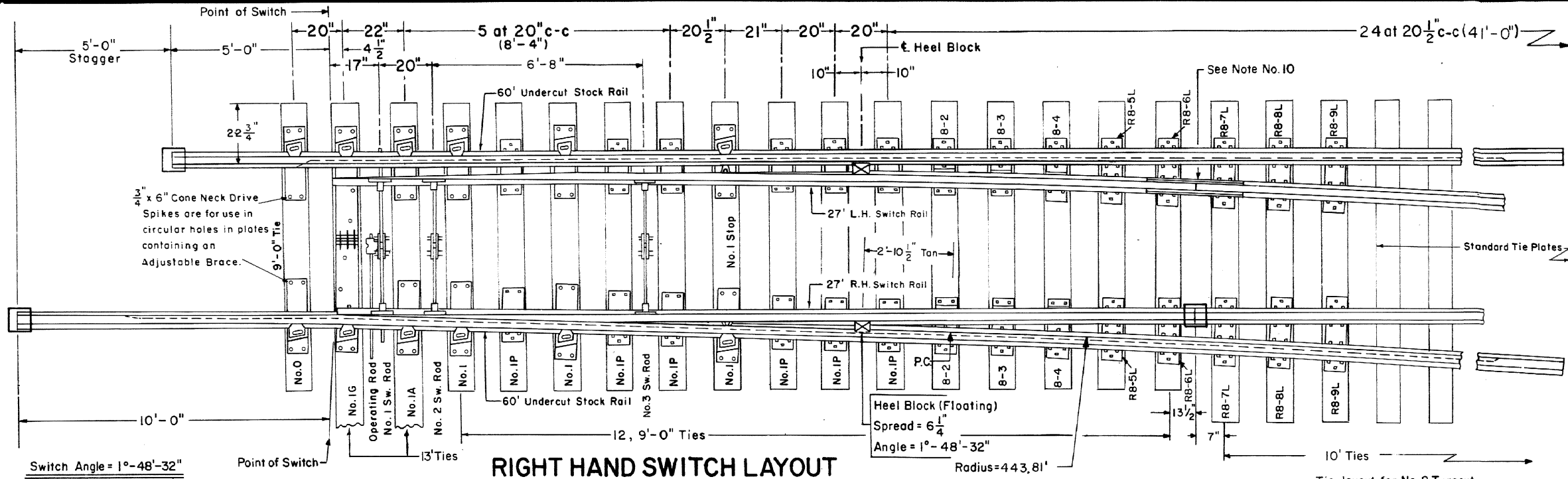

Switch Angle =  $1^{\circ}-48'-32''$

### RIGHT HAND SWITCH LAYOUT

Tie layout for No. 8 Turnout  
see Conrail Plan 73184-(), Sheet 1

Side Planing =  $7'-10 \frac{1}{4}''$

- "B" =  $1''$  dia. H.T. machine bolts with square nuts, spring washers,  $\frac{1}{4}''$  cotter pins. Hex nuts at rocker clips.
- "R" =  $\frac{3}{4}''$  dia. rivets.
- "S" =  $\frac{3}{4}''$  dia. machine bolts for stops with square nuts, spring washers and  $\frac{3}{16}''$  cotter pins.

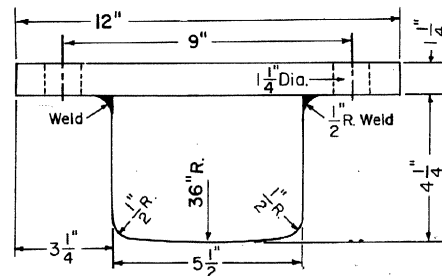

### FLOATING HEEL BLOCK

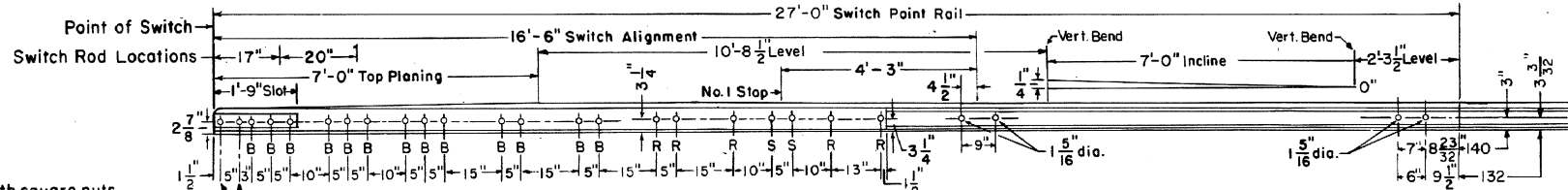

### ELEVATION OF SWITCH RAIL

### NOTES

- 1- This plan is for use with A.R.E.A. recommended standards for 132 R.E.
- 2- Workmanship and materials shall be as per current A.R.E.A. Specifications.
- 3- Gage Plate I-G as shown on Conrail Plan 73519-().
- 4- Switch Plates No. 0, 1, IA, IP as shown on Conrail Plan 73519-().
- 5- Turnout Plates No. 2 thru No. 9 as shown on Conrail Plan 72220-().
- 6- Stock Rails to be undercut as per Conrail Plan 73062-().
- 7- Switch Rail to be undercut per A.R.E.A. Design 5100.
- 8- All rails to be Fully Heat Treated.
- 9- Vertical insulated switch rods and adjustable rocker clips as per Conrail Plan 73518-().
- 10- All rails, including switch rails, to be drilled per Conrail Plan 71015-() for 132 R.E. rail, except that first hole is not to be drilled by the manufacturer. Conrail forces to field drill first hole when necessary.
- 11- See Conrail Plan 73184-(), sheet 2, for Bill of Material.
- 12- See Conrail Plan 73181-() for Switch Offsets.

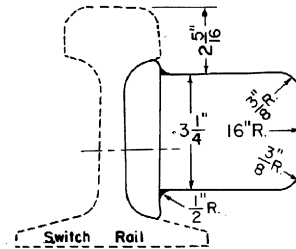

### SIDE VIEW

Indicates Field Weld

13- All bolts shall be dipped immediately before applying (so that all threads are thoroughly coated) in NO-OX-ID "GG" grease manufactured by Dearborn Chemical Co.



STANDARD  
**16'-6" STRAIGHT SPLIT SWITCH**  
**27' SWITCH RAILS WITH FLOATING HEEL BLOCKS**  
**FOR NO. 8 WELDED TURNOUT-132 R.E. RAIL**

*R.H. Smith*  
 Chief Engineer - Maintenance of Way

JANUARY 1978

*A.D. Carlson*  
 Chief Engineering Officer