



# Lake Division

2008









11/10/2008

CLEVELAND

001

BAY VILLAGE-BELLEVUE

LAKE

B198

B199

B200

3694'

5257'

5391'

MAINTENANCE

T&S-09/00  
S-11/07

RAIL

93NW196S  
93NW196S

65NW115S

65NW115S

TRAFFIC  
DENSITY MGT→ 7.4(16.3)  
← 8.9

5-OH(NYC&amp;SL)

BAY VILLAGE  
00197S  
E → W  
NBEGIN DEARBORN DIV  
197.32-1CAB-10'

199.25-1CAB-12'

CUYAHOGA CO  
LORAIN COTRACK  
LAYOUT

LINE SEGMENT

47224SV

472250P

472252D

7280

CAHOON CREEK  
CAHOON RD

BASSETT RD

BRADLEY RD  
WATERWAY

CURVATURE

ALIGNMENT

ELEVATION

FREIGHT SPEED  
TANGENT  
(CURVE)

50

GRADE

0.00

+0.05

-0.12

-0.17

-0.36

-0.46

-0.03

+0.10

+0.15

+0.12

11/10/2008

002

CLEVELAND

BAY VILLAGE-BELLEVUE

LAKE

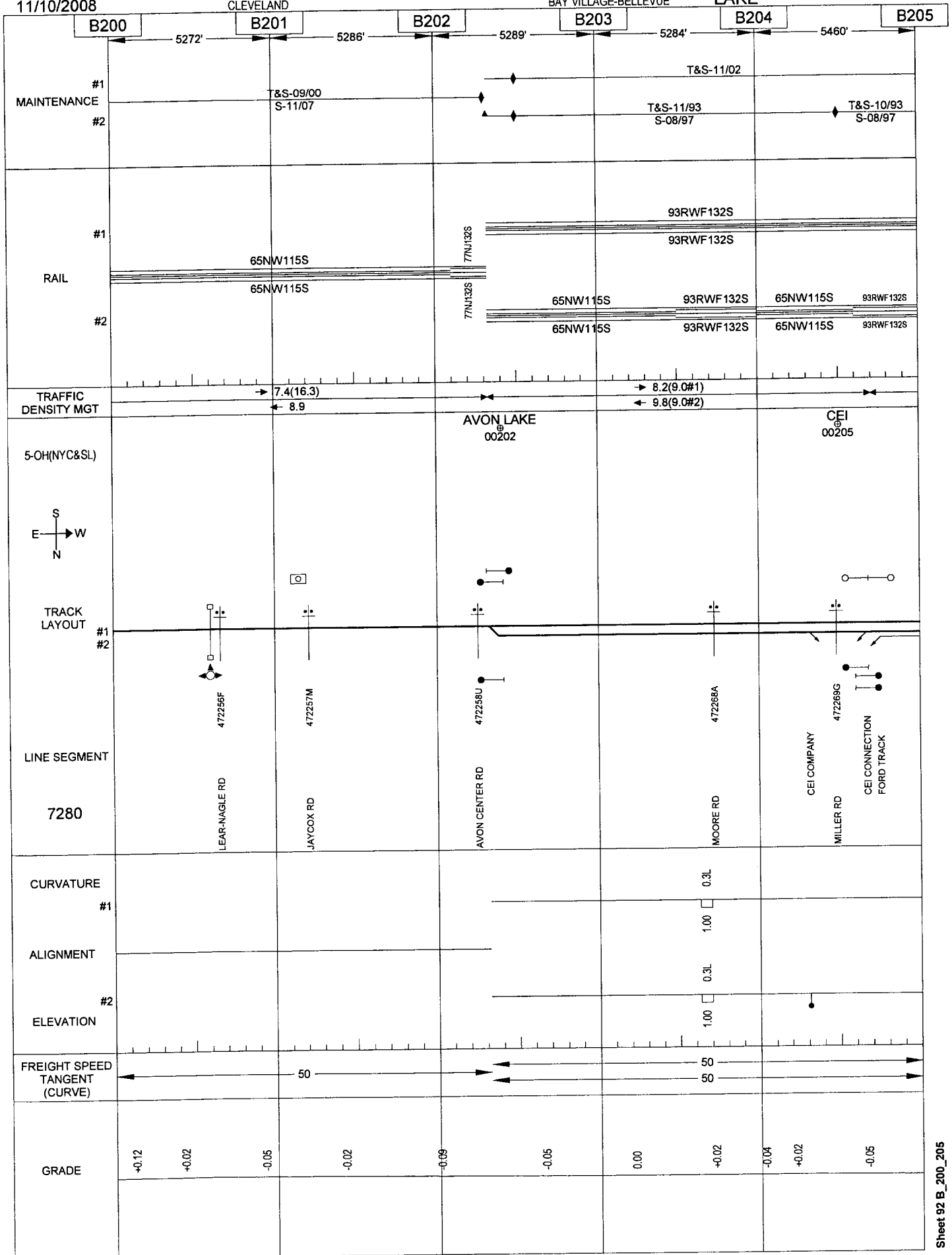

11/10/2008

CLEVELAND

003

BAY VILLAGE-BELLEVUE

LAKE

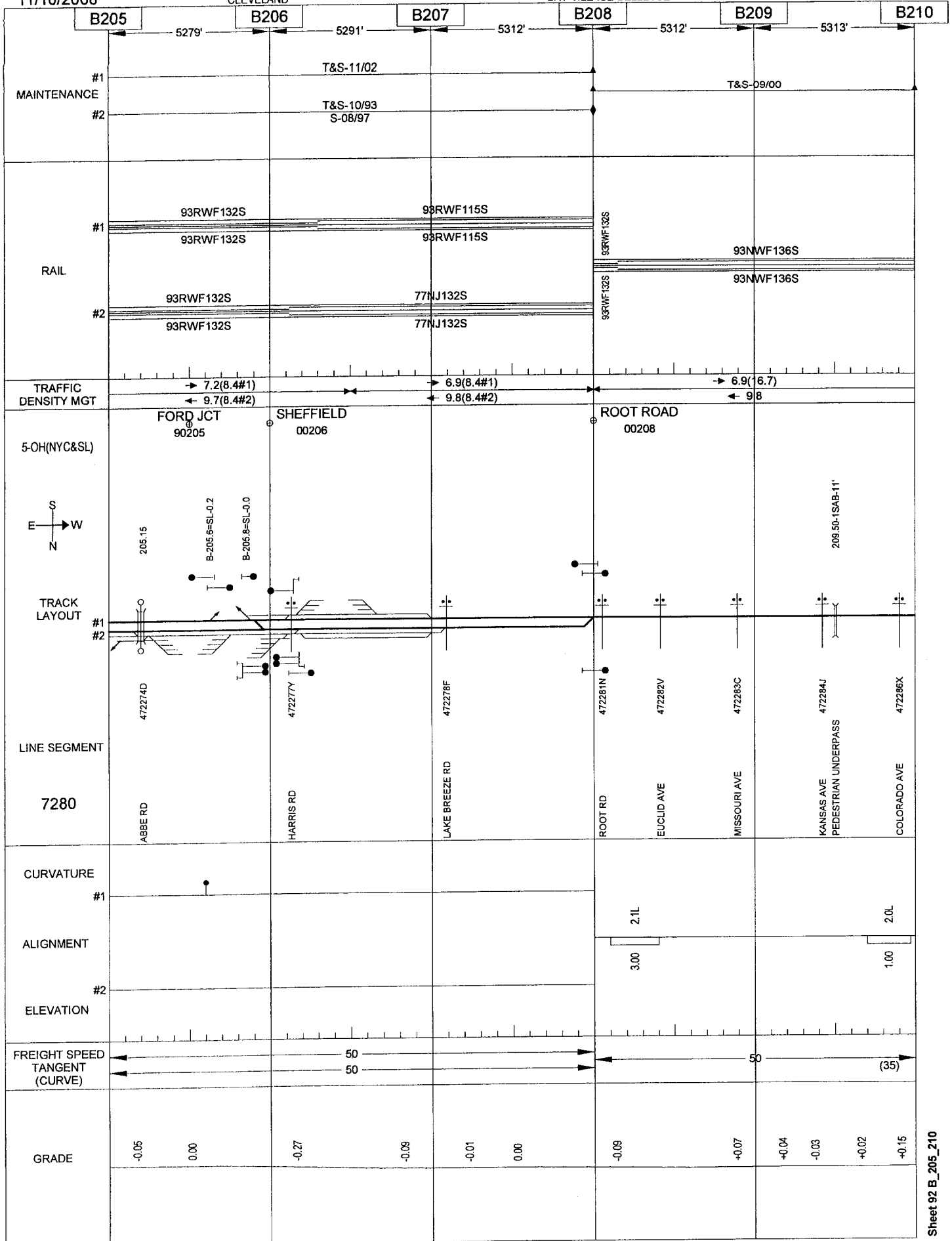

11/10/2008

004

CLEVELAND

BAY VILLAGE-BELLEVUE

LAKE

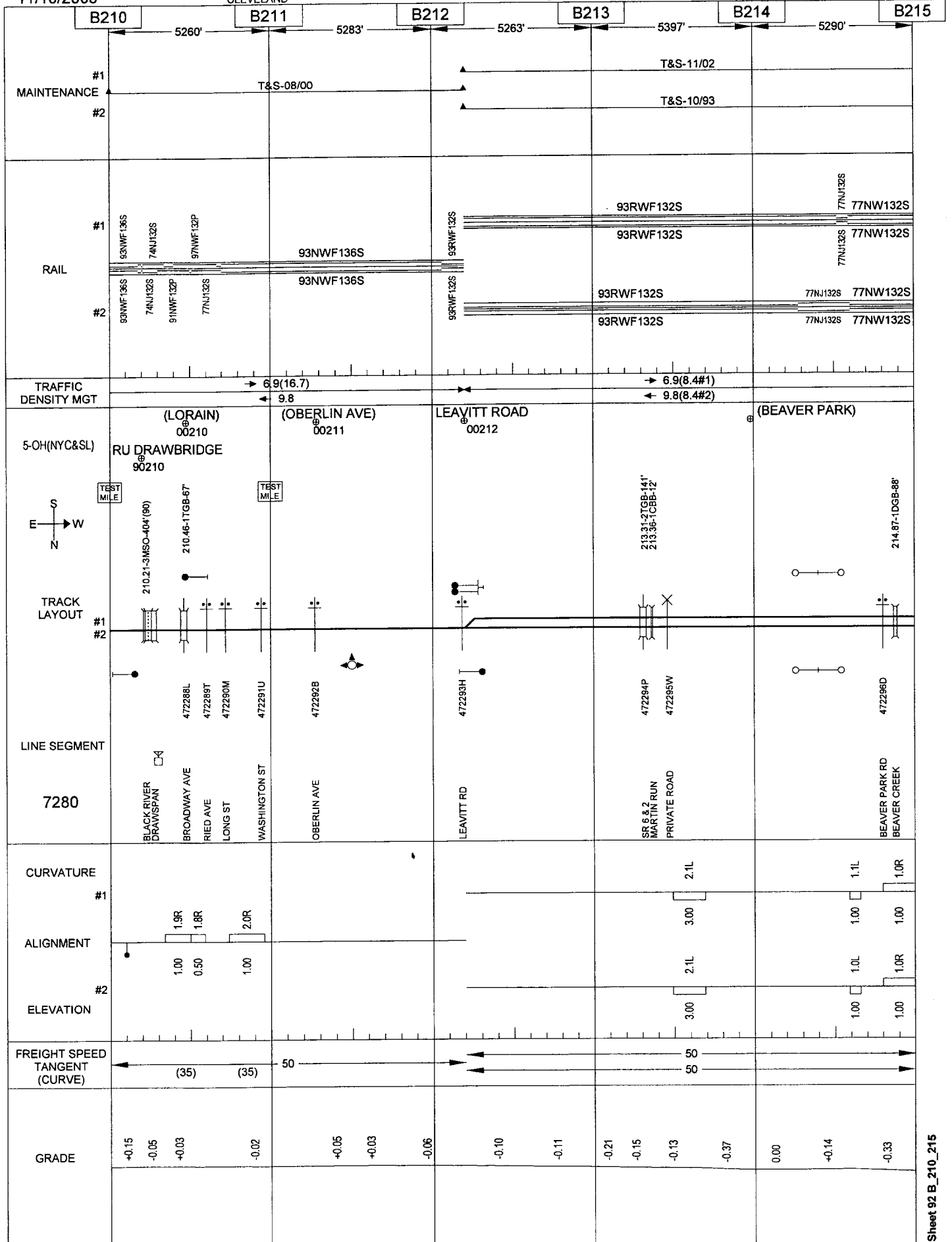

11/10/2008

005

CLEVELAND

BAY VILLAGE-BELLEVUE

LAKE

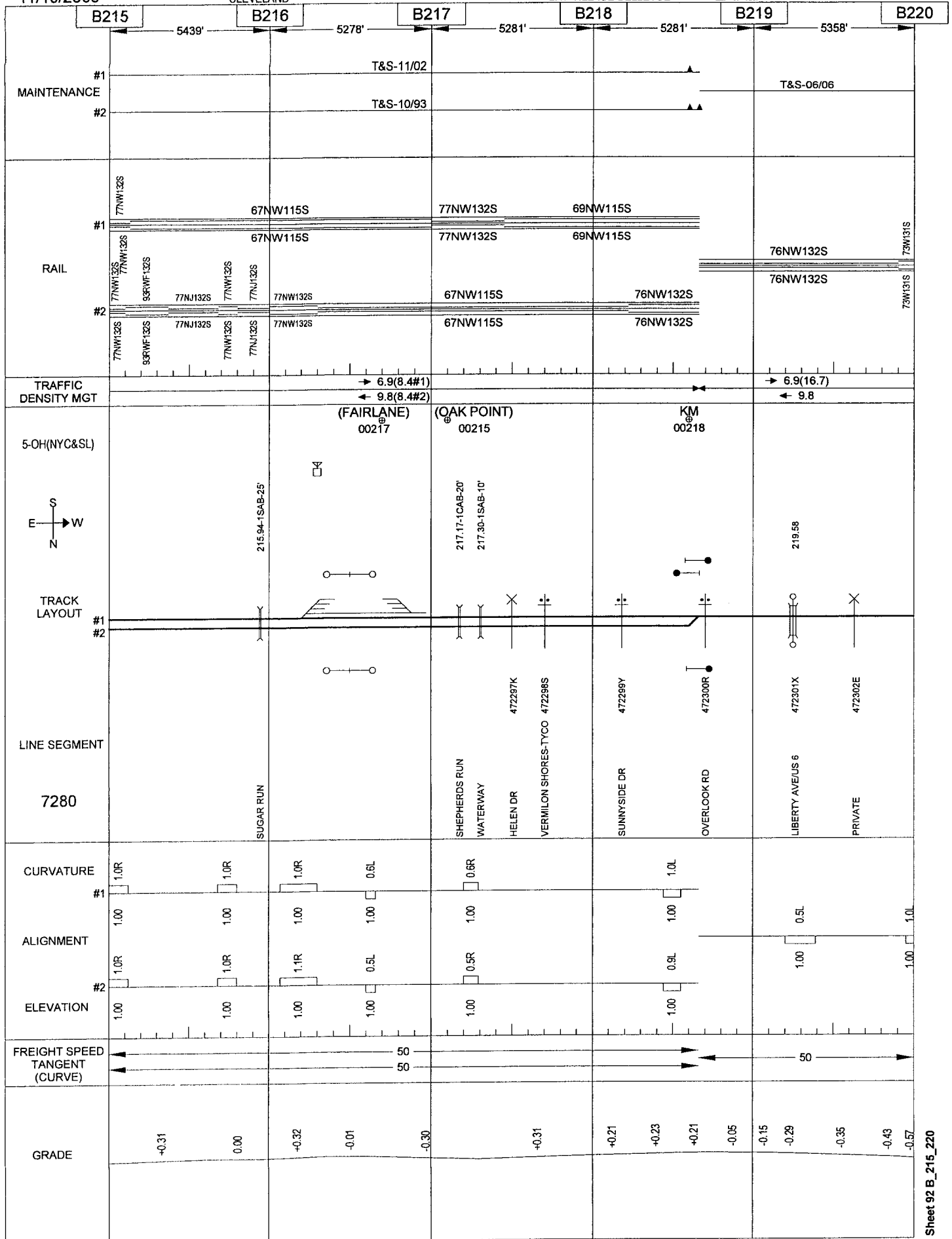

11/10/2008

CLEVELAND

006

BAY VILLAGE-BELLEVUE

LAKE

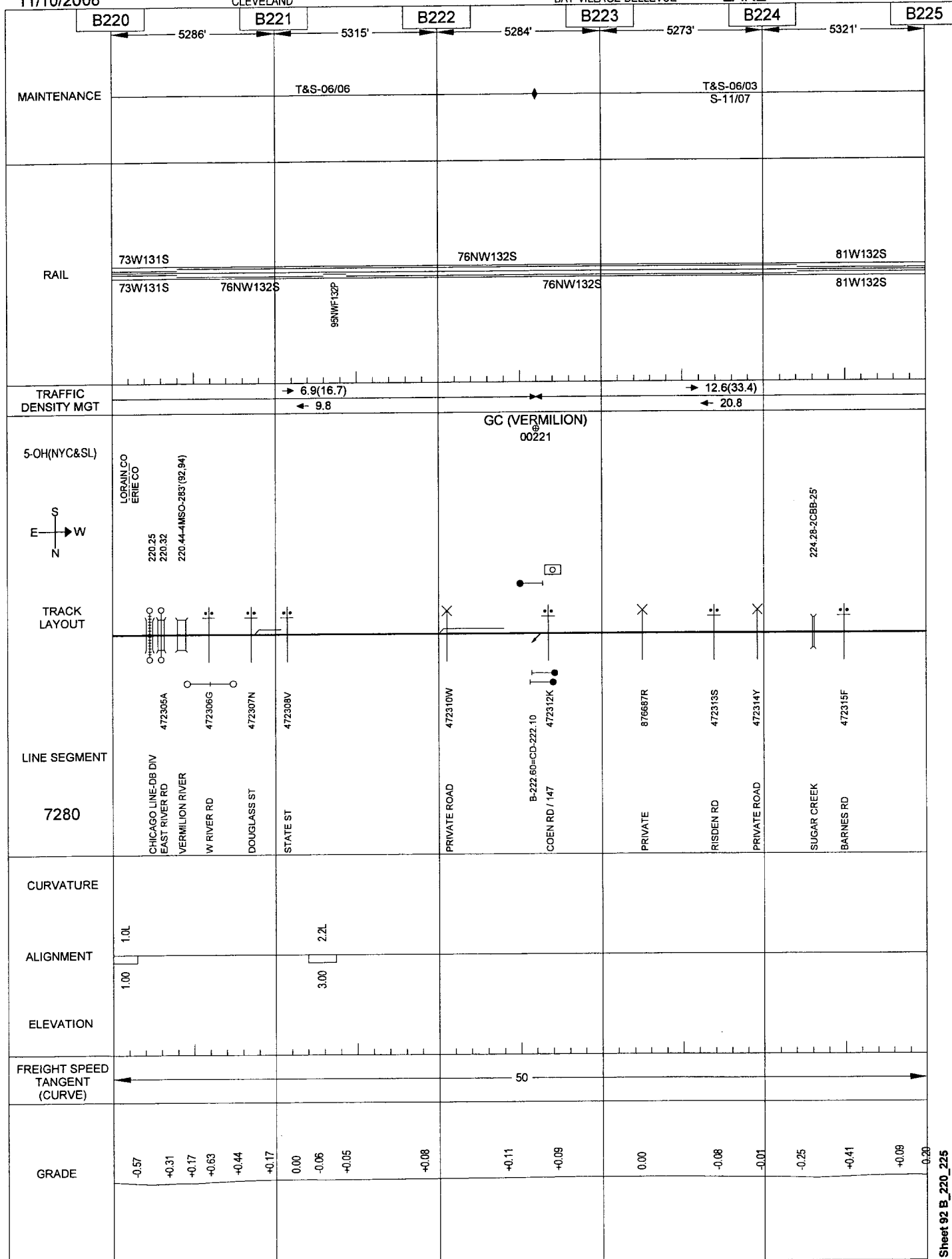



11/10/2008

008

CLEVELAND

BAY VILLAGE-BELLEVUE

LAKE

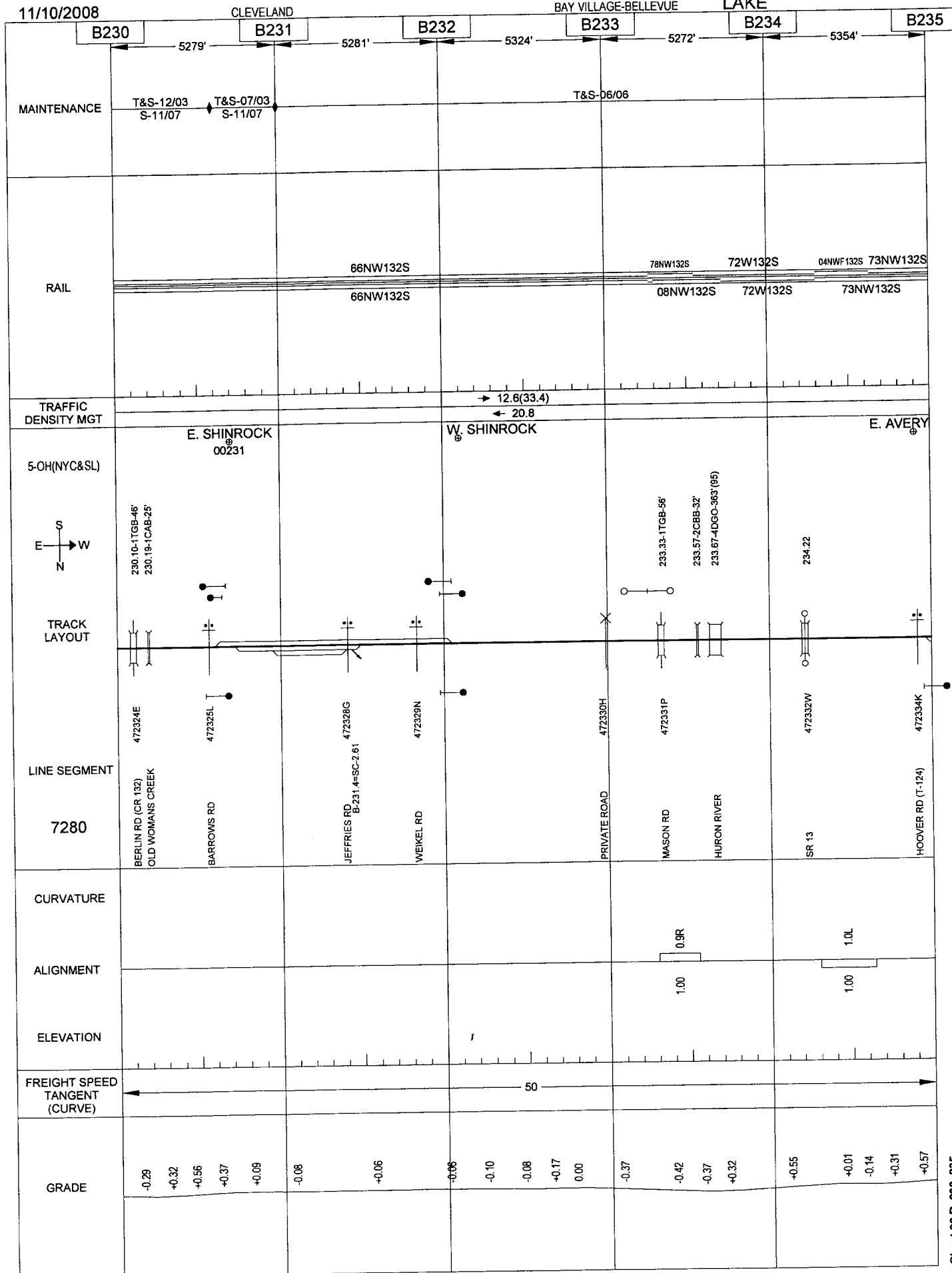

11/10/2008

009

CLEVELAND

BAY VILLAGE-BELLEVUE

LAKE

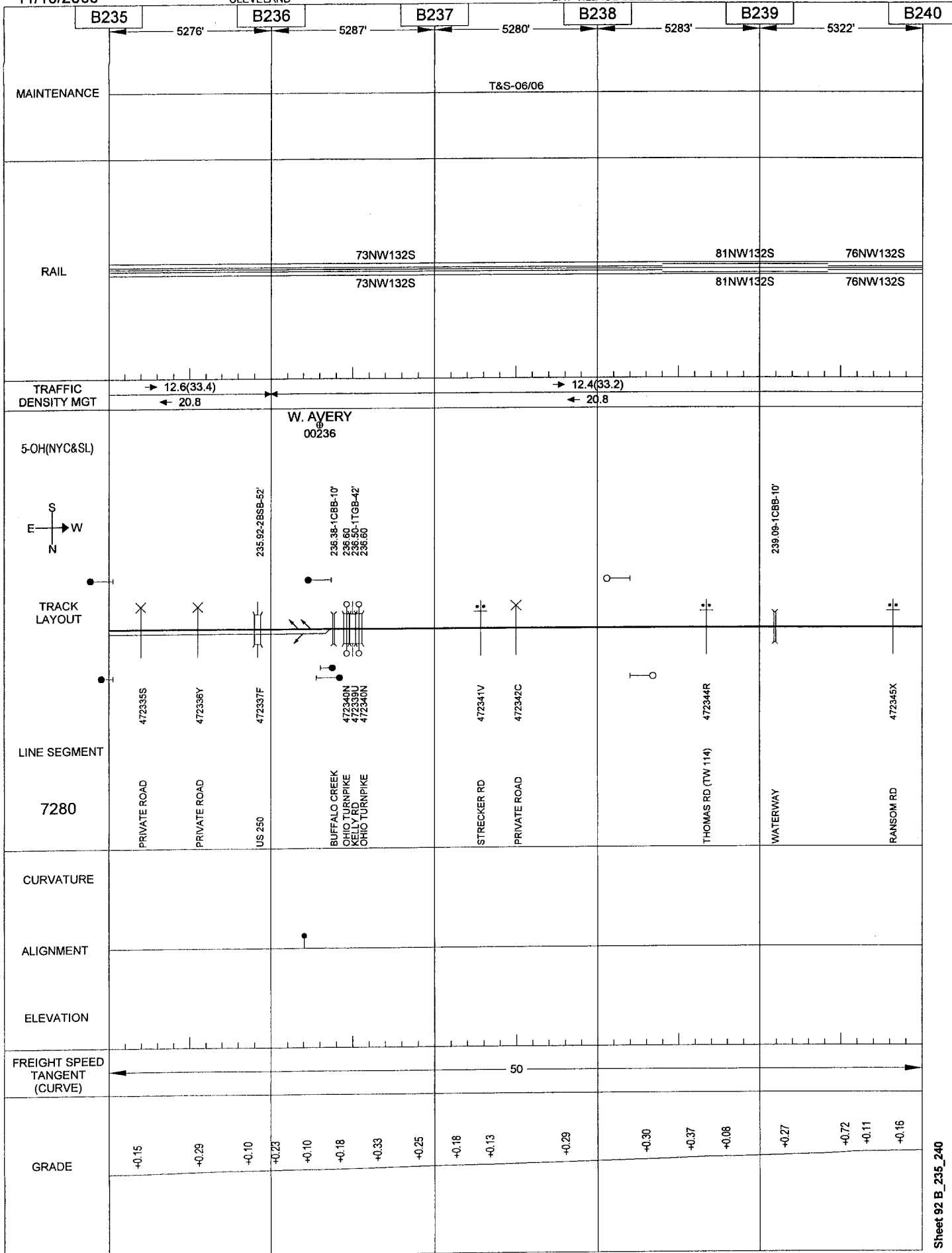

11/10/2008

010

CLEVELAND

BAY VILLAGE-BELLEVUE

LAKE

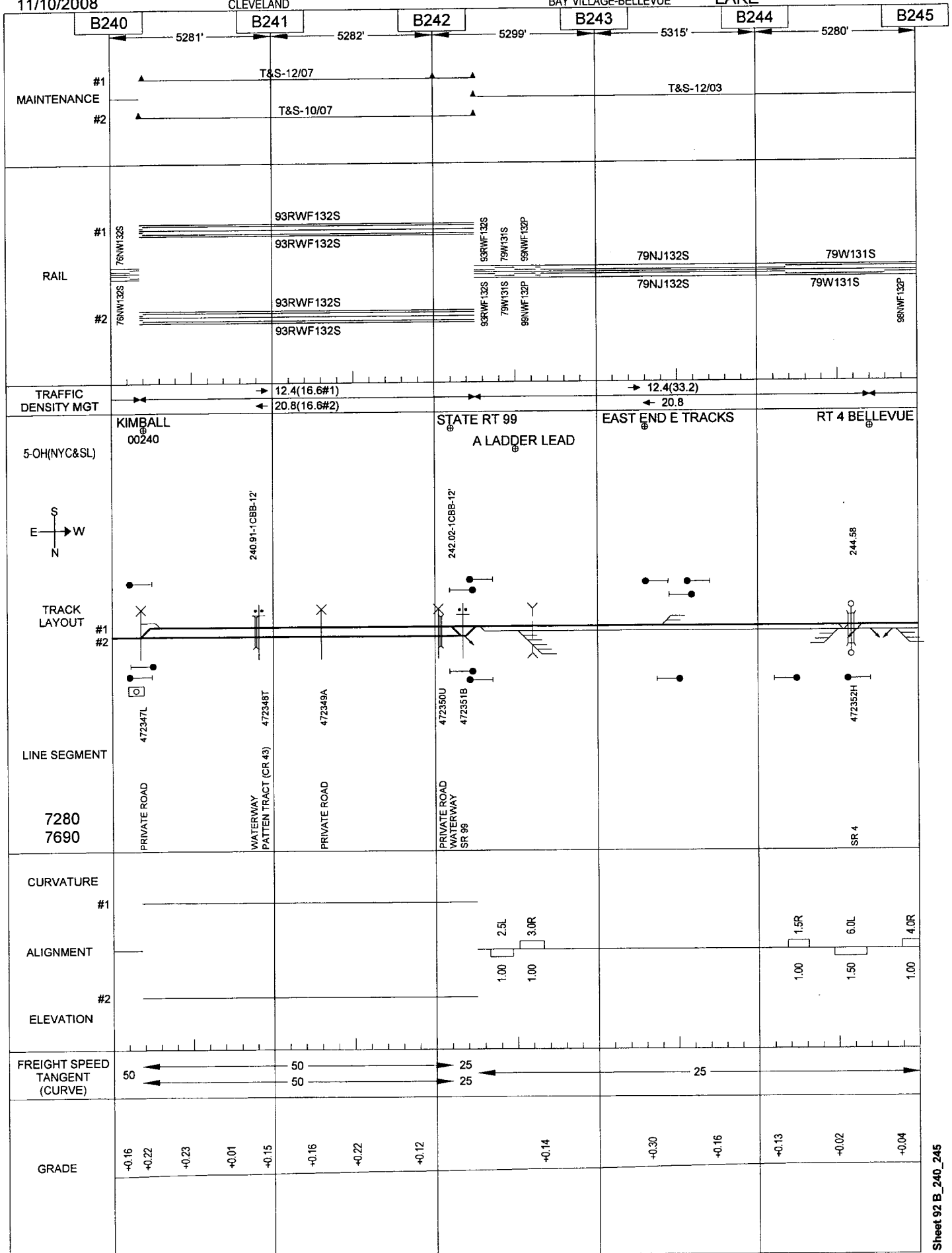

11/10/2008

FOSTORIA

011

BELLEVUE-FORT WAYNE

LAKE

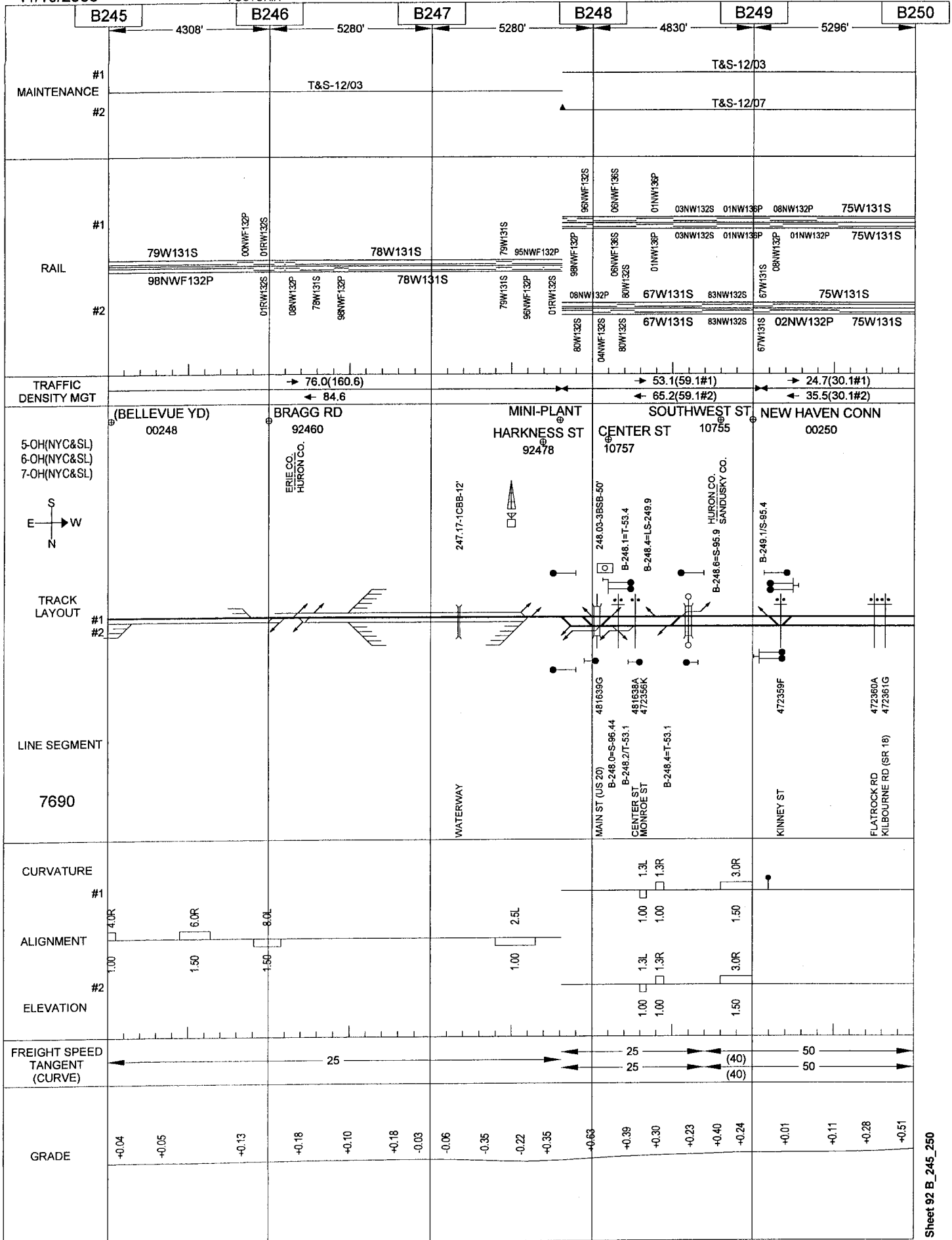





11/10/2008

014

FOSTORIA

BELLEVUE-FORT WAYNE

LAKE

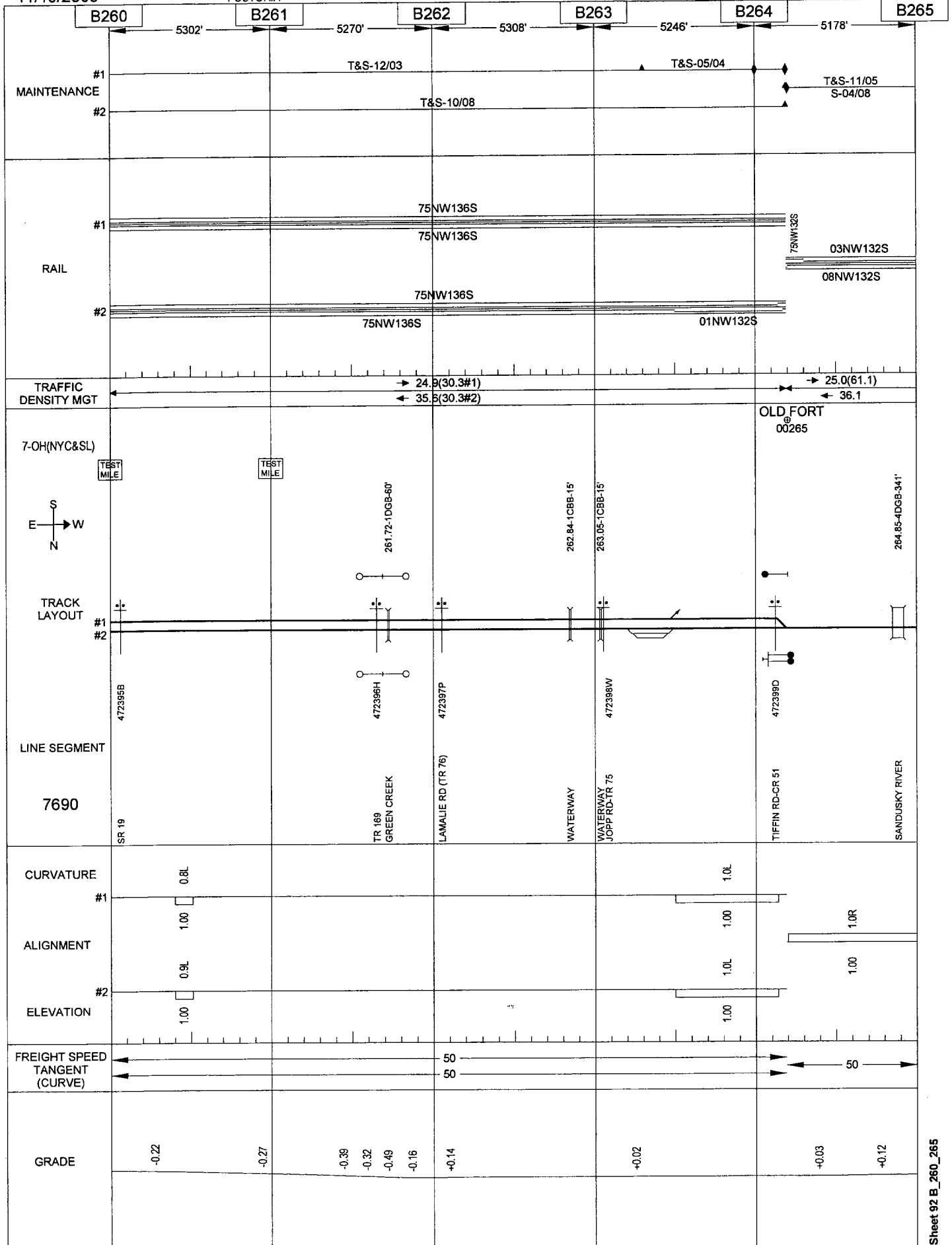

11/10/2008

015

FOSTORIA

BELLEVUE-FORT WAYNE

LAKE

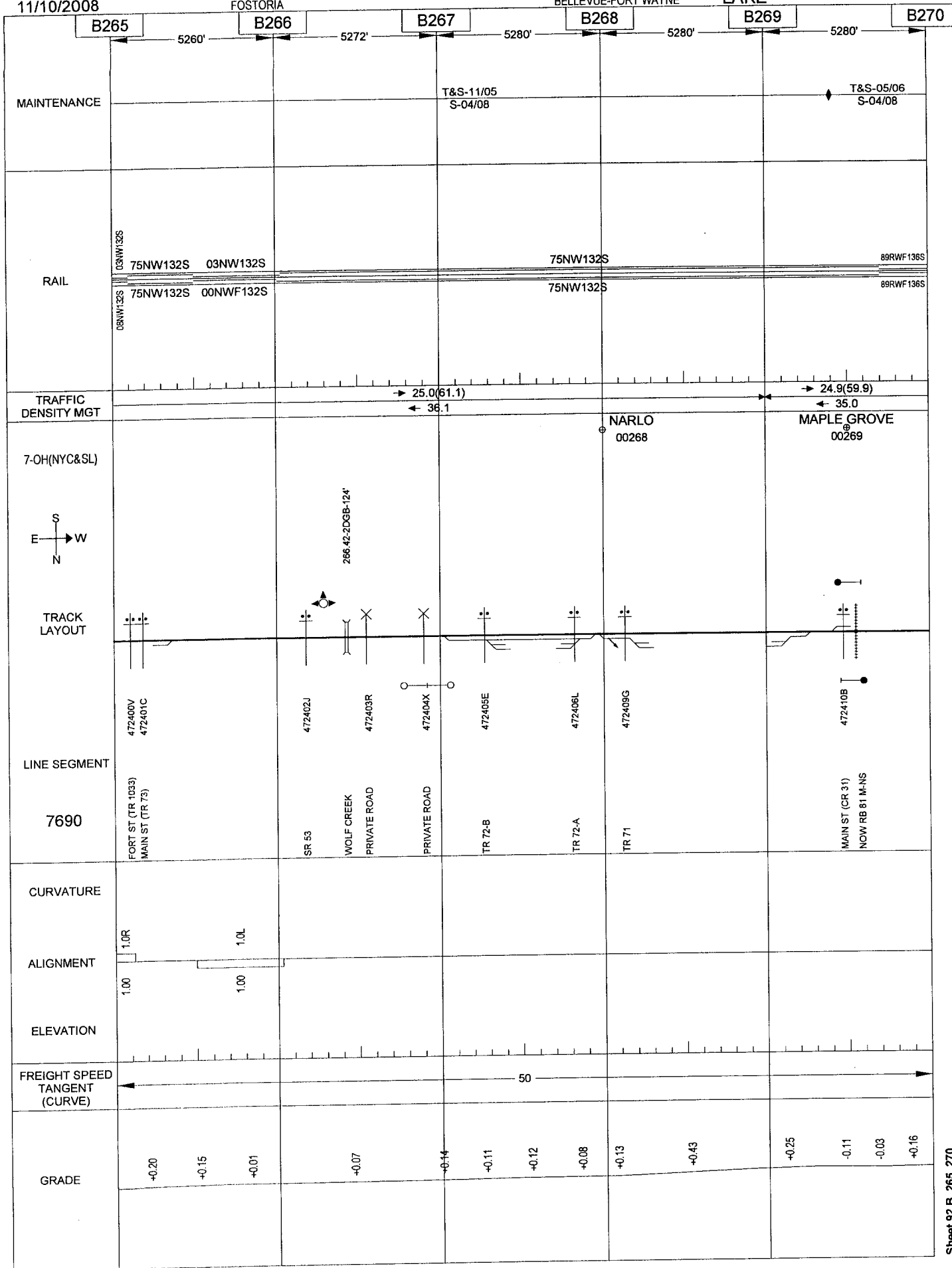

11/10/2008

FOSTORIA

016

BELLEVUE-FORT WAYNE

LAKE

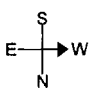
	B270	B271	B272	B273	B274	B275
	5348'	5298'	5296'	5306'	5280'	
MAINTENANCE			T&S-05/06 S-04/08			
RAIL	89RWF136S		75NW136S		89RWF136S	
	89RWF136S		75NW136S		89RWF136S	
TRAFFIC DENSITY MGT			→ 24.9(59.9) ← 35.0			
7-OH(NYC&SL)						
						
TRACK LAYOUT	X	•••	•••	X	•••	•••
LINE SEGMENT	472413W	472414D 472415K	472416S 472417Y	472418F 472419M	472420G	472421N
7690	PRIVATE ROAD	CR 11 TR 152	LOFT RD (TR 69) CATTLE PASS PRIVATE ROAD	PRIVATE ROAD SR 635	WATERWAY TR 101	CR 5
CURVATURE						
ALIGNMENT						
ELEVATION						
FREIGHT SPEED TANGENT (CURVE)			50			
GRADE	+0.16 +0.34 +0.31 -0.01	-0.08 -0.04 -0.01	+0.09 +0.02	0.00	+0.17 +0.09	













































































































































































































































































































































































































































































































































































































































































