

WESTERN
BRANCH

RAIL PROGRAM

DRAINAGE

RECONDITIONING TRACK

WESTERN
BRANCH



LIME CITY
TO
CORNING

(The direction from Lime City
to Corning is southward)

B-53

B-52

B-53

B-54

28
W-54

66-

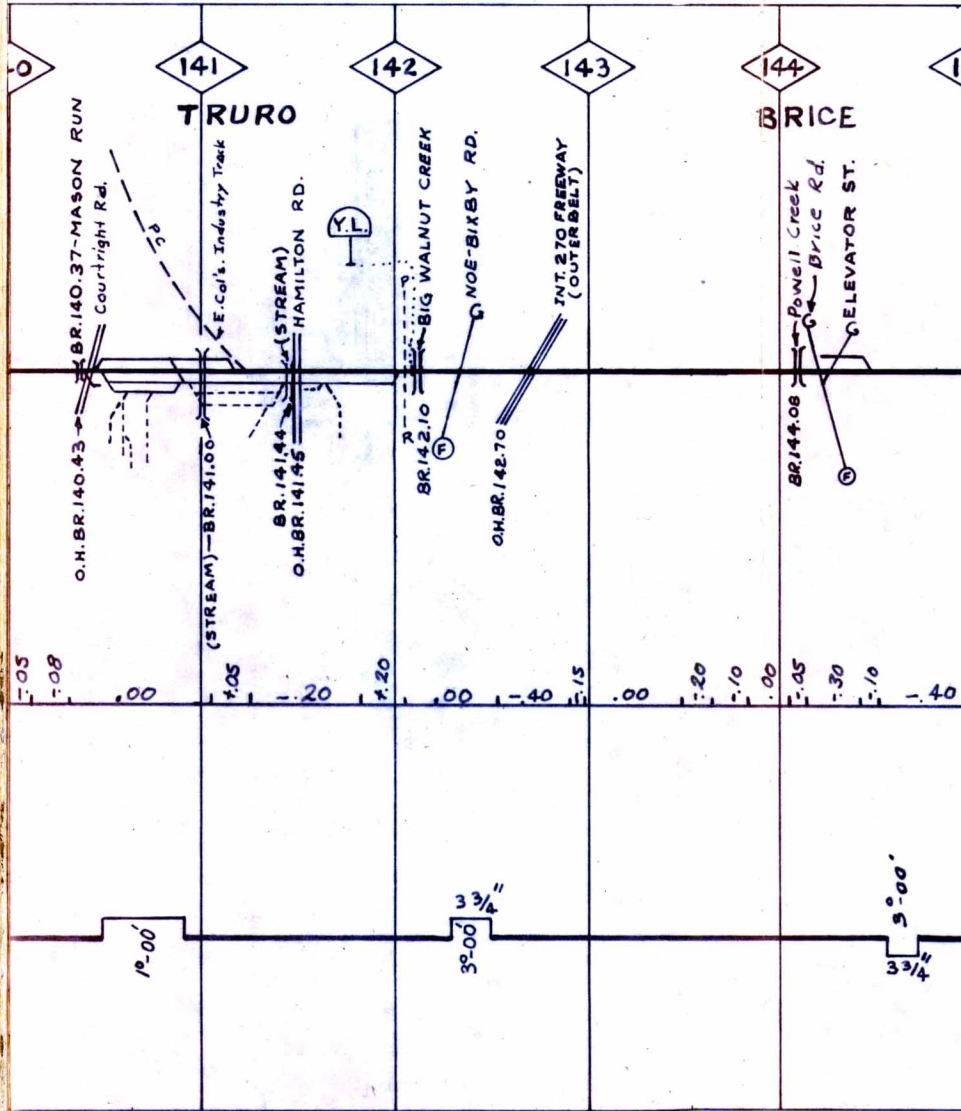

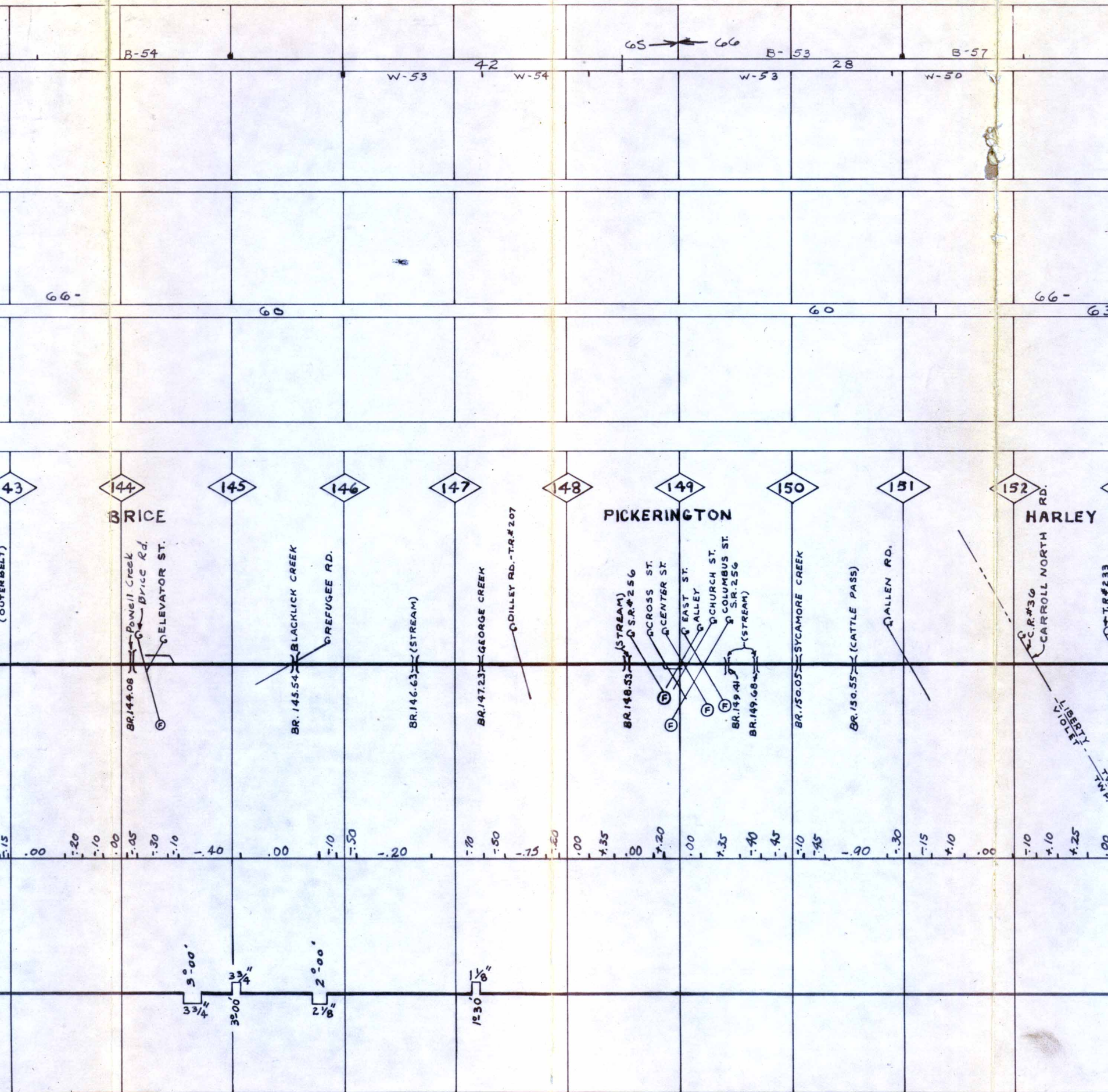

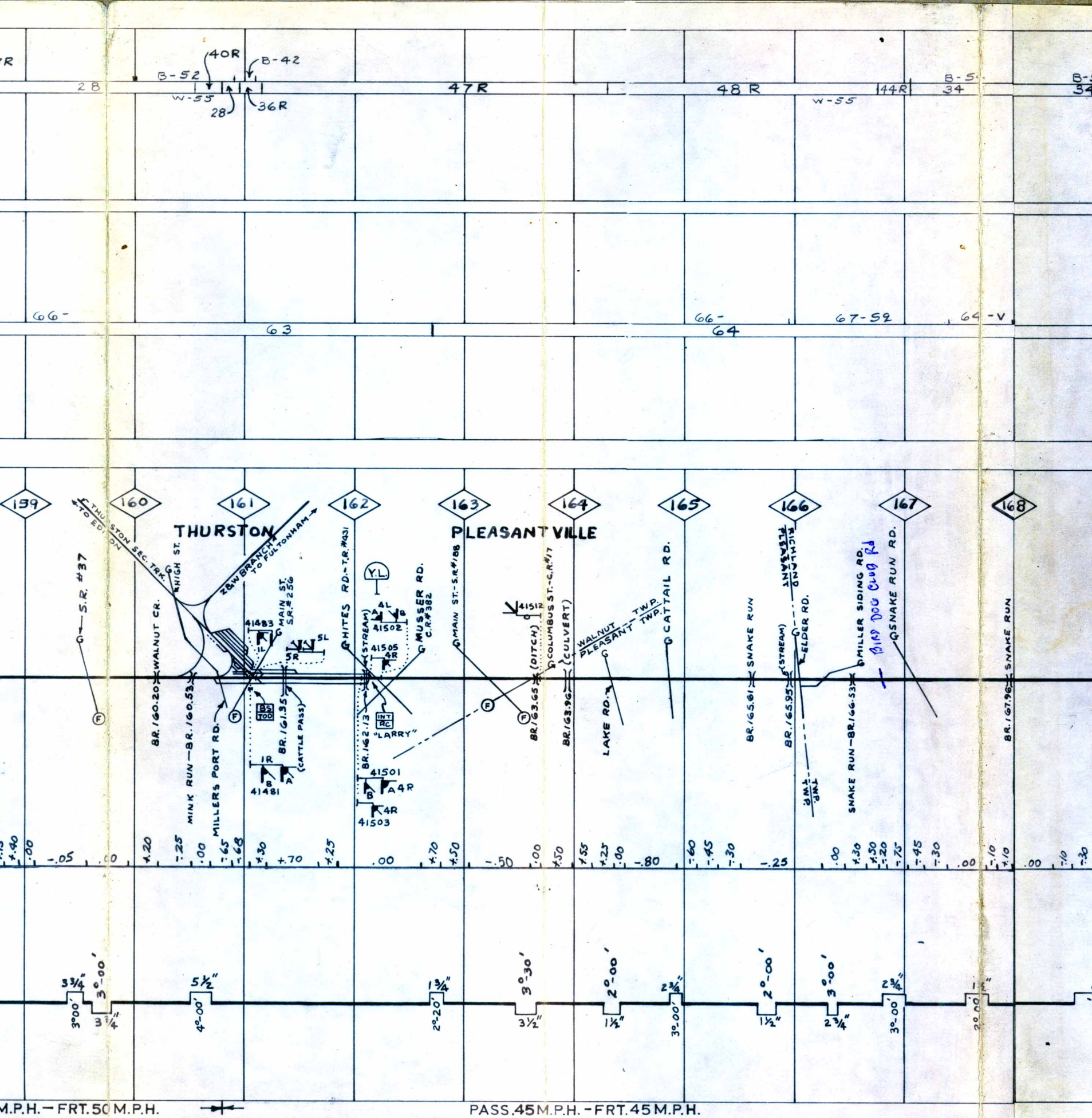

M.P.H. - FRT. 50 M.P.H.

PASS. 45 M.P.H. - FRT. 45 M.P.H.

