

Z & W
BRANCH.

RAIL PROGRAM

DRAINAGE

RECONDITIONING TRACK

Z&W SECONDARY TRACK

THURSTON
TO
ZANESVILLE

(The direction from Thurston
to Zanesville is southward)

37 R 35 R

29

30

31

32

33

THURSTON
TO TOLEDO
EASTERN BRANCH
STA. 15 + 94 = M.P. 29.82
BR. 28.82-SWOPE RUN

(PUBLIC ROAD)

(PUBLIC ROAD)

BR. 21.01-SWOPE RUN

NEW SALEM

(PUBLIC RD.)

TO COLUMBUS
WESTERN
TOWER
BRANCH
TO CORNING

83
100

FAIRFIELD CO.
PERRY CO.

+30
+70
+50
+55
+90
+40
+10
+30
+110
+70
+110
+1.00
+1.10
+60
+30
+90
+50
+05
00
+40
+00
+30
+33
+40
+45

8'00'
0'30'
1'00'
2'00'
3'01'

10 M.P.H.

SUBDIVISION No.6 — SUPERVISOR

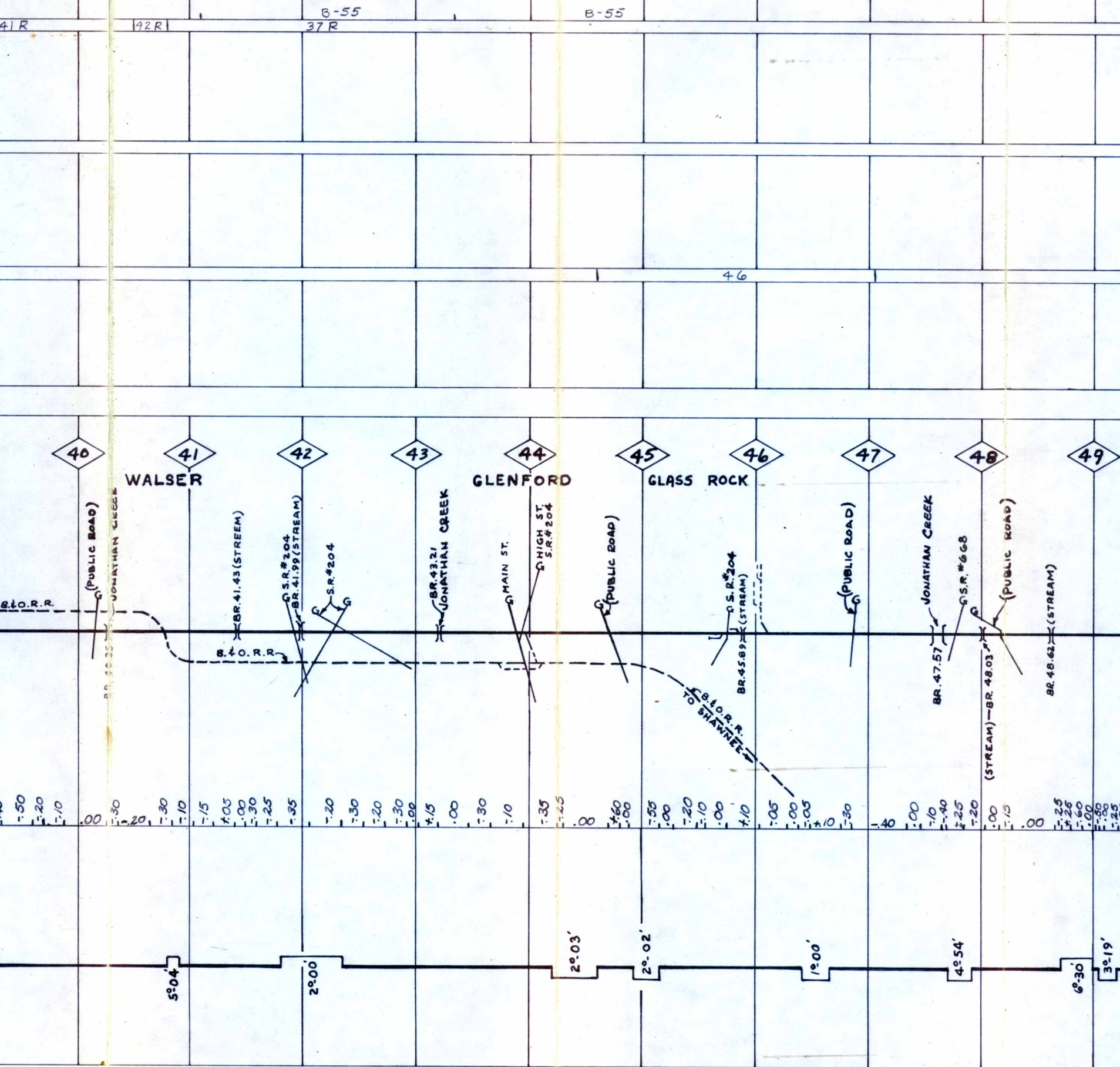

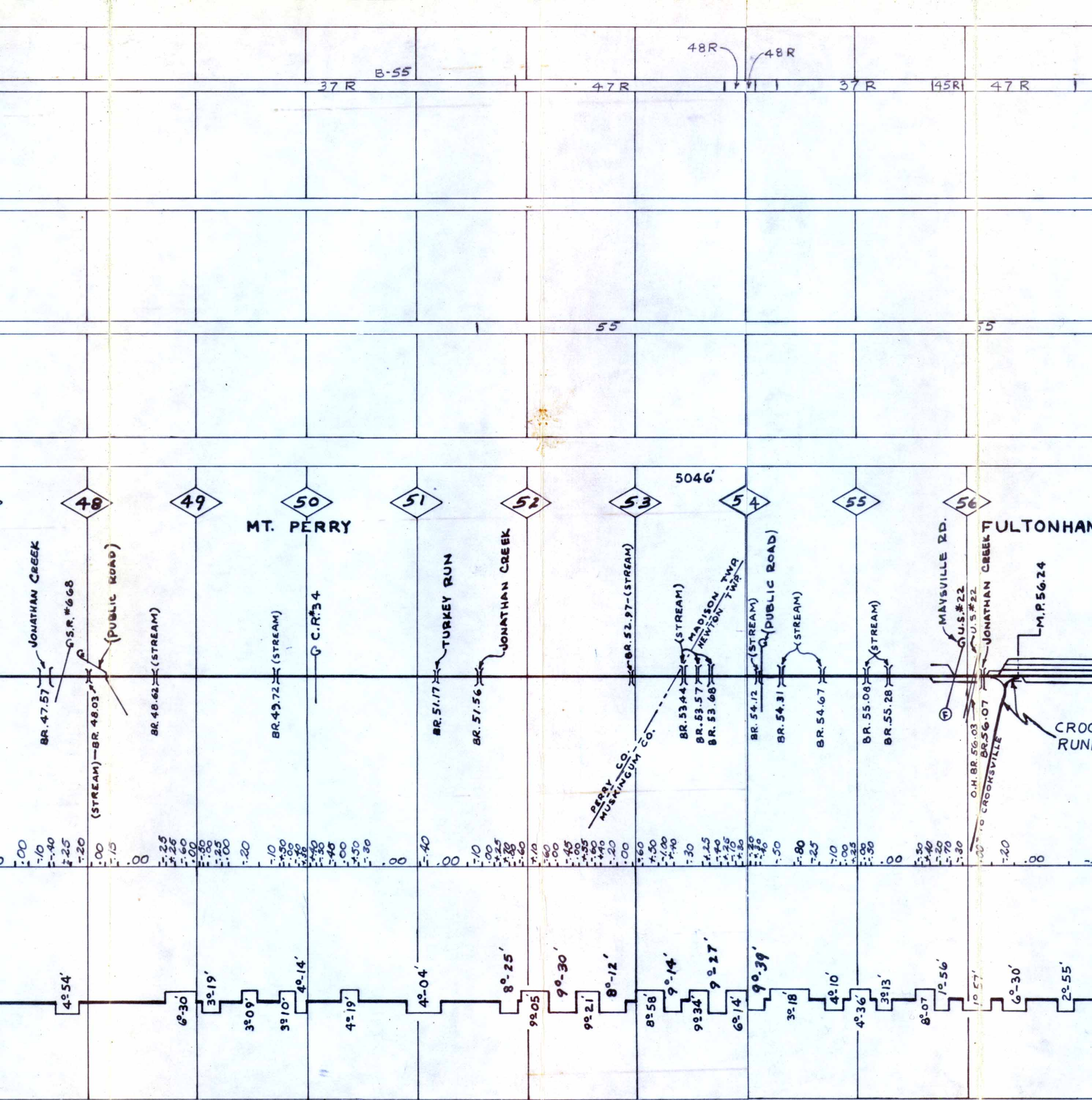

10 M.P.H. → 10 M.P.H.
7:30 A.M. to 8:30 A.M.—5 M.P.H.—3:15 P.M. to 4:15 P.M.

45R | 47R | 37R | 48R | 37R

Se 68

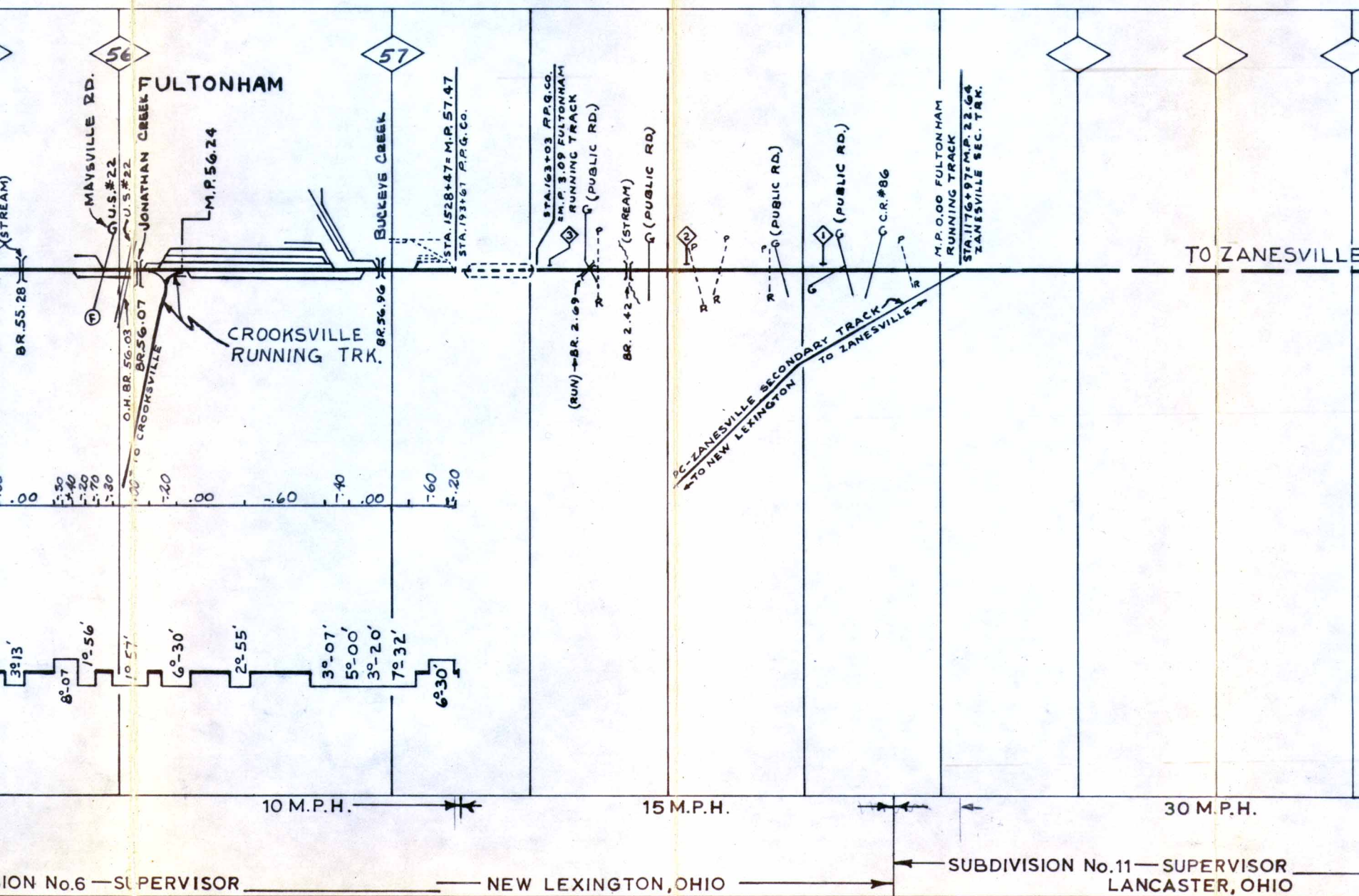

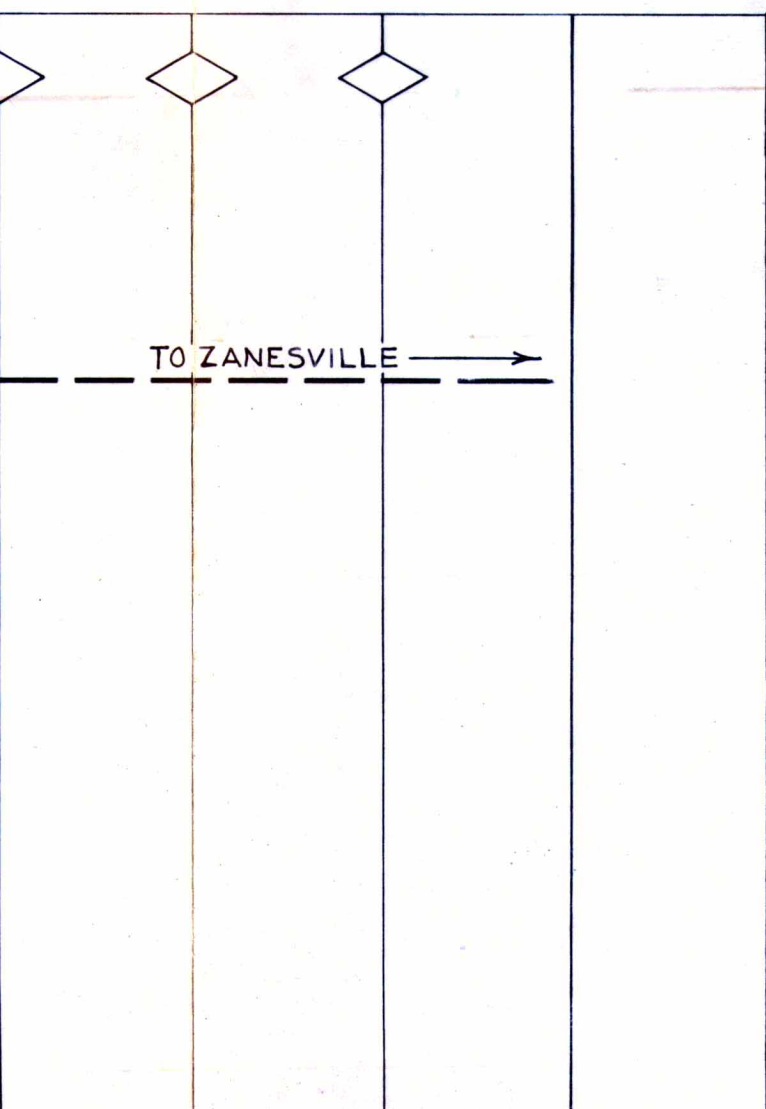
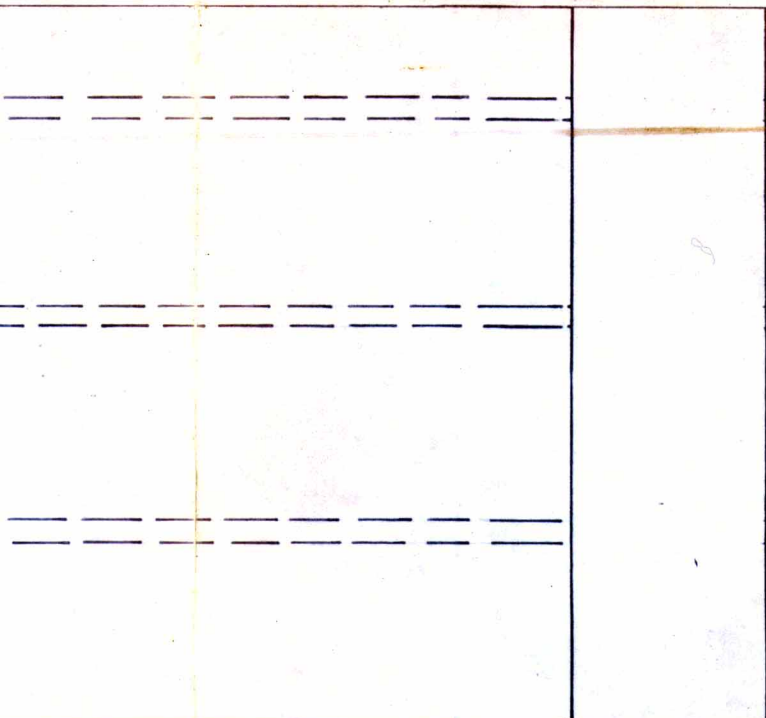

30 M. P. H.

No. 11 — SUPERVISOR
LANCASTER, OHIO

