

SANDUSKY BRANCH

COLUMBUS (Jct. with Akron Branch)

TO

Hudson Street

(Including Grogan & Pennor Yards)

(N. & W. Main Tracks)

5353'

1 BLUE CRY
2

BLISSFIELD

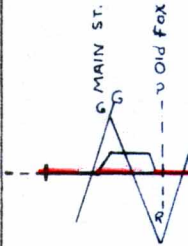

VS30
CO

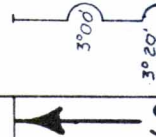

TOTAL COMPANY TRACK__

SWITCHES__

5353'	9	5557'	8	5185'	7	5371'	6	5415'	5	5286'	4	5485'	3	5311'	2	5489'
-------	---	-------	---	-------	---	-------	---	-------	---	-------	---	-------	---	-------	---	-------

1 BLUE CRYSTAL COAL

2

3

4

5 RICE-CHADWICK RUN

6 KILLBUCK ELEVATOR

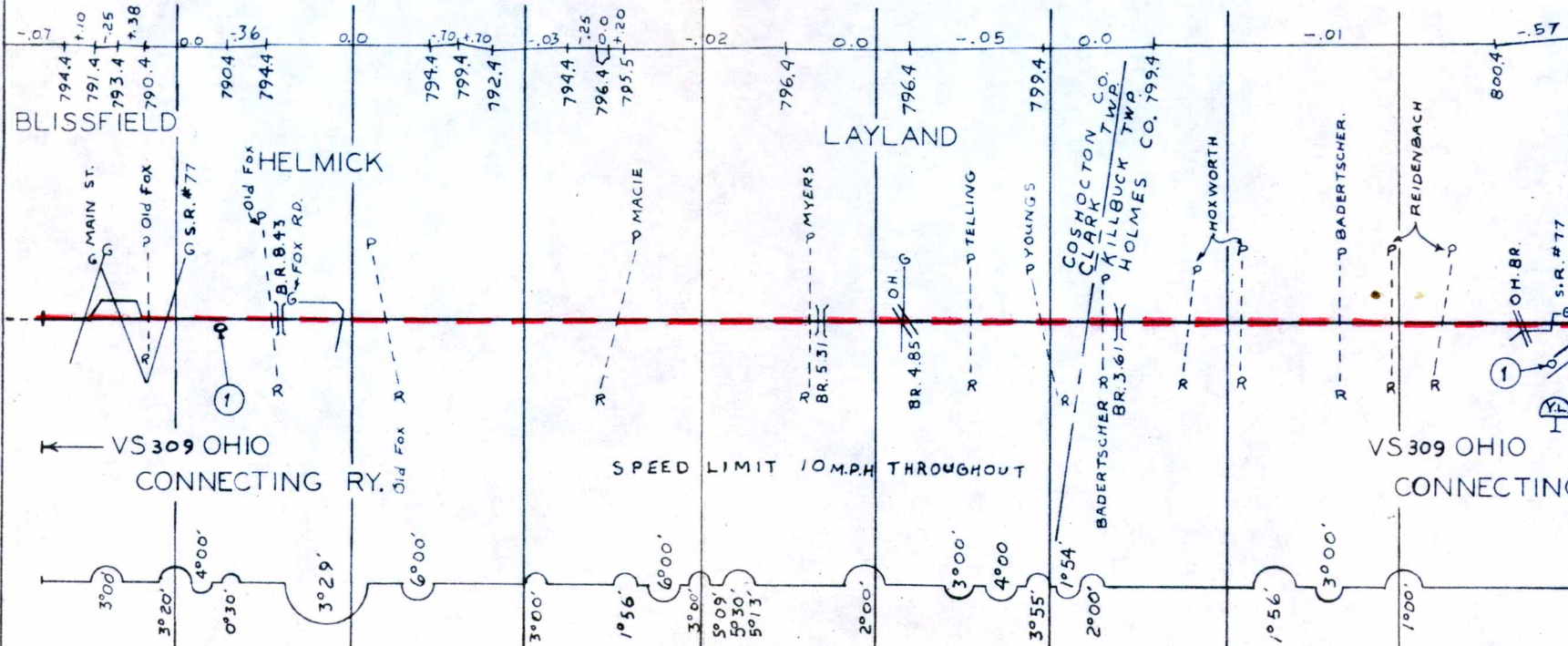

3 5311' 2 5489' 1 5488' 0

5 RICE-CHADWICK RUBBER CO.
6 KILLBUCK ELEVATOR

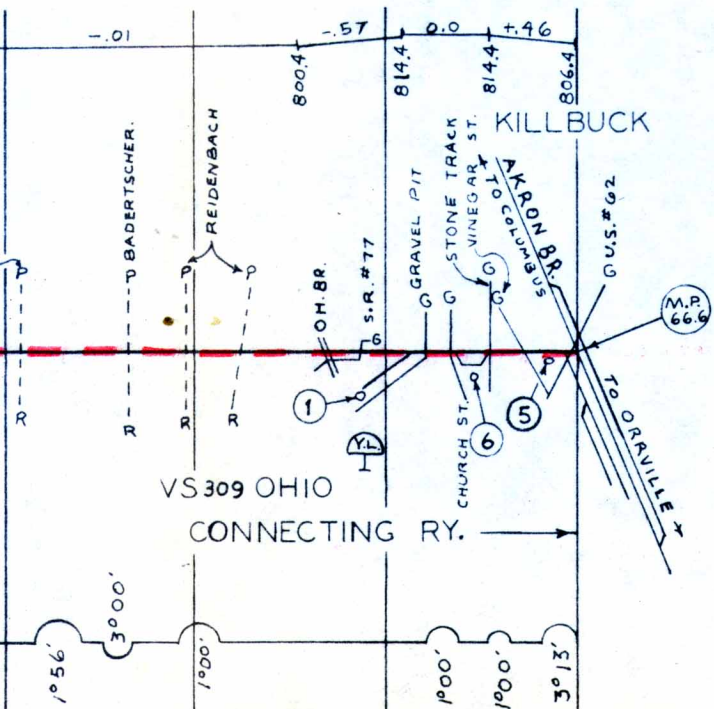

SUBDIVISION No. 7

DRESDEN BRANCH

KILLBUCK
TO
BLISSFIELD

0
144

5143'

1
143

5047'

- 1 RESTAURANT FOOD SUPPLY
- 2 COLUMBUS STEEL SUPPLY
- 3 FEDERAL CHEMICAL CO.
- 4 THE HANNA PAINT MFG. CO.
- 5 OHIO WAREHOUSES INC.
- 6 JOYCE IRON & METAL CO.
- 7 AMERICAN ZINK OXIDE CO.
- 8 MERCHANDISE WAREHOUSE
- 9 DAVISON CHEM. DIV. (W.R.C)

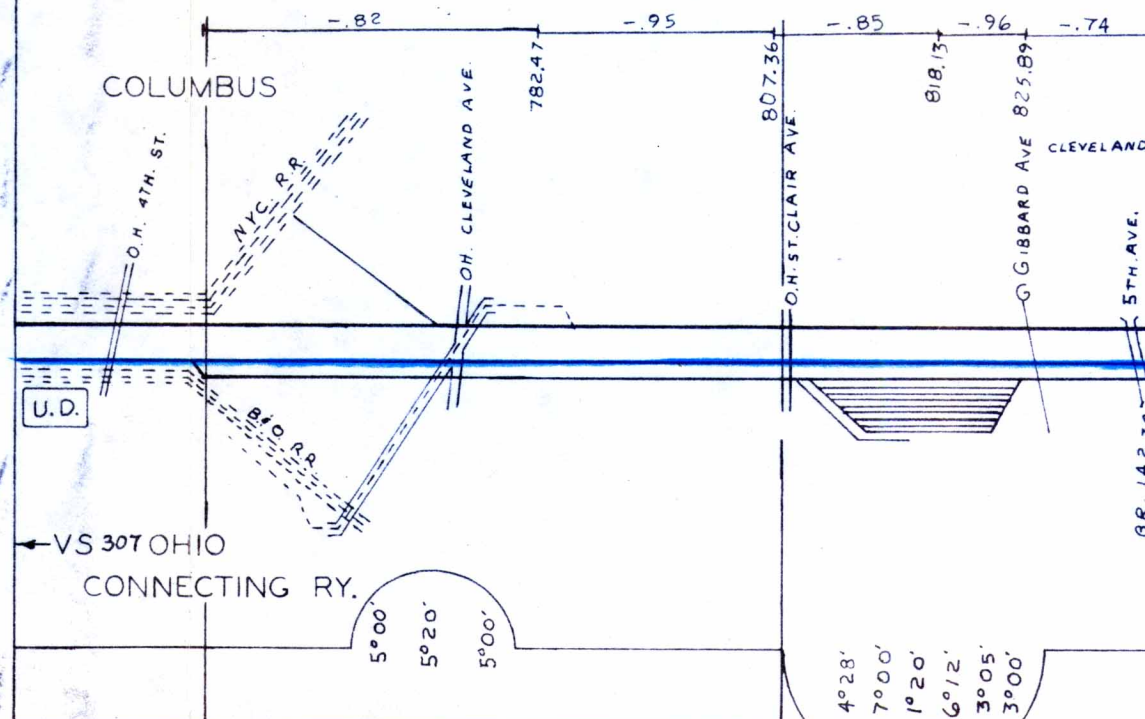

SUPERVISOR J. S. FERRANTE

Total Company Track _____ Switches _____

Total Company Track _____ Switches _____

1
143

5047'

142

5279'

141

5278'

140

5276'

RESTAURANT FOOD SUPPLY CO.
COLUMBUS STEEL SUPPLY CO.
FEDERAL CHEMICAL CO.
THE HANNA PAINT MFG. CO.
HIO WAREHOUSES INC.
JOYCE IRON & METAL CO.
AMERICAN ZINK OXIDE CO.
MERCHANDISE WAREHOUSE CO.
AVISON CHEM. DIV. (W.R. GRACE CO.)

10
10-A- 3C's LUMBER CO.
10-B- SHOE CORP. OF AMERICA
10C. FERREL FUEL

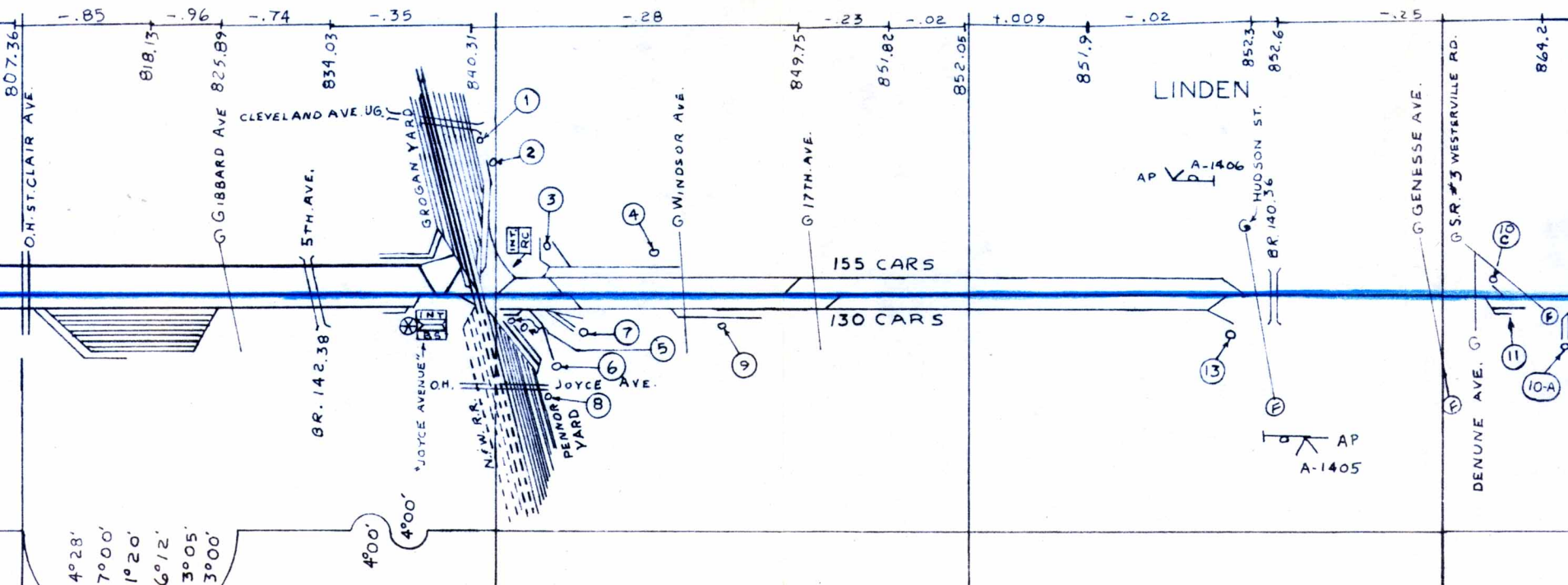

SUBDIVISION No. 3

SUBDIVISION No. 3

BER Co.
RP. OF AMERICA
CL

11. LINDEN TEAM TRACK

a. LINDEN LUMBER Co.
b. COLUMBUS SOLVENT Co.

11 McVAY FURNITURE

12 BENNET MFG Co.

13 CHECKER OIL Co.

14 CELLAR LUMBER Co.

15 WESTERVILLE FARMERS EXCHANGE

16 UNITED SHEET METAL Co.

16A. COLUMBUS & SOUTHERN OHIO ELECTRIC Co.

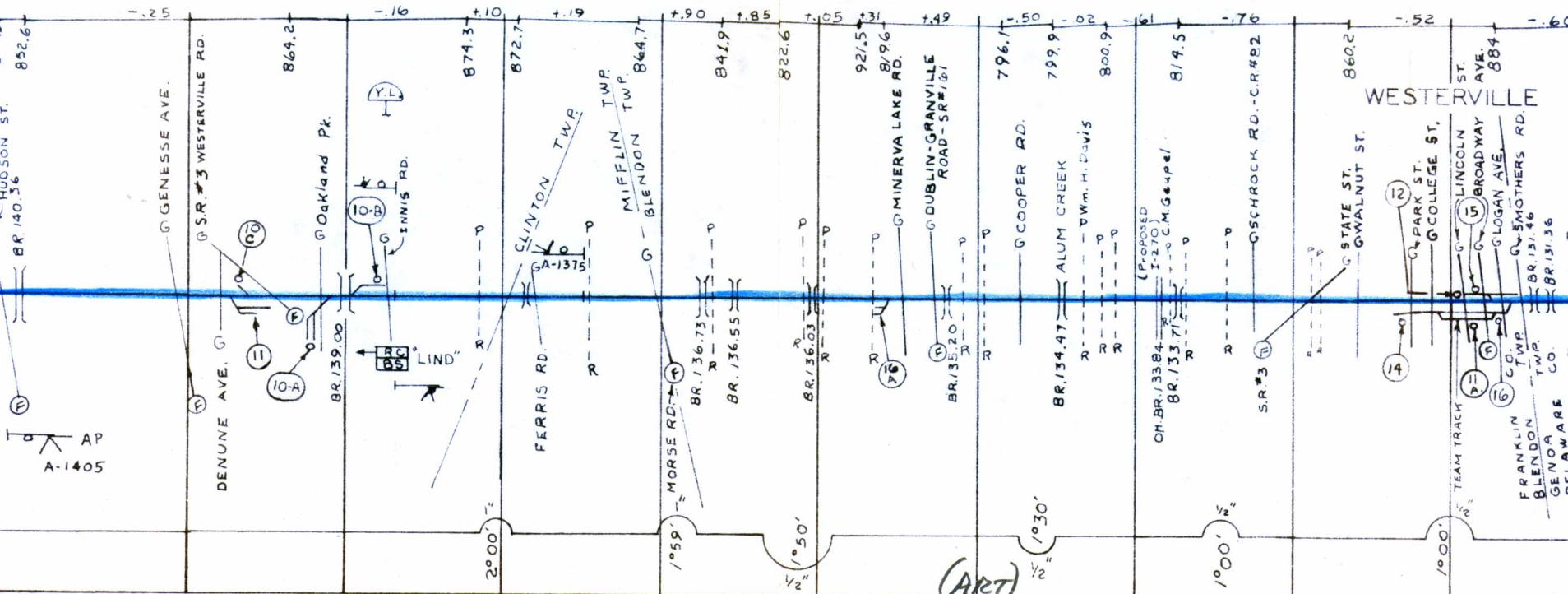

133	5281'	132	5279'	131	5295'	130	5265'	129	5278'	128	5280'	127	5280'	126	5281'	125	5281'	124	5277'
-----	-------	-----	-------	-----	-------	-----	-------	-----	-------	-----	-------	-----	-------	-----	-------	-----	-------	-----	-------

- 17 PUBLIC DELIVER
- 18 GALENA SHALE, TH
- 19 THE NESTLE CO.
- 20 DELAWARE CO. FAR
- 21 SUNBURY LUMBER

CHANGE
O.
HIO ELECTRIC CO.

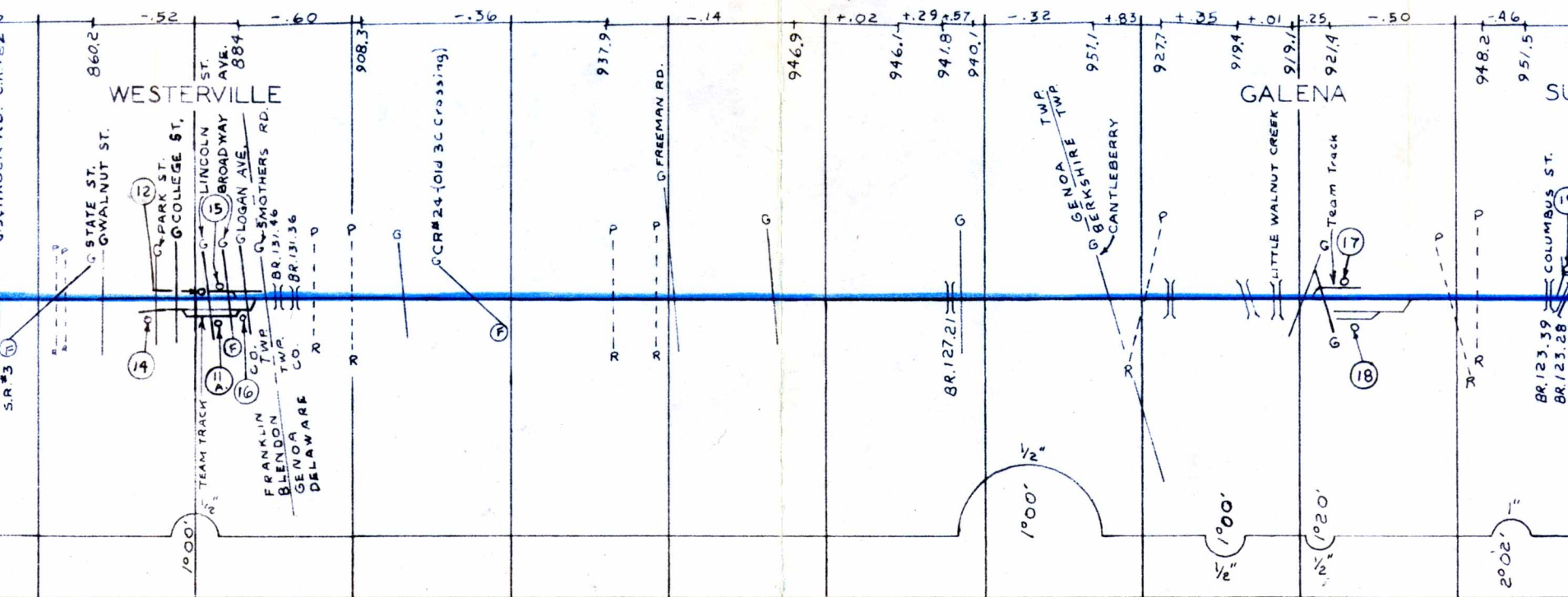

MT. VERNON, OHIO

125	5281'	124	5277'	123	5281'	122	5281'	121	5280'	120	5280'	119	5284'	118	5276'	117	5281'	116	527
-----	-------	-----	-------	-----	-------	-----	-------	-----	-------	-----	-------	-----	-------	-----	-------	-----	-------	-----	-----

- 17 PUBLIC DELIVERY
- 18 GALENA SHALE, TILE, & BRICK
- 19 THE NESTLE CO. INC.
- 20 DELAWARE CO. FARM BUREAU
- 21 SUNBURY LUMBER CO.

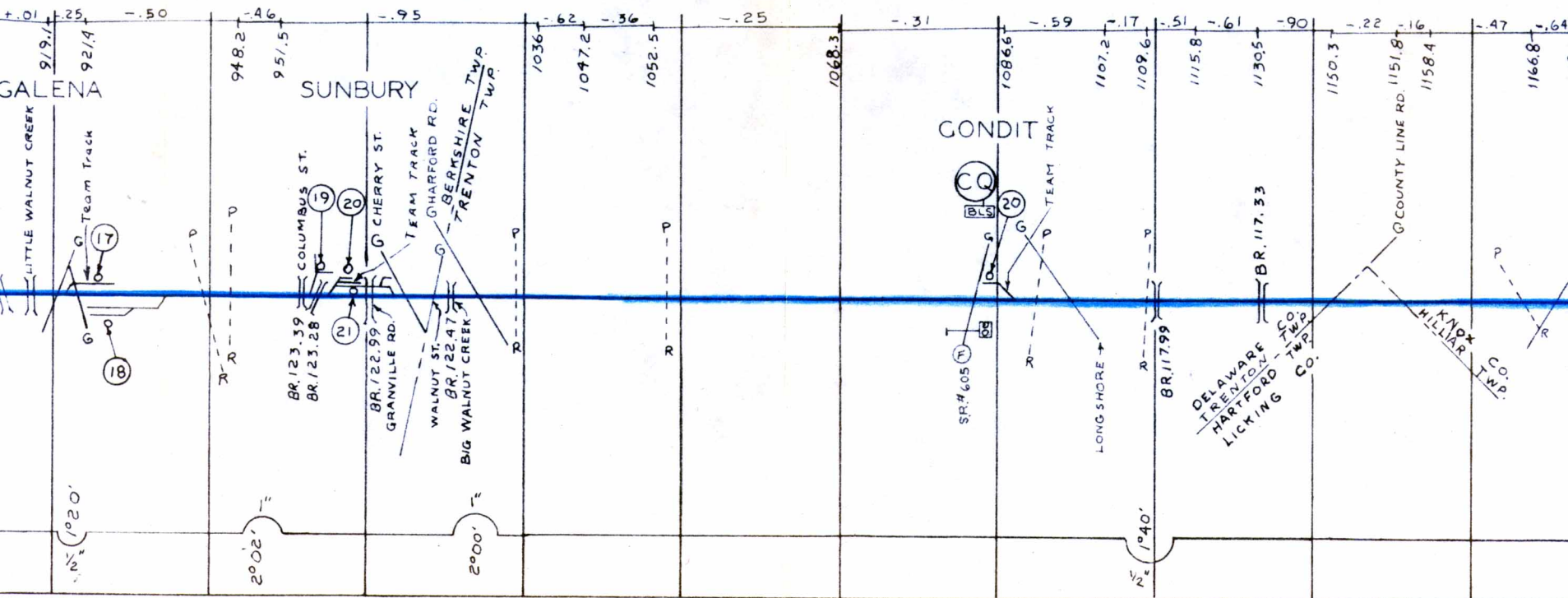

117 5281' 116 5279' 115 5271' 114 5290' 113 5278' 112 5280' 111 5279' 110 5281' 109 5280' 108 5290'

22 CENTERBURG FEED & GRAIN CO.

23

24 GRIFFITH FARM SERVICE

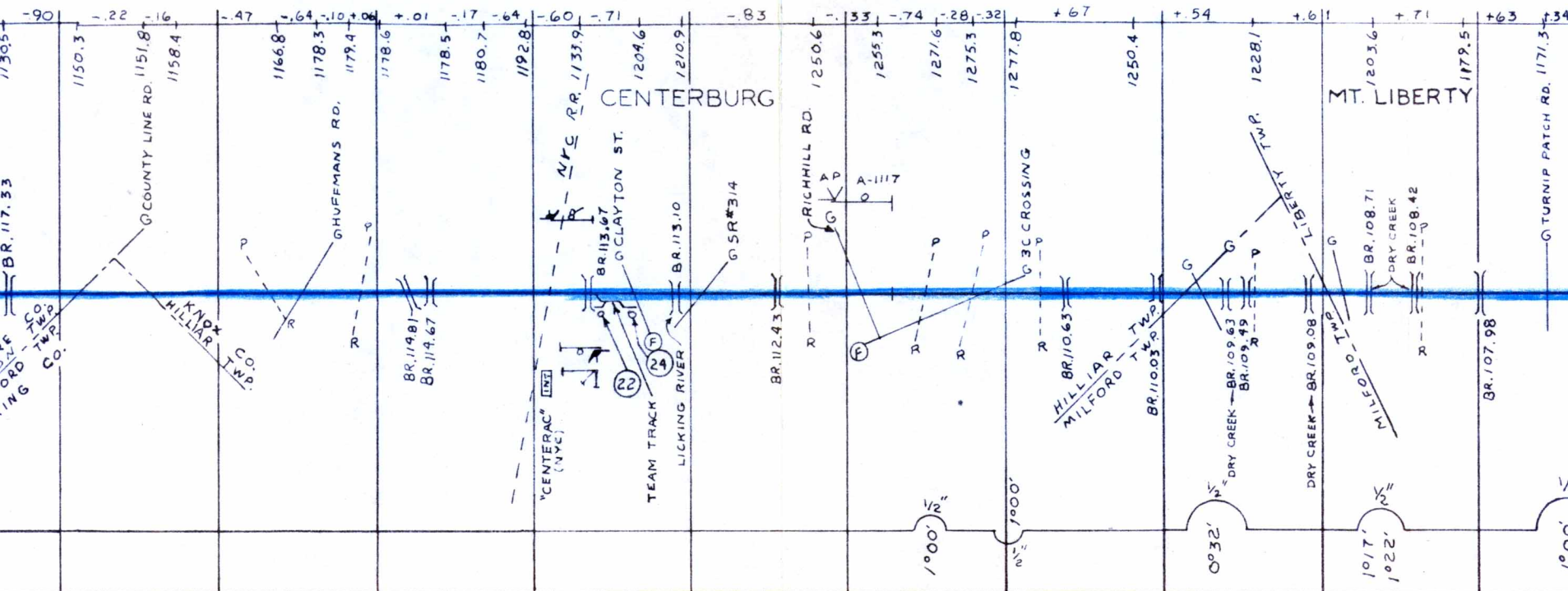

280'	101	5289'	100	5282'	99	5278'	98	5
------	-----	-------	-----	-------	----	-------	----	---

- | | |
|--------------------------------|----|
| 28 WAYNE FEED COAL YARD. | 33 |
| 29 WAYNE CASH FEED CO. | 34 |
| 30 MT. VERNON FARMERS EXCHANGE | |
| 31 WALKER LUMBER CO. | |
| 32 METALSMITHS CORPORATION | |

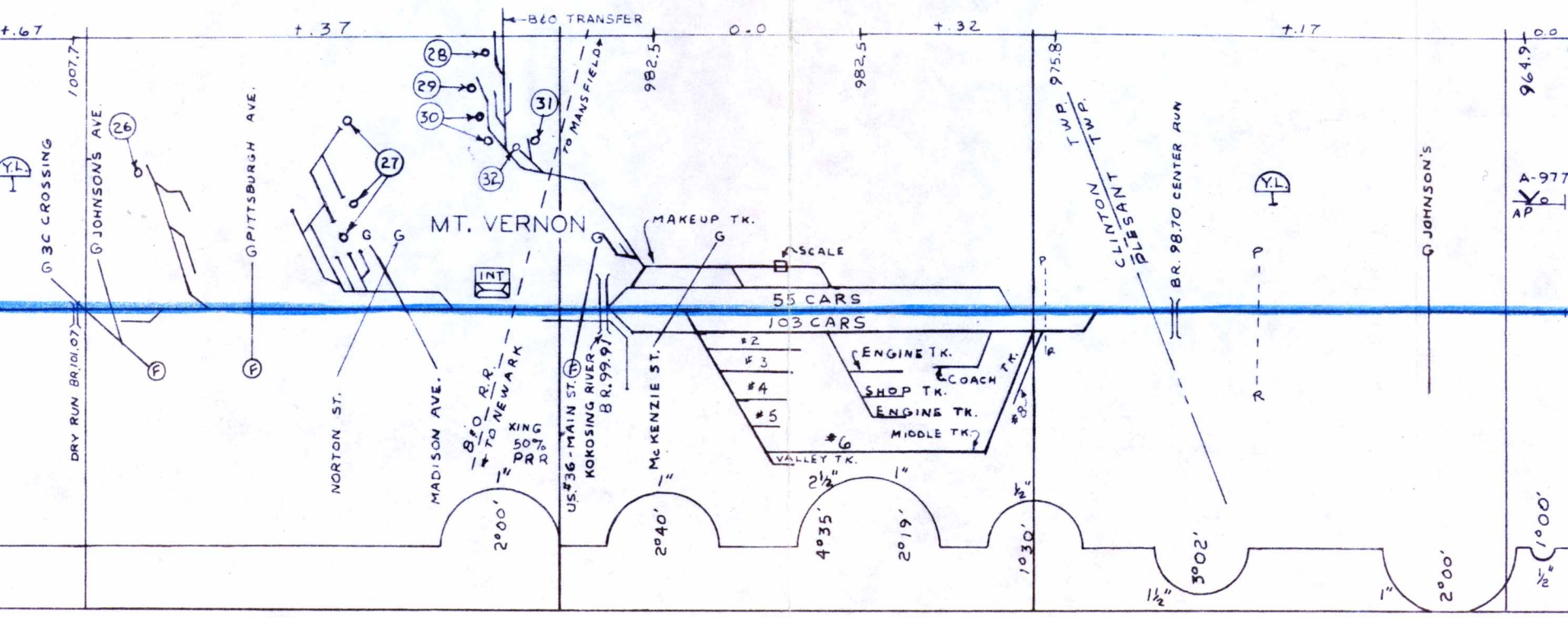

278' 98 5292' 97 5269' 96 5281' 95 5280' 94 5280' 93 5280' 92 5286' 91 5274' 90 5

35 GAMBIER FARMERS COOPERATIVE
35-A JOSLYN MFG. & SUPPLY CO.

36 D.A. KIRK ELEVATOR
37 MILWOOD SAND CO.
38

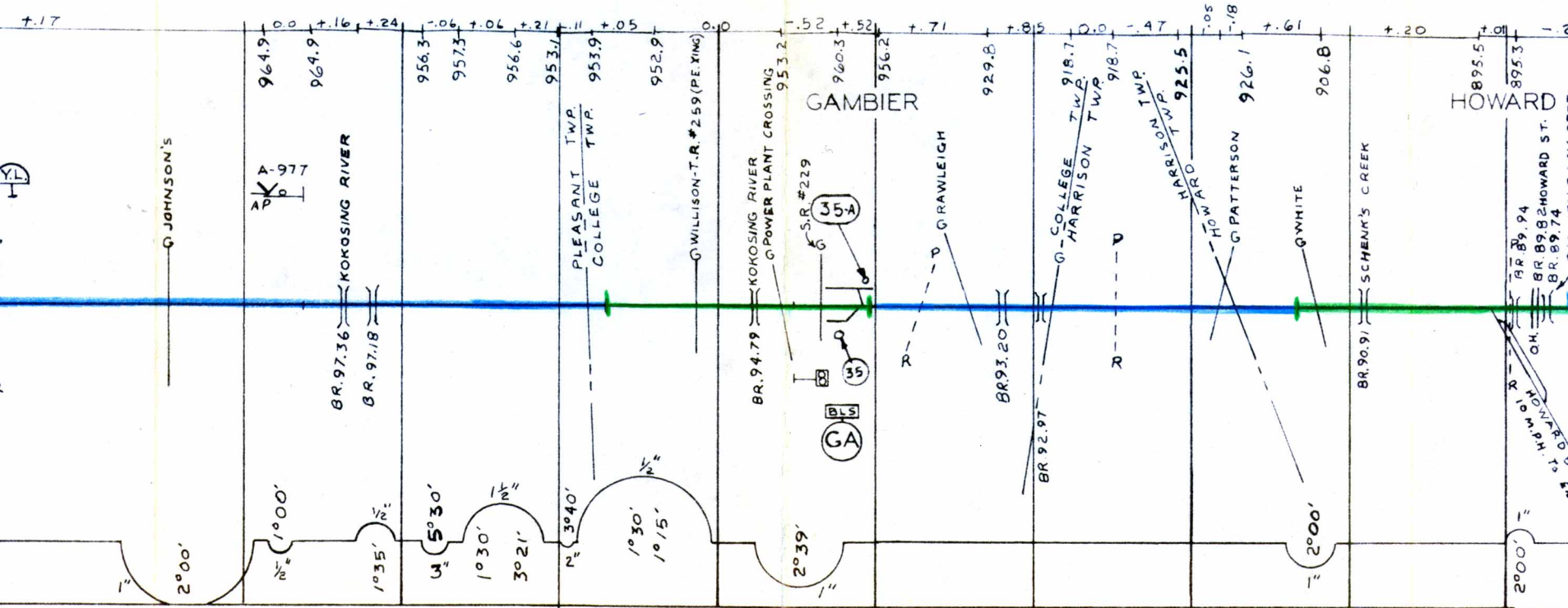

286' 91 5274' 90 5280' 89 5280' 88 5279' 87 5280' 86 5286' 85 5273' 84 5281' 83 5272' 82 5

K ELEVATOR
D SAND Co. 39 BANBURY WOOL Co.
40 DANVILLE COAL Co.
41 KAYLOR ELEVATOR Co.
42 BANBURY LUMBER
43 STOVER FEED & GRAIN INC.
44 PAINT PRODUCTS INC.
44-A. AURORA HIGHLAND FERTILIZER Co.
44-B. WALTER H. DIDINGER 45 K

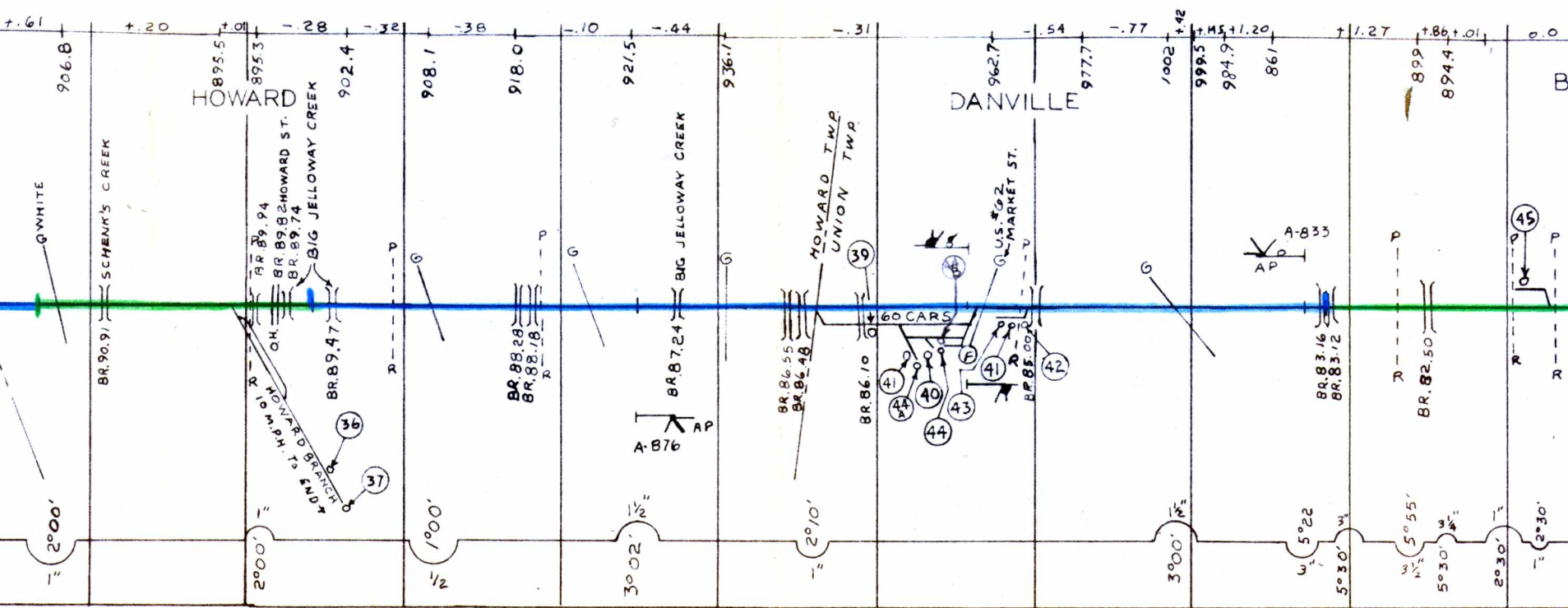

5281' 83 5272' 82 5280' 81 5289' 80 5279' 79 5073' 78 5013' 77 5032' 76 5404' 75 5282' 74

45 KILLBUCK SAND & GRAVEL CO.

46 DRIER HILL S

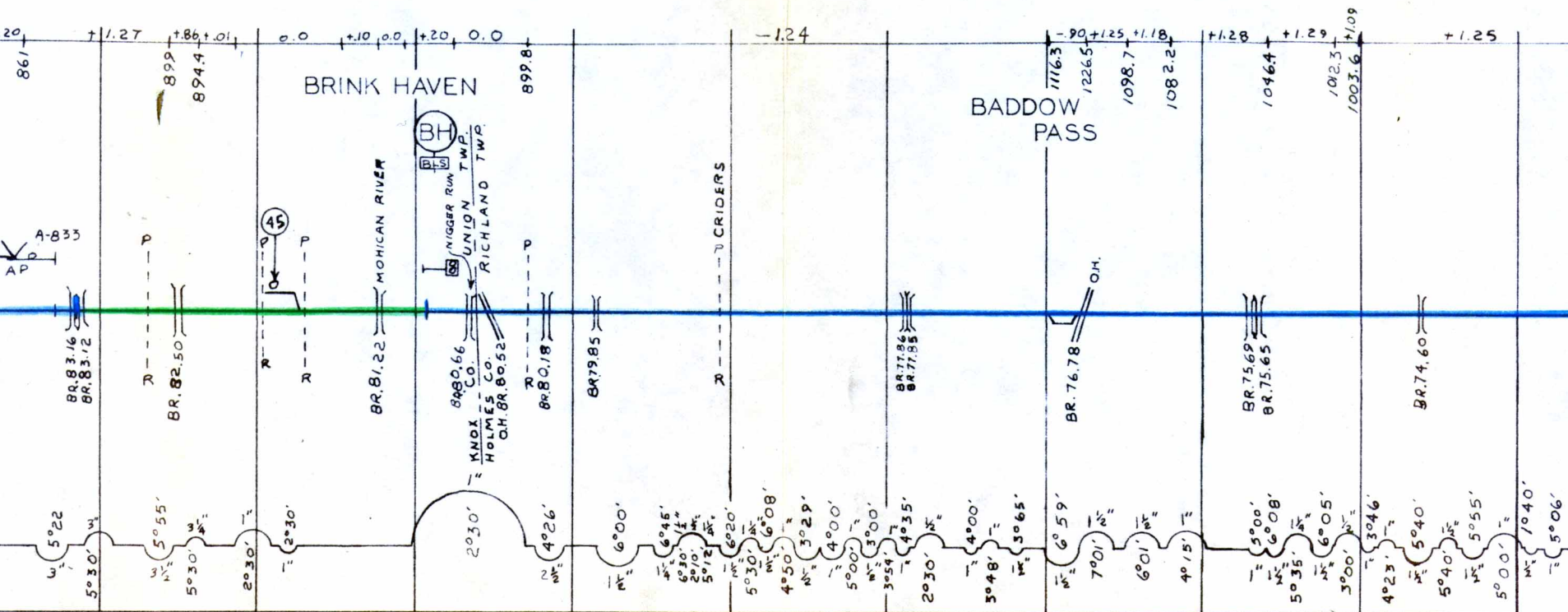

MAIN TRACK__

SWITCHES__

TOTAL COMPANY TRACK__

RICE-CHADWICK RUBBER CO.

48 HONEGGER'S & Co.

49 OHIO OIL Co.

50 SINCLAIR REFINING Co.

51 HIPP LUMBER Co.

52 HOLMES COUNTY FARM BUREAU

53

54 FLXIBLE Co.

54A. KERR-McGEE CHEMICAL CORP.

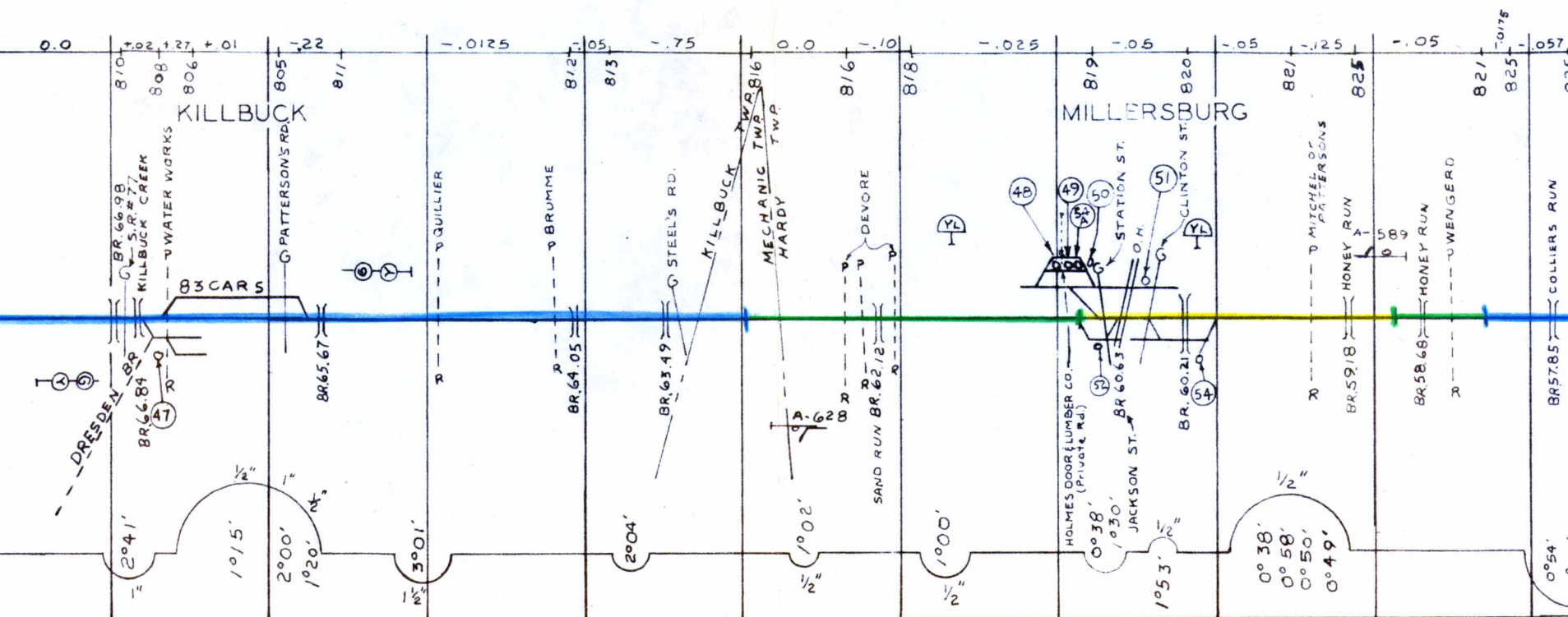

SUPERVISOR A.E. HIMLER

MT. VERNON, OHIO

5281' 59 5379' 58 5183' 57 5286' 56 5278' 55 5283' 54 5276' 53 5283' 52 5280' 51 5300' 50

S & Co.
Co.
REFINING Co.
ER Co.
COUNTY FARM BUREAU

55 BUCKEYE HOLMESVILLE MFG. Co.
56 HOLMESVILLE ELEVATOR
57 HOLMES CLAY DIVISION

58
59 SLUTZ & SON ELEVATOR

GEE CHEMICAL CORP.

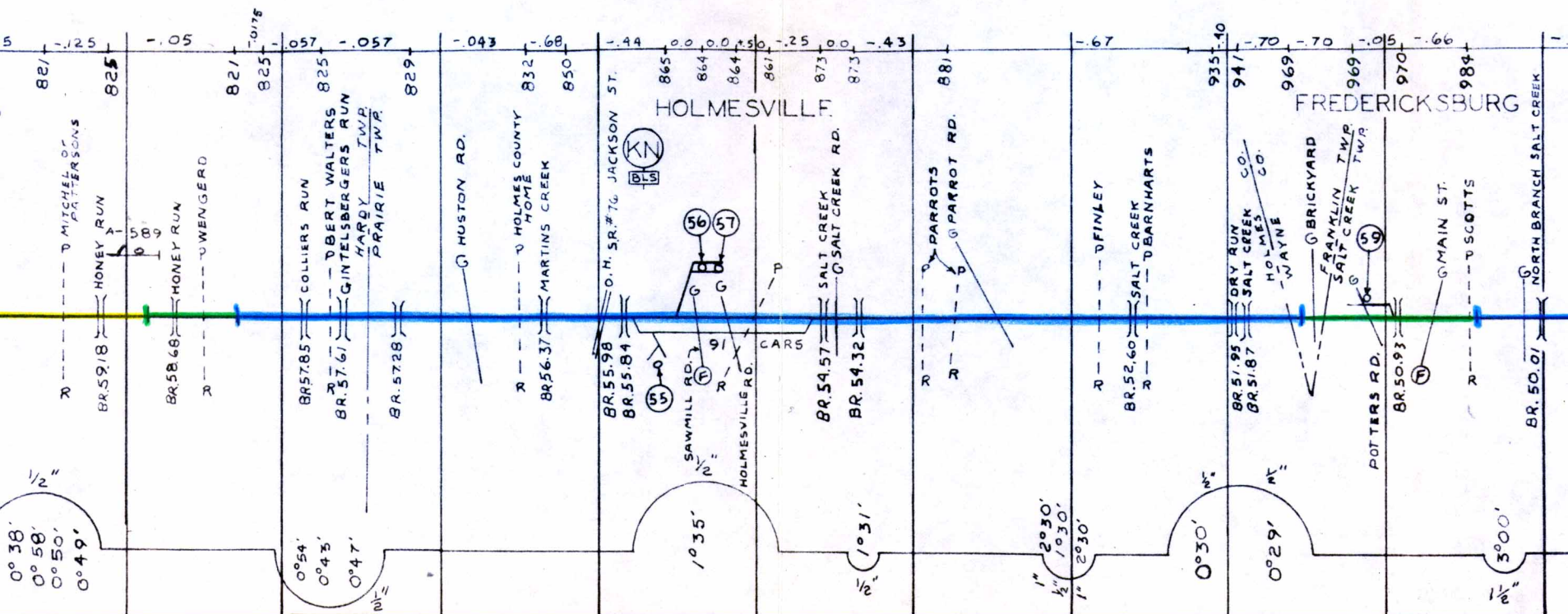

ARNON, OHIO

SUBDIVISION No. 7

5280' 51 5300' 50 5261' 49 5280' 48 5278' 47 5279' 46 5282' 45 5280' 44 5280' 43 5280' 42

60

61 STUDER BROTHERS ELEVATOR

62

63 GERBER FEED MILL

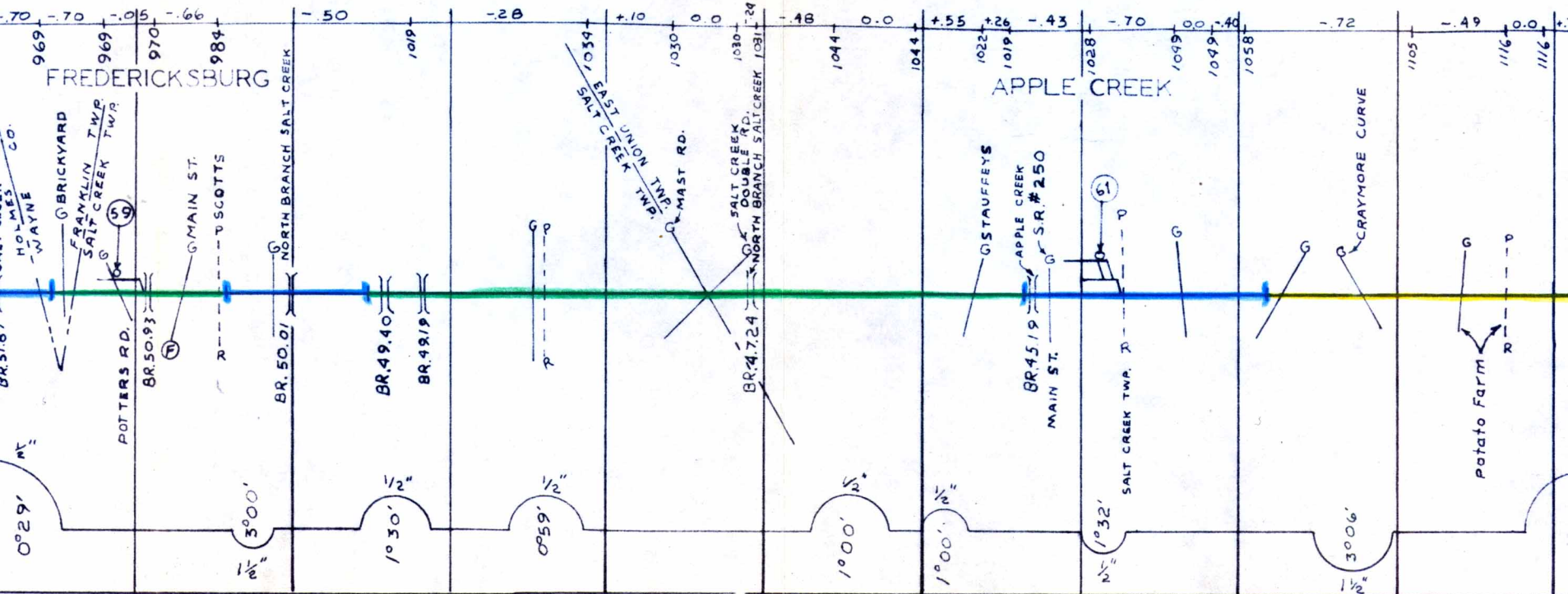

- BUCKEYE DIVISION

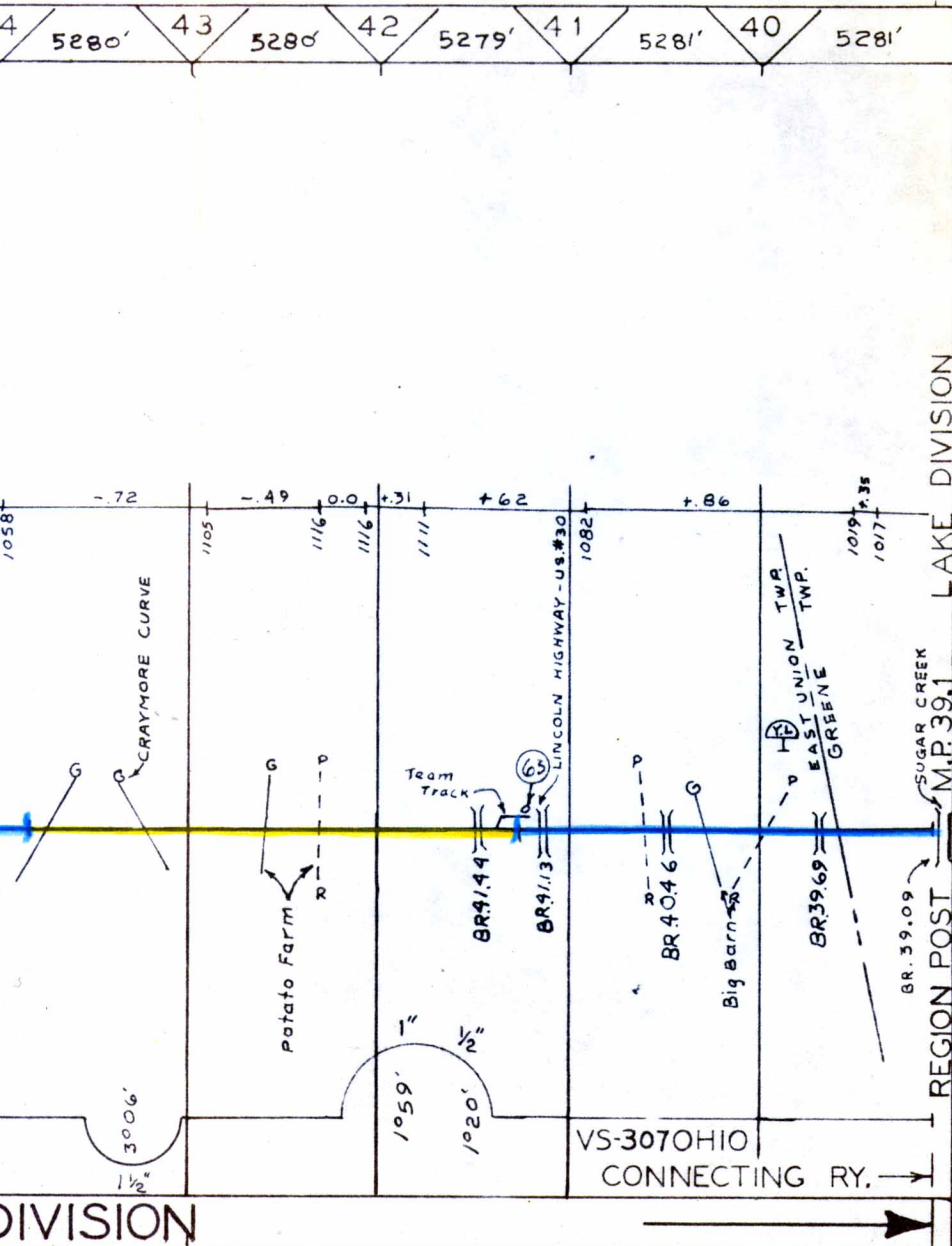

AKRON
BRANCH

AKRON BRANCH

ORRVILLE
TO
COLUMBUS