

# FT. WAYNE BRANCH

RICHMOND TO M.P. 69+2640

RICHMOND

WESTERN

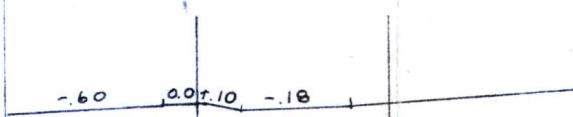
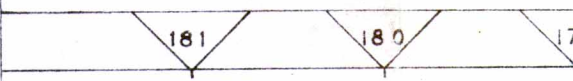

LOGANSPORT

← To Chicago

CHICAGO DIVISION

WESTERN REGION

180 179 178 177 5264' 176 5287' 175 5275' 174 5286' 173 5386' 172 5174' 171

1. J. R. LEFFERT  
 2. WALTON ELEVATOR CO.  
 3. DE HAVEN SOIL SERVICE  
 4.  
 5. KEITH ERNY FERTILIZER SERVICE  
 6. KOKOMO FEED & GRAIN CO.  
 7. LINCOLN ELEVATOR CO.  
 8.  
 9. GALVESTON LUMBER CO.  
 10. BAHLER GRAIN & FEED CO.

11 ORESTES CANNING CO.

ANOKA  
 VS 152 IND. P. B. & W. RR. CO.

WALTON

TIPTON  
 JACKSON  
 TOWNSHIP RD.

CHICAGO DIVISION BUCKEYE DIVISION

11 ORESTES CANNING CO.

### 3. DE HAVEN SOIL SERVICE

4.

5. KEITH ERNY FERTILIZER SERVICE

6. KOKOMO FEED & GRAIN CO.

7. LINCOLN ELEVATOR CO.

8.

9. GALVESTON LUMBER CO.

10. BAHLER GRAIN & FEED CO.

RT

ANOKA

VS 152-IND. P.B. & W. RR. CO.

ANOKA RD.

BR. 176.47  
(PUBLIC RD.)

DYKEMAN RD.

BUCKWHEAT RD.  
(STREAM)

PETERMAN RD.

GRAHER RD.

BR. 173.11  
BIG ROCK CREEK

WALTON

BUNKER HILL RD.

GRACE ST.

BISHOP ST.

MAY ST.

BROADWAY ST.

SOUTH ST.

TOWNSHIP RD.

JACKSON

TIPTON

CHICAGO DIVISION

BUCKEYE DIVISION

ICAGO DIVISION

BUCKEYE DIVISION



73 5386' 172 5174' 171 5259' 170 5308' 169 5254' 168 5292' 167 5268' 166 5266' 165 5289' 164 5273' 1

ES CANNING Co.

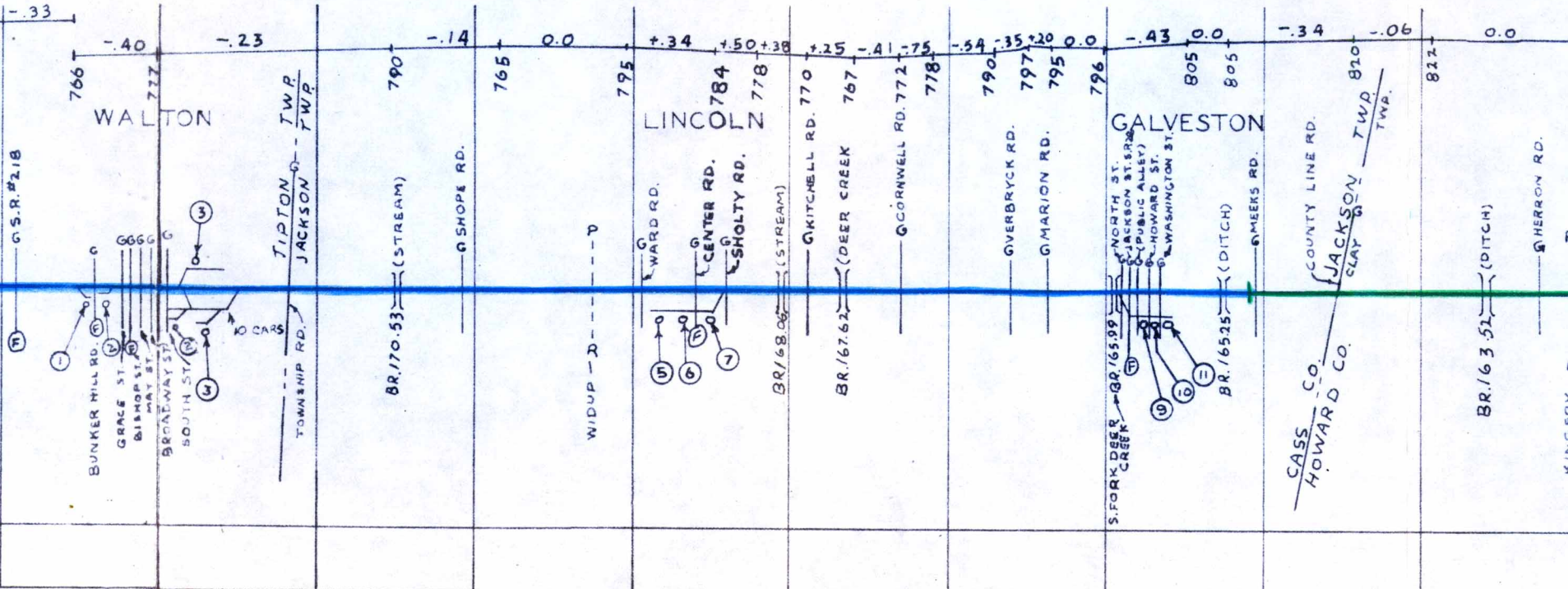

SUBDIVISION No. 11

50 M.P.H. PASS.

40 M.P.H. FRT.

65 5289' 164 5273' 163 5273' 162 5244' 161 5314' 160 5273'

- 12
- 13 MOON WELDING Co.
- 14 AMERICAN STANDARD SANITARY Co.
- 15 DELCO RADIO DIV'N. of GMC
- 16 CONTINENTAL BROADWAY
- 17 SWARTWOOT
- 18
- 19 J.H GARRITSON Co.
- 20 KOKOMO LUMBER Co.
- 21 LIBBY, McNEIL & LIBBY

22. SWARTWOOT FABRICATORS INC.
23. WM. MERVIS & SONS Co.
- 24.
25. CONTINENTAL STEEL
- 26.
27. PUBLIC SERVICE Co. of INDIANA
28. HAYNES STELLITE Co.
29. SERVICE CARTAGE Co.
30. READY MIXED CONCRETE Co.
31. COOK BLOCK Co.

- 32 PITTSBUR
- 33 CUMEO P.
- 34 MOHR CON
- 35 VANLUE LU
- 36 WM COAD
- 37 LUNTZ E
- 38 LUNTZ I
- 39
- 40 HEMLOCK
- 41 NEVADA F

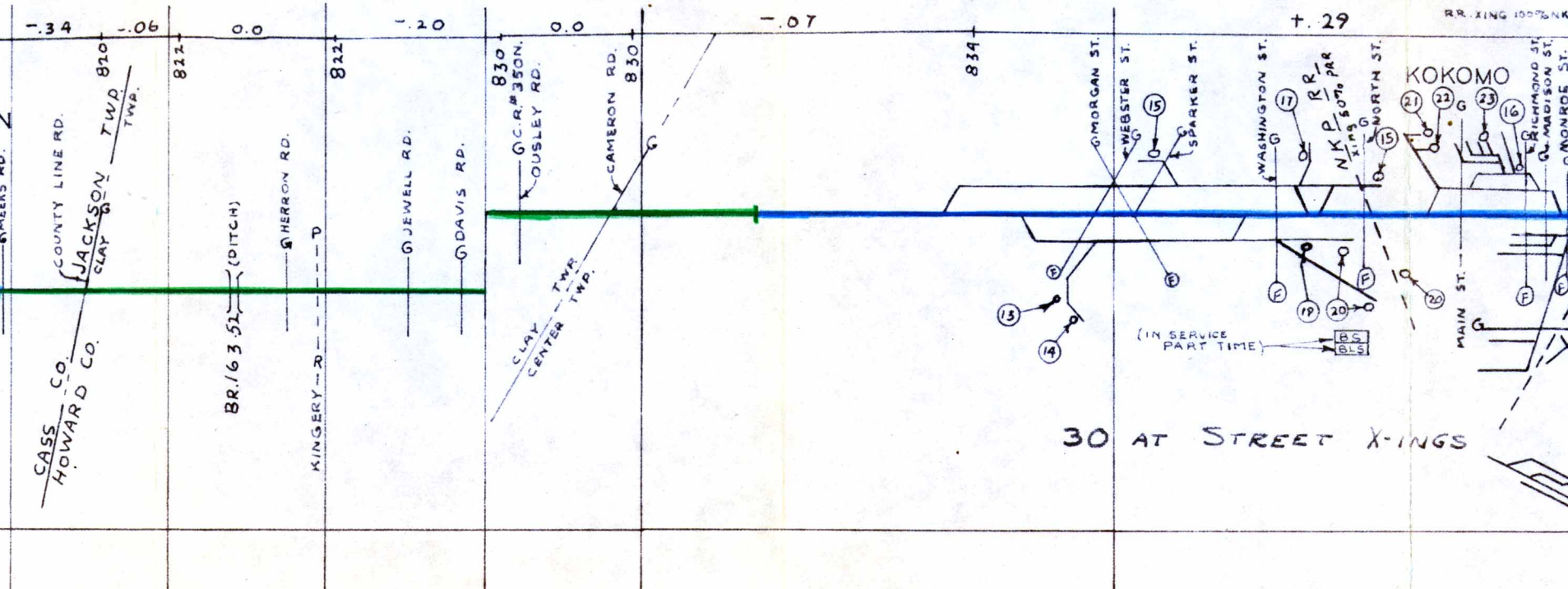

40 M.P.H. F.R.T.

SUPERVISOR D.J. KREISS



5273' 159 5299' 158 5263' 157 5287' 156 5270'

41-A

- 32 PITTSBURGH PLATE GLASS CO.
- 33 CUMEO PRESS INC. OF INDIANA
- 34 MOHR CONSTRUCTION CO.
- 35 VANLUE LUMBER CO.
- 36 WM COADY COAL CO.
- 37 LUNTZ BAILING CO.
- 38 LUNTZ IRON & STEEL CO.
- 39
- 40 HEMLOCK CROP SERVICE
- 41 NEVADA FEED & GRAIN

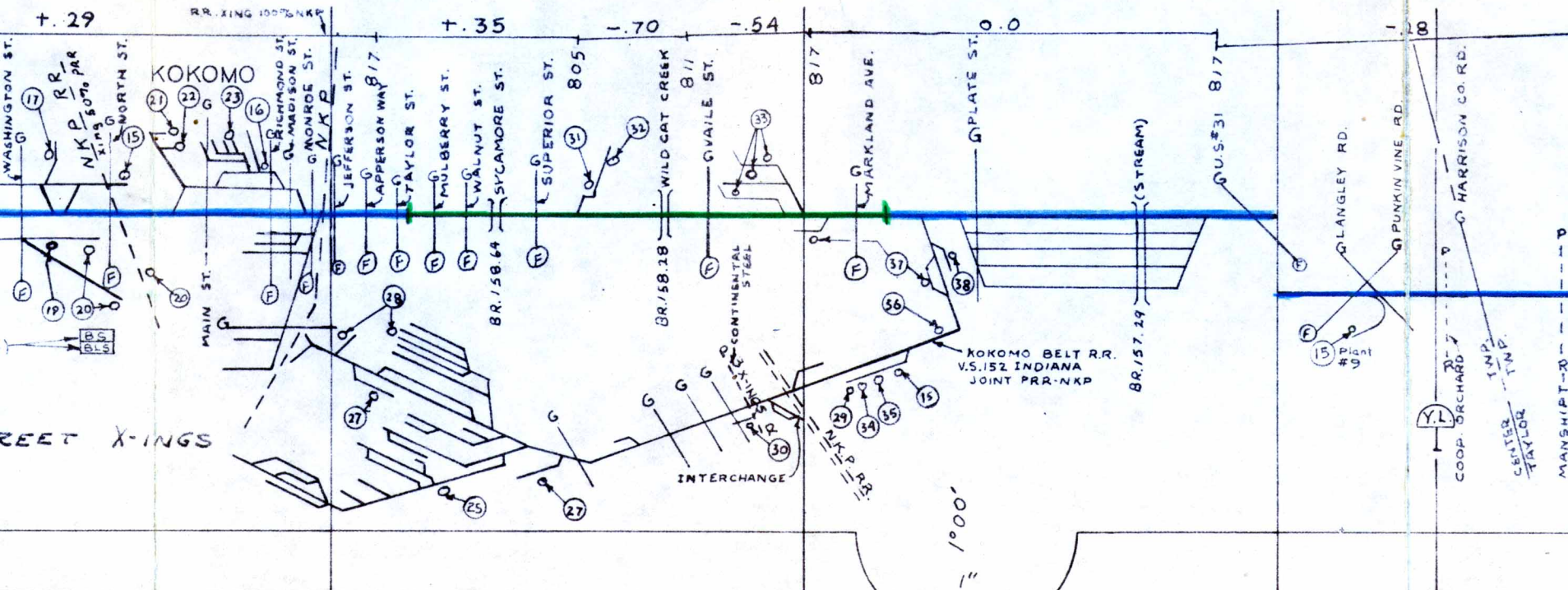

REVISOR D.J. KREISS

50 M.P.H. PASS. 40 M.P.H. FRT.

ANDER





149 5278' 148 5292' 147 5266' 146 5289' 145 5253' 144 5378' 143 5200' 142 5265' 141 5360' 140 5254'

42 UNION ELEVATORS INC.  
 43 WINDFALL LUMBER CO.  
 44 ARMETCO, INC.  
 45 HOOKER FARM CHEMICALS, INC.  
 46 SOLAR PETROLEUM CO.  
 47 SIMS COAL YARD  
 48 FINDLING FARM SERVICE  
 49 TICO GRITS, INC.  
 50 STANDARD ELEVATOR  
 51 PLATE GLASS #3

52 KONIGSLOW STAMPING & TOOL CO.  
 53 HEINZ MFG. CO.  
 54 CONTINENTAL CAN CO.  
 55 L.C. PRODUCTS CO.  
 56  
 57 ELWOOD COAL & FUEL CO.  
 58  
 59 INDIANA MICHIGAN ELECTRIC CO.  
 60 KOTA MIDWEST, INC.  
 61 HOME ICE & COAL CO.

62 F  
 63 V  
 64 H  
 65 W  
 65-A  
 65-B

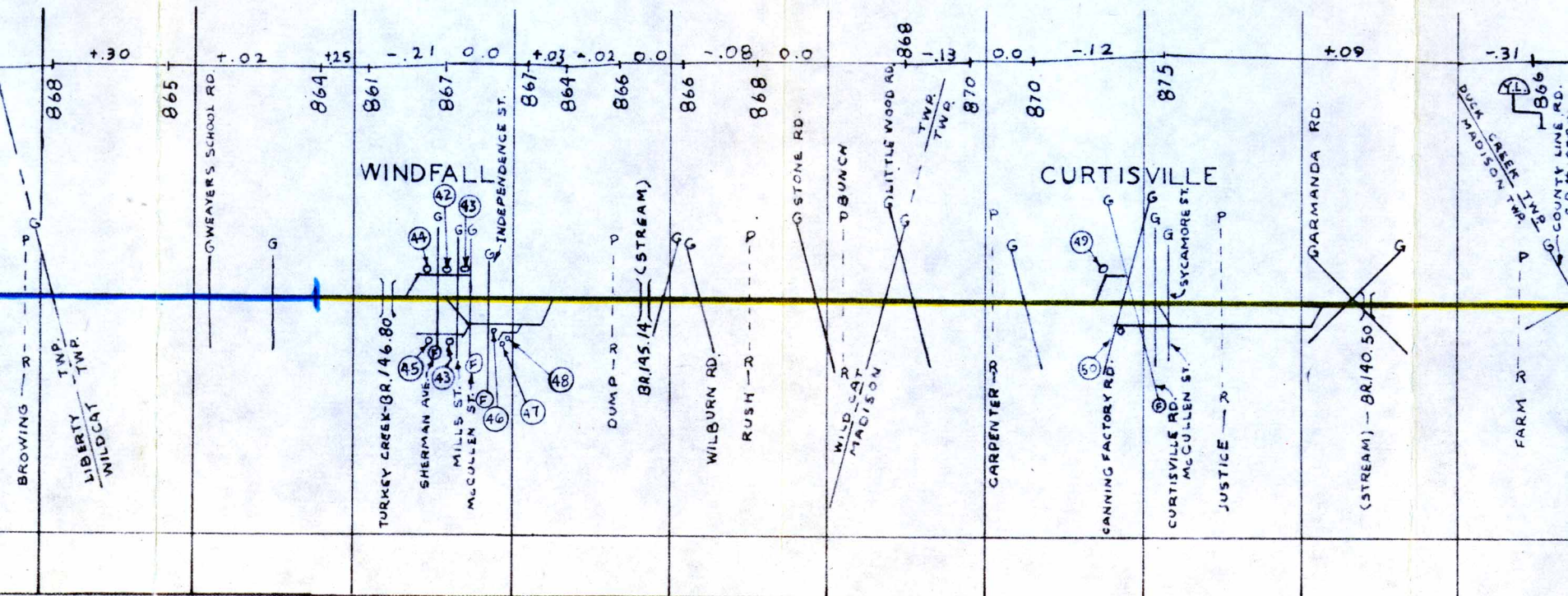

50 M.P.H. PASS.

40 M.P.H. FRT.

65-B.-

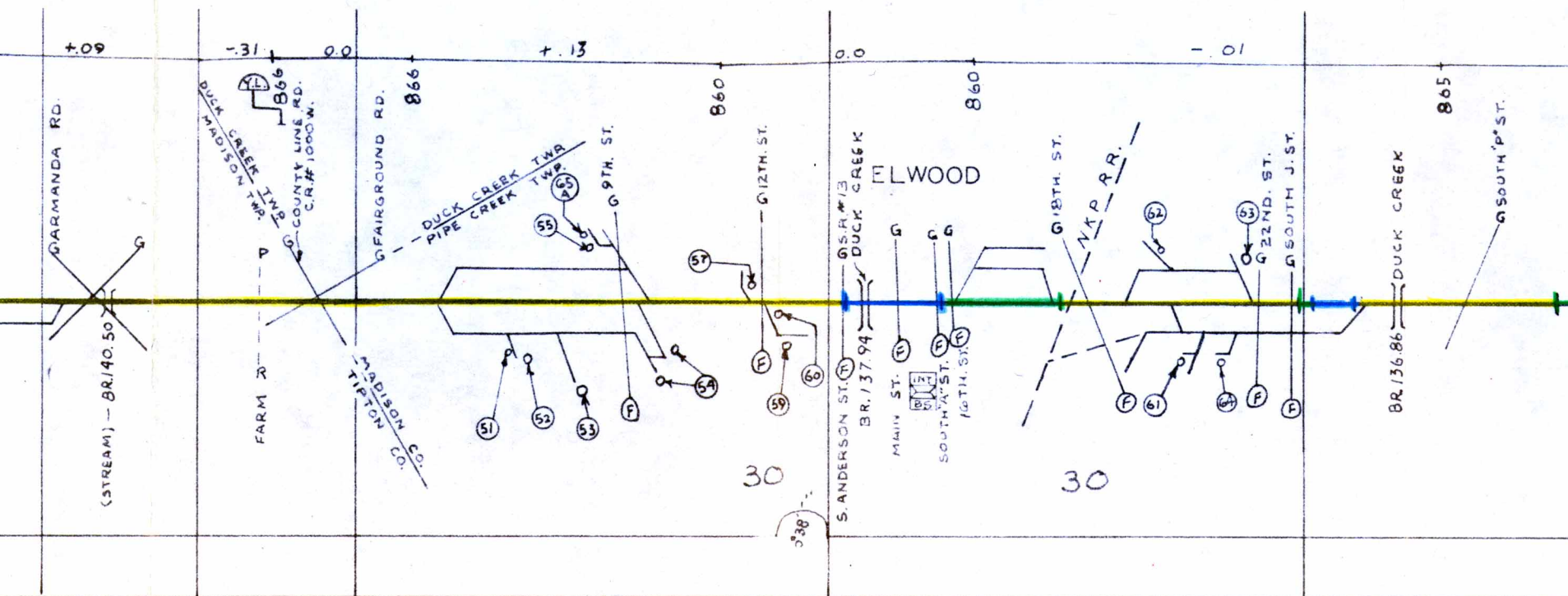

H. FRT.



137	5257'	136	5276'	135	5278'	134	5261'	133	5305'	132	5279'	131	5268'	130	527
-----	-------	-----	-------	-----	-------	-----	-------	-----	-------	-----	-------	-----	-------	-----	-----

66 FRANKTON LUMBER CO.  
 67 FARMERS GRAIN & COAL CO.  
 68  
 69

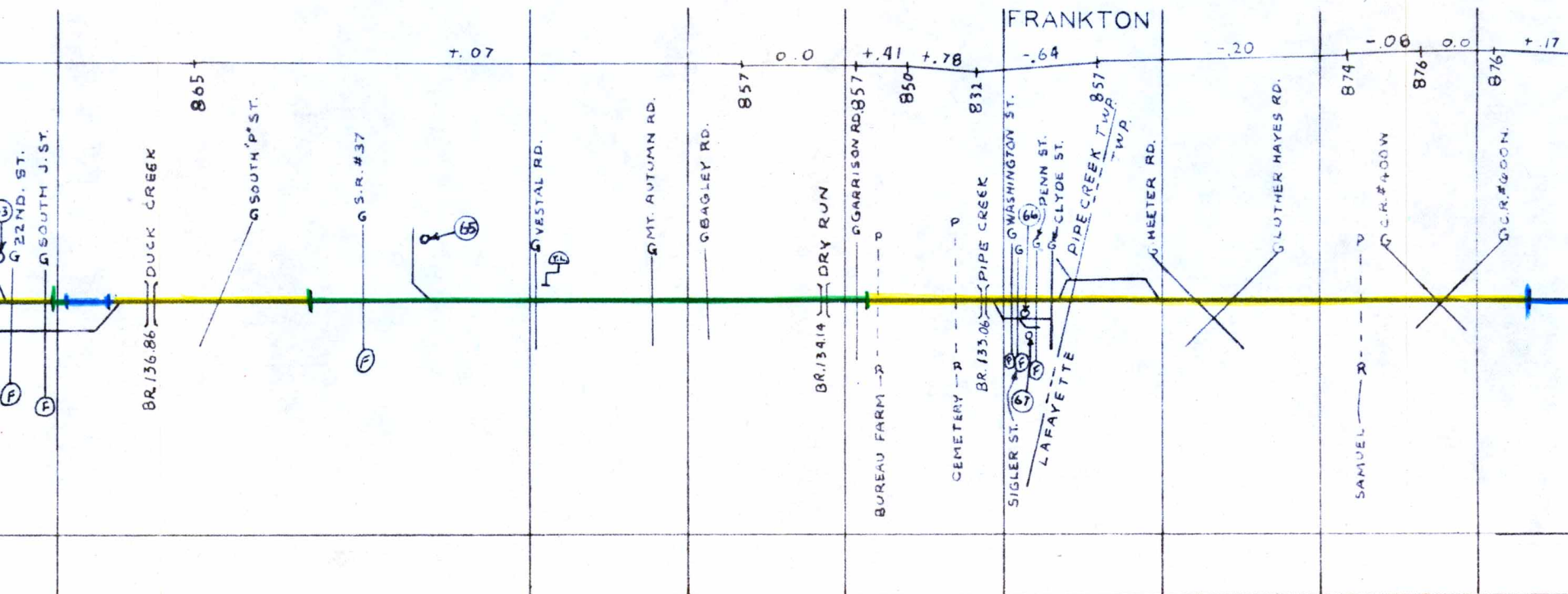

50 M.P.H. PASS. 40M.P.H FRT.

9' 131 5268' 130 5277' 129 5282' 128 5276' 127 5283' 126 5292'

69-A. NATIONAL MACHINERY EXCHANGE, INC.

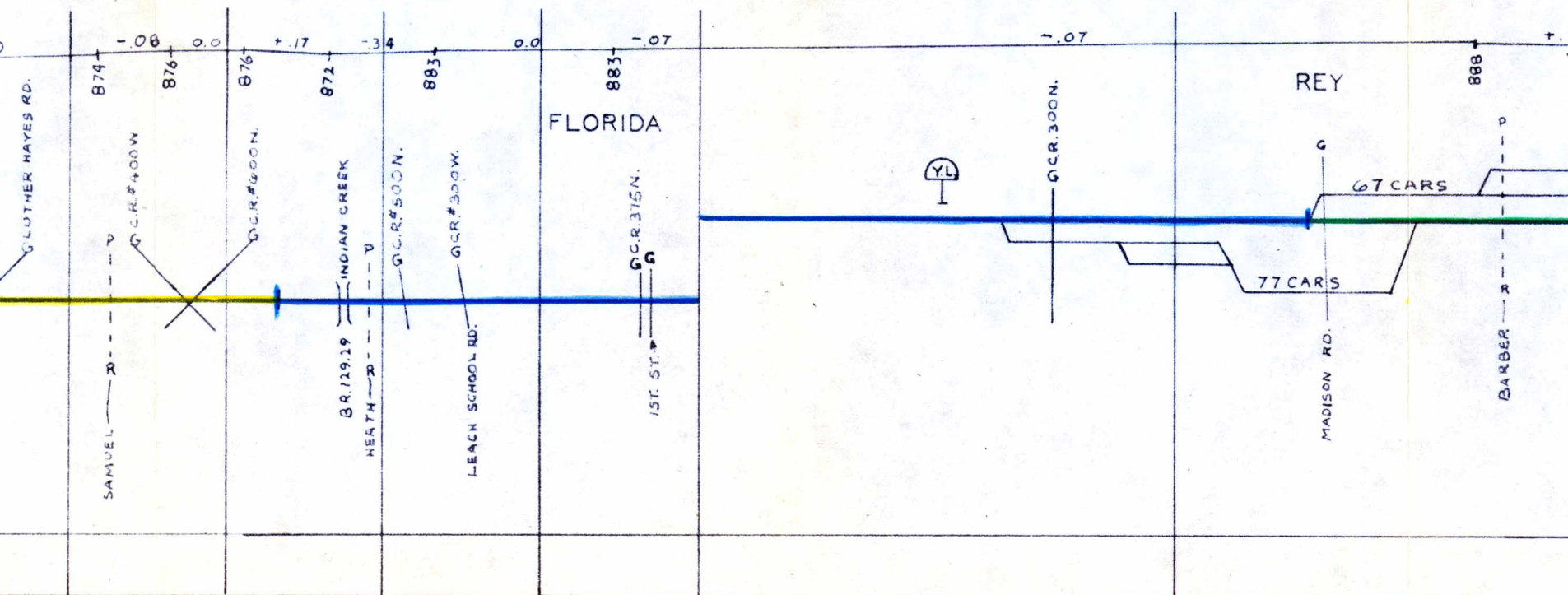

PH FRT.



5:

79

89

94 INDI

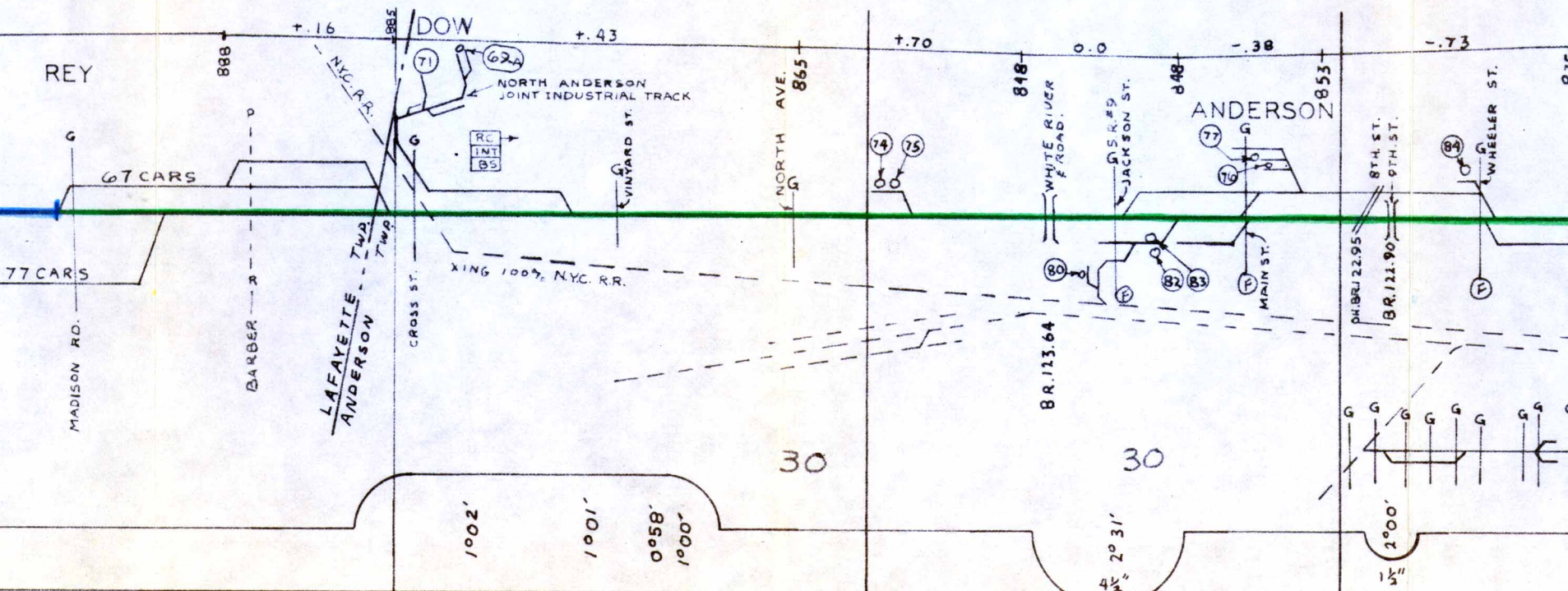



118

94 INDIANA MICHIGAN ELECTRIC CO.

TRACK  
GMC.

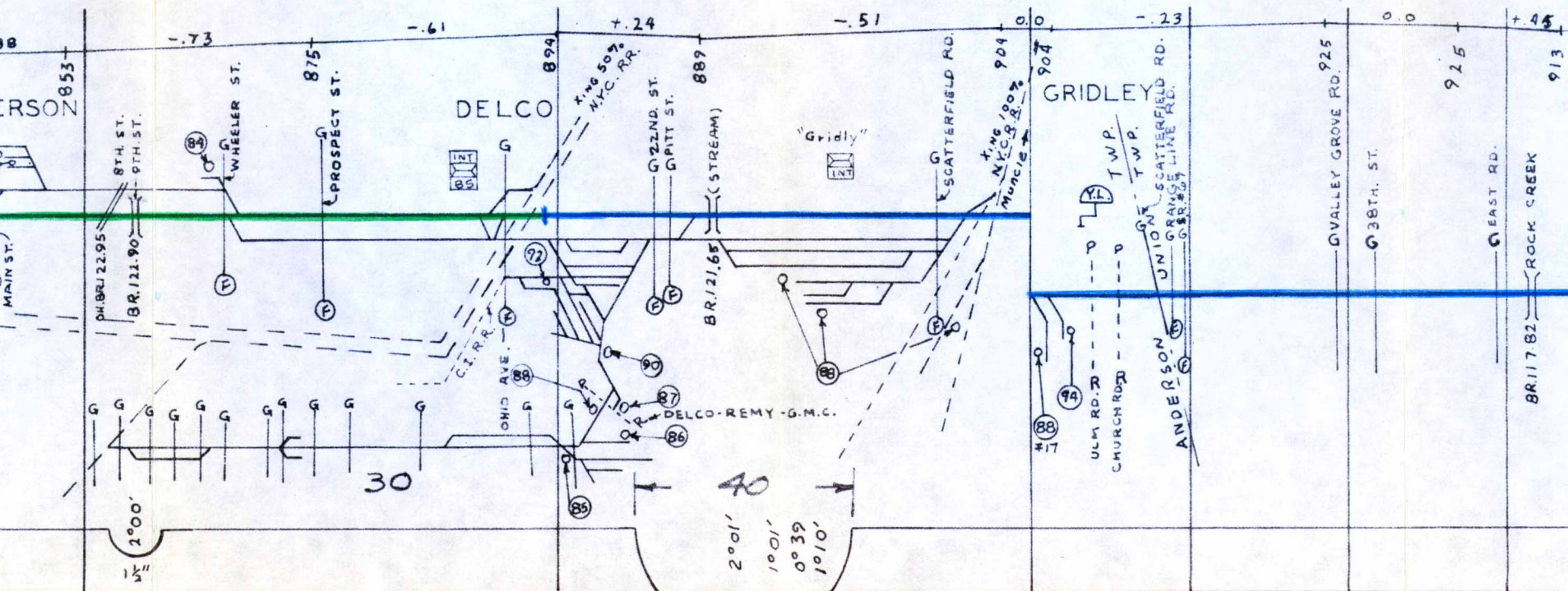



5263' 119 5286' 118 5307' 117 5253' 116 5286' 115 5332' 114 5217' 113 5286' 112 5269' 111 5299' 110

95 MARCELLA HOPPE'S COAL CO.  
 96 STOHLERS LUMBER CO. INC.  
 97  
 98 SMITH DOUGLAS CO. (Fertz)  
 99 HENRY COUNTY FARM BUREAU  
 100 WILSON GRAIN INC.  
 101 OSBORNE OLIVER SALES  
 102 SULPHUR SPRINGS LUMBER CO.  
 103 TRAINOR NATIONAL SPRING

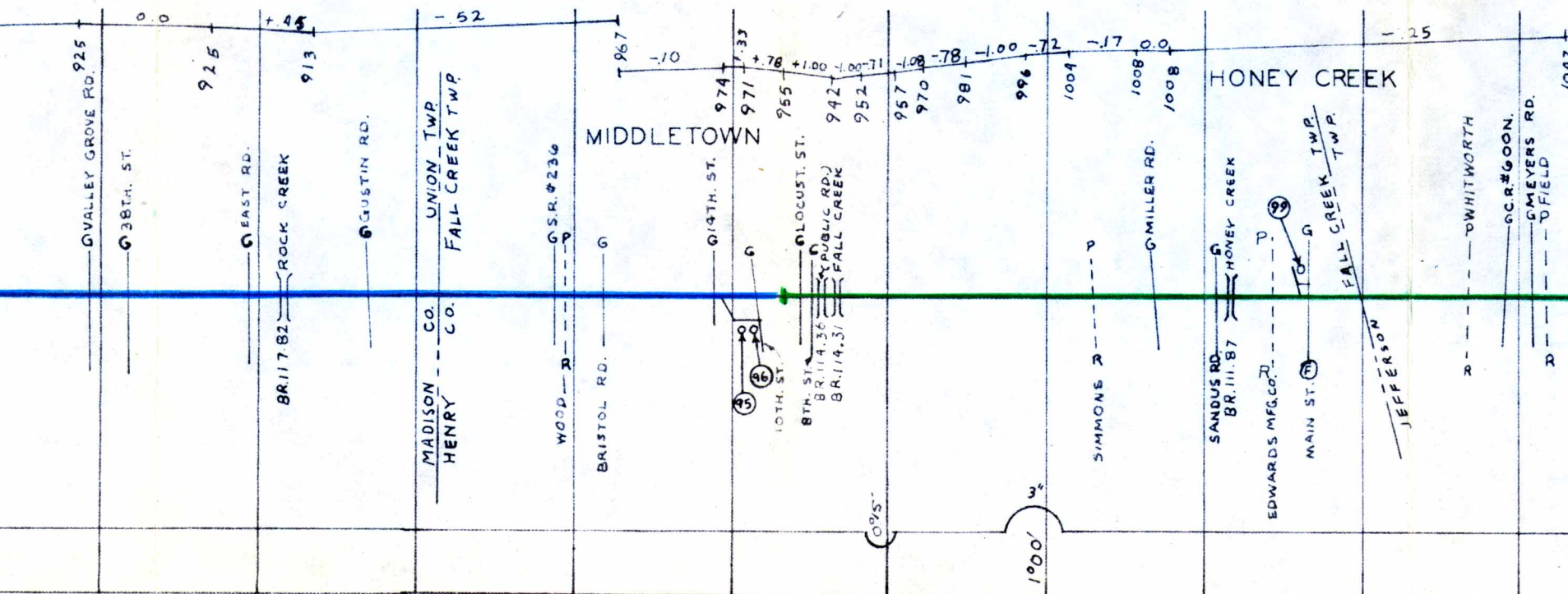

5269' 111 5299' 110 5275' 109 5272' 108 5291' 107 5264' 106 5297' 105 5269' 104 5304' 103 5266' 102

104 TEAM TRACK

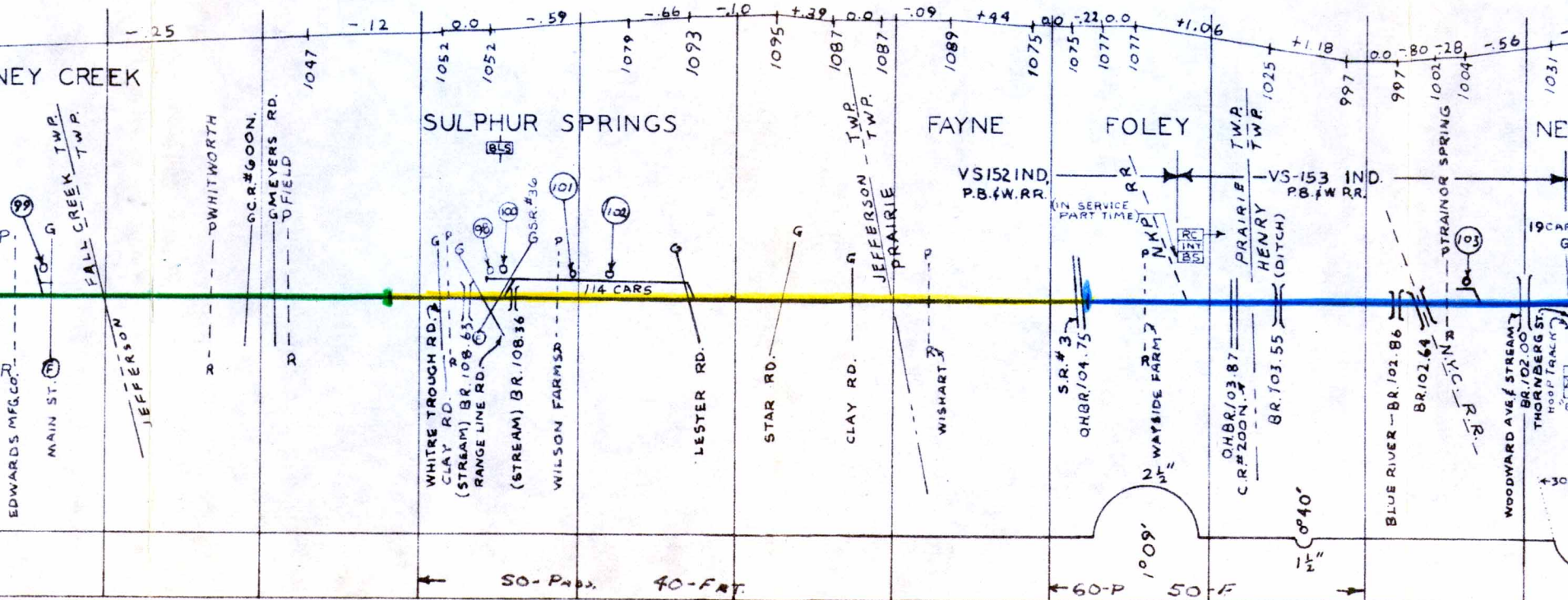

ANDERSON, INDIANA

50-P



5304' 103 5266' 102 5272' 101 5274' 100 5287' 99 5296' 98 5251' 97 5299' 96 5263' 95 5286' 94

105 PERFECT CIRCLE CO.  
106 MILLVILLE GRAIN CO.

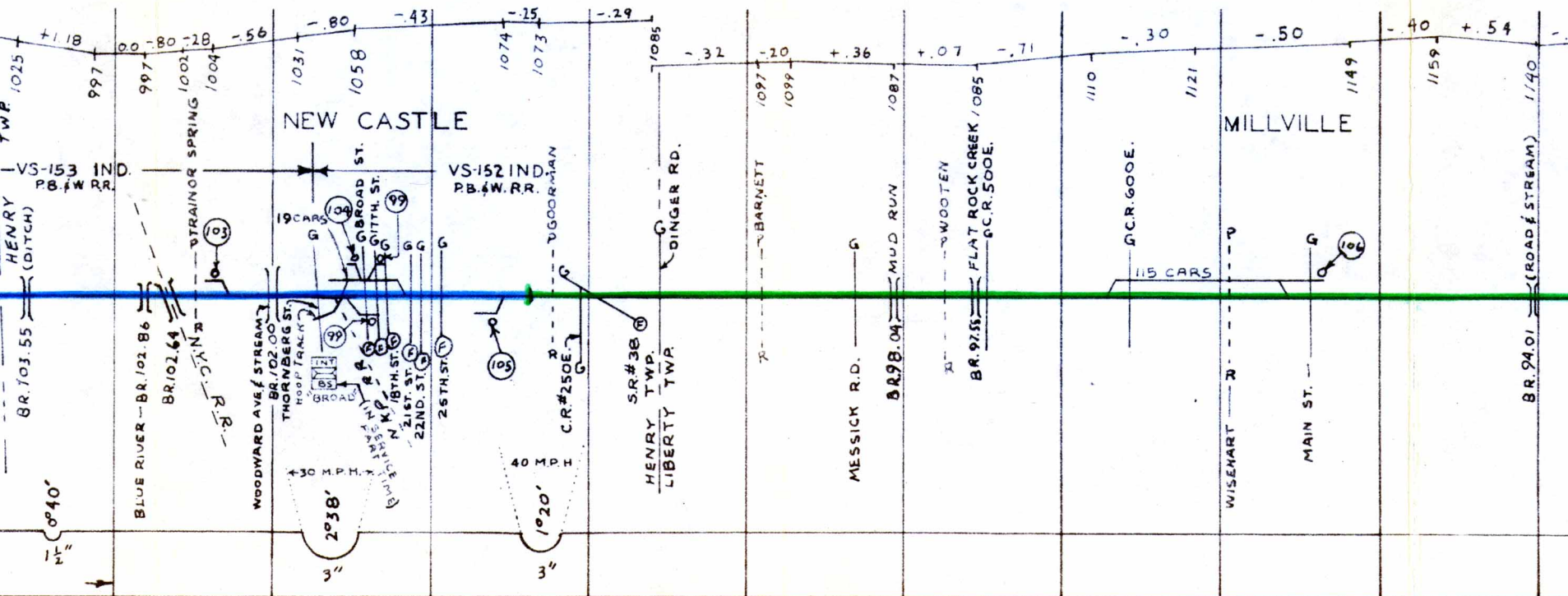

50-P 40-F

5263' 95 5286' 94 5575' 93 4986' 92 5289' 91 5269' 90 5368' 89 5073' 88 5385' 87 5282' 86

- [illegible]

SUPERVISOR D. J. KREISS



- 114  
115  
116 H. J. EAVEY Co.  
117 WAREHOUSE SERVICES  
118 UNIVERSAL ELECTRIC Co.  
119 HAUGHTON ELEVATOR Co.  
120 ANDERSON ICE & COAL Co.

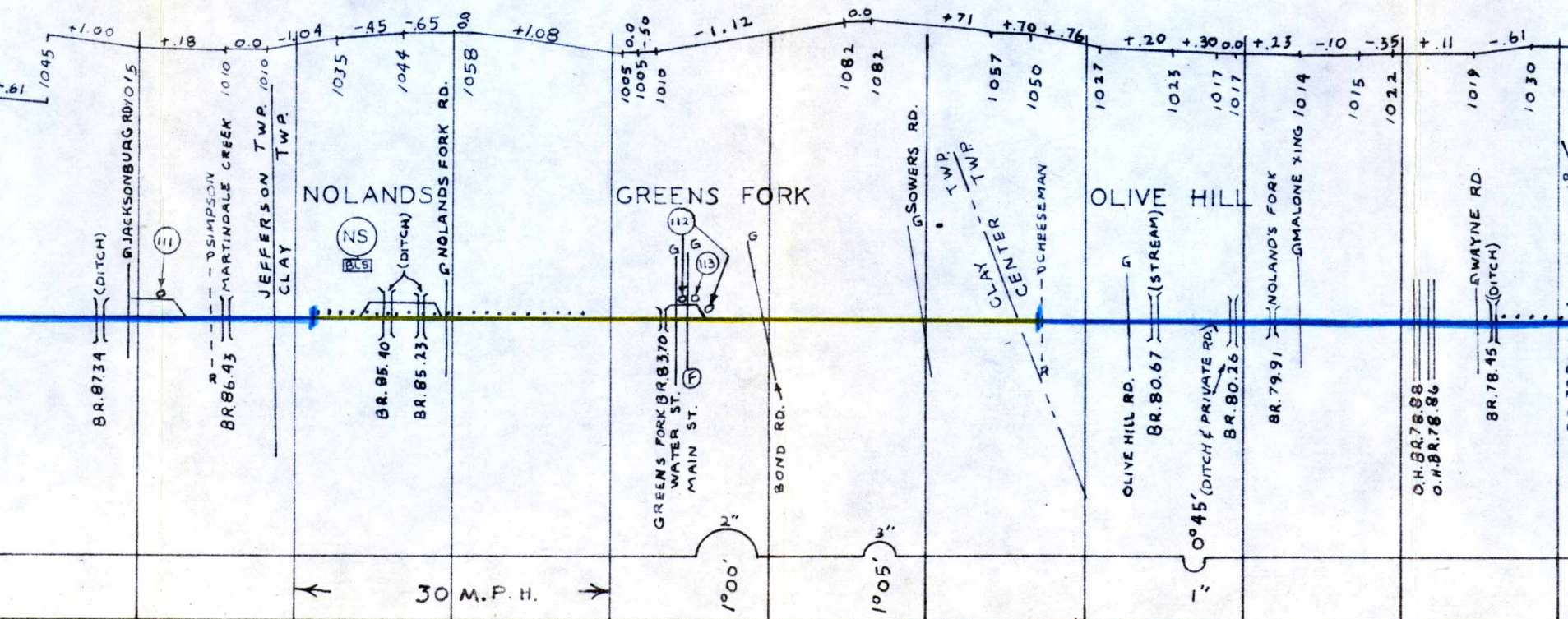

MAX. 50 M.P.H. PASS.

SUBDIVISION No.11

40 M



VEY Co.  
 HOUSE SERVICES  
 SAL ELECTRIC CO.  
 TON ELEVATOR CO.  
 SON ICE & COAL CO.

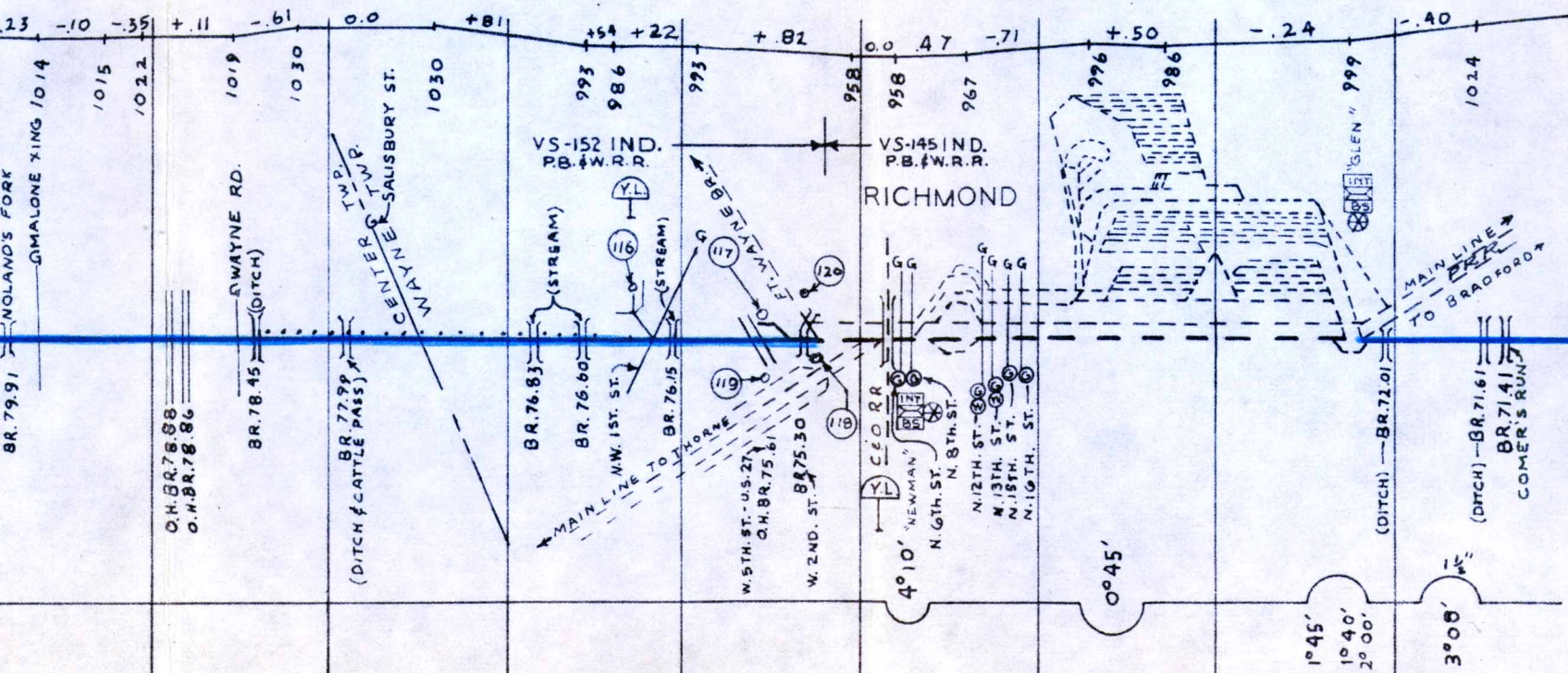

No.11

40 M.P.H. F.R.T.



RICHMOND BR.  
RICHMOND  
TO ANOKA

# RICHMOND BRANCH

RICHMOND  
TO  
ANOKA

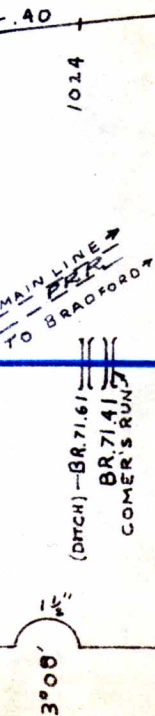

- 1 OLIN MATHIESON CHEMICAL CORP.
- 2
- 3
- 4 U.M. ARMACOST ELEVATOR
- 5 HINDE & DAUCH PAPER CO.
- 6 PREBLE CO. FARM BUREAU
- 7 THE TEXAS CO.

