

13



3 5279' 4 5338' 5 5281' 6 5278' 7 5274' 8 5280' 9 5279' 10 5275' 11 5279'

14. MORRIS BEAN COMPANY

27. ANTIOCH COLLEGE POWER PLANT

15.

28. BRICE LINKHART

16.

29. DEWINE & HAMMA

17.

30. W.B. DAWSON COAL CO.

18.

31.

19.

32.

20.

33.

21.

34.

22.

35.

23.

36.

24.

37.

25.

38.

26.

39.

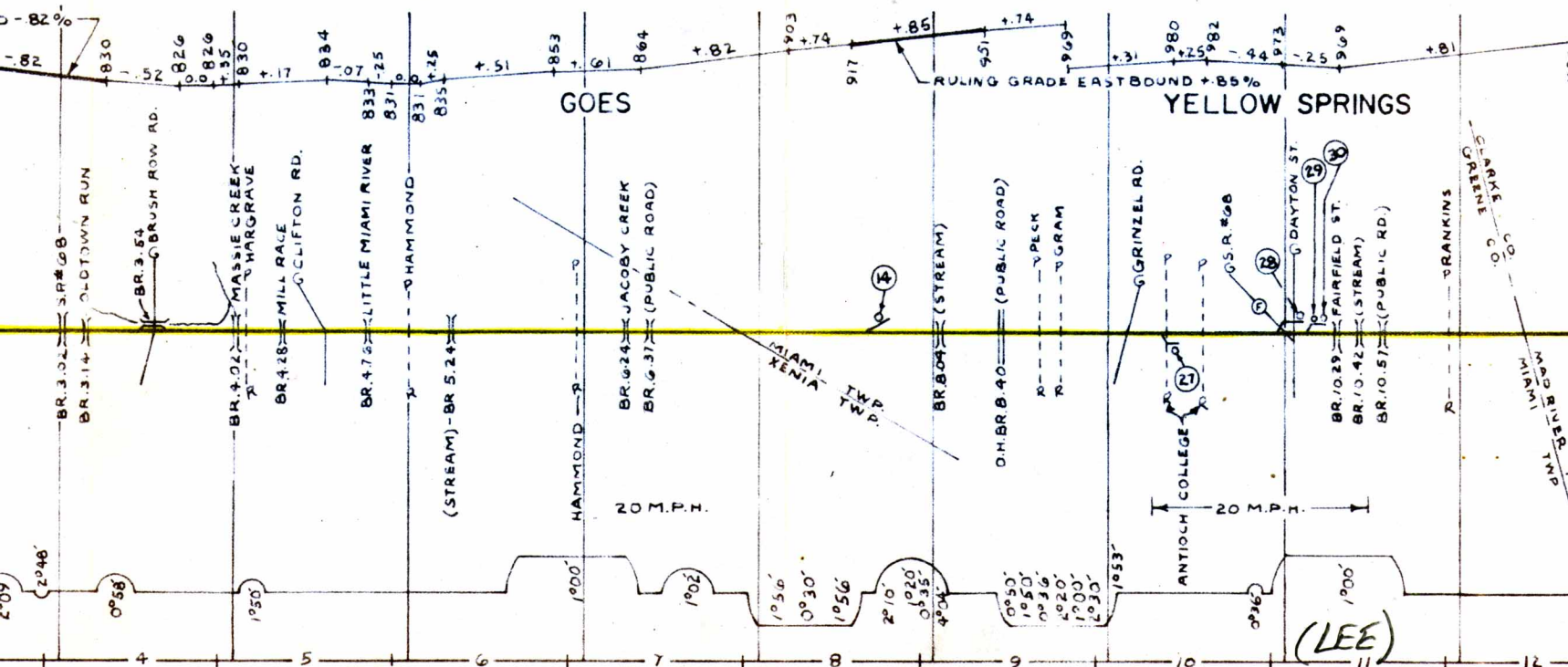

SUPERVISOR L.C. CARPENTER

66. WAGN  
67. WINC  
68. W. R.  
69. E. W.  
70. W. E.  
71. I. G. A  
72.  
73.  
74.  
75.  
76.  
77.  
78.





5276' 19 223'

66. WAGNER SERVICE, INC.  
67. WINCHESTER CARTON CORP.  
68. W. R. HACKETT - FRUIT & STORAGE  
69. E. W. FULMER CO.  
70. W. E. TUTTLE & CO.  
71. I. G. A. STORES  
72.  
73.  
74.  
75.  
76.  
77.  
78.

SPRINGFIELD

SPRINGFIELD BRANCH

XENIA  
TO

SPRINGFIELD

( Springfield Secondary Track )

( The direction from Xenia to Springfield is eastward )

03 OHIO L.M.R.R. —  
19 —  
XENIA, OHIO