

1963
Program

MARIETTA
BRANCH

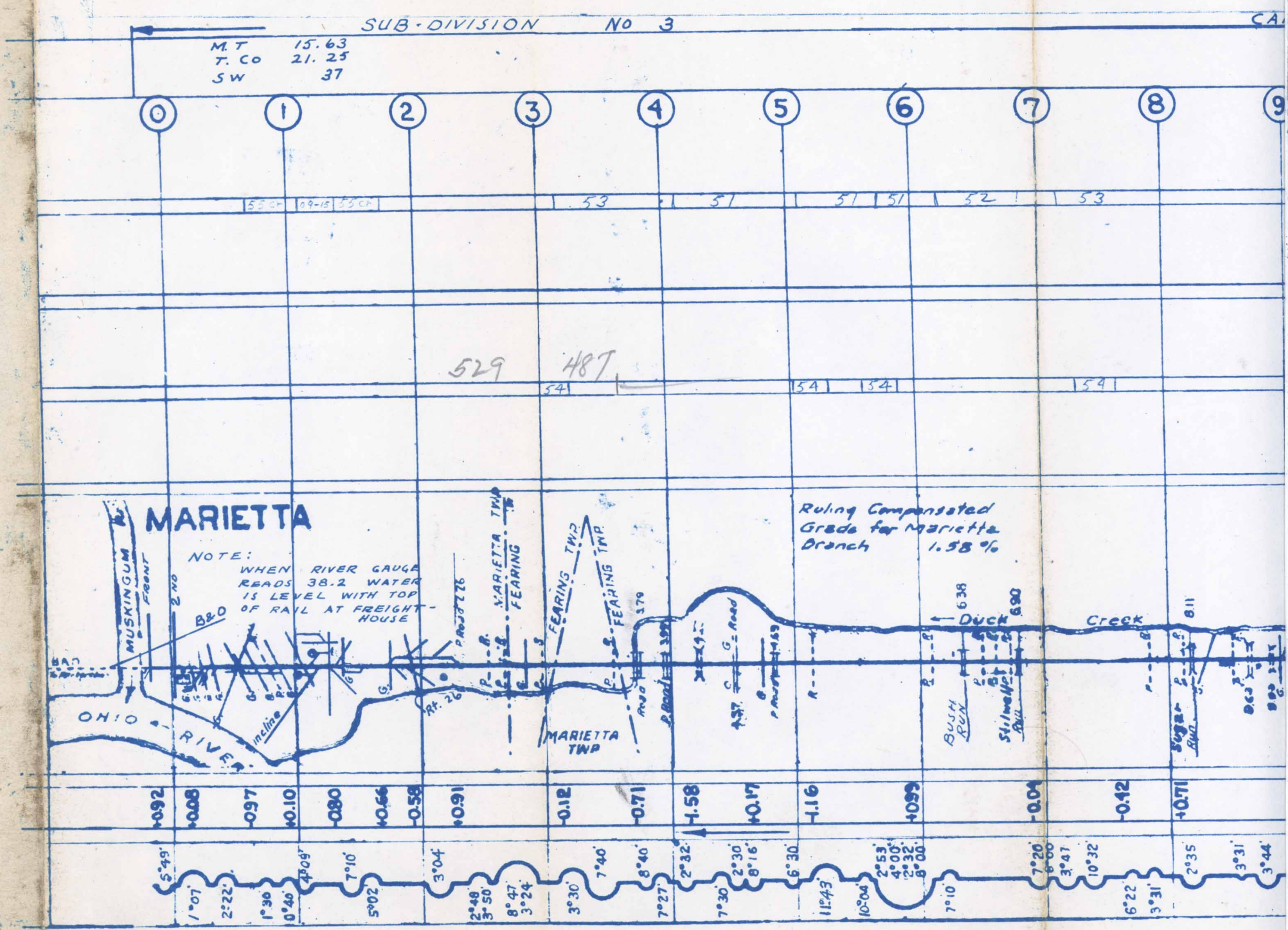

ETTA
BRANCH



R. P. DIEHL
MARIETTA, O.

M. T	19.5
T. Co	22
SW	14

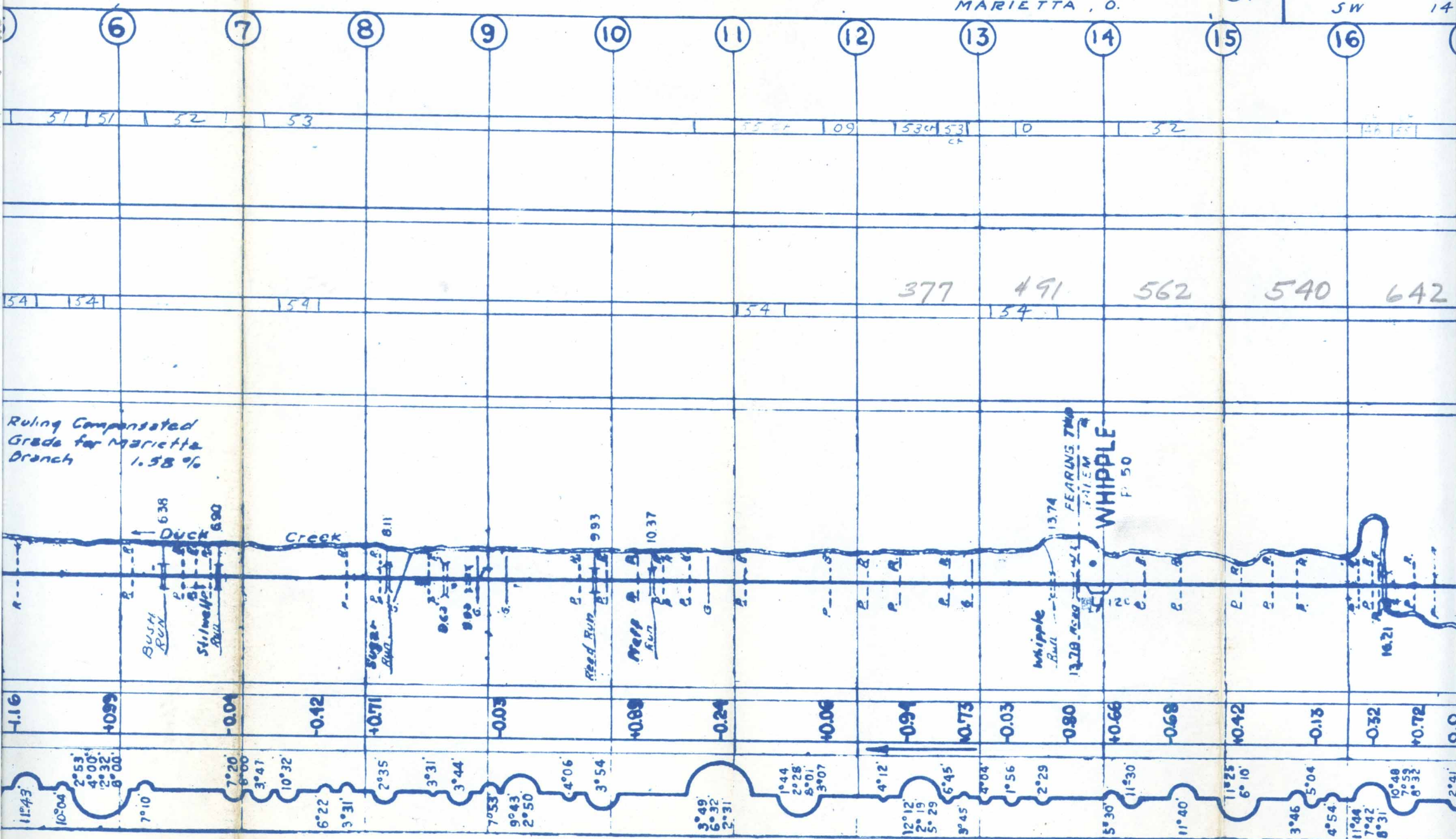

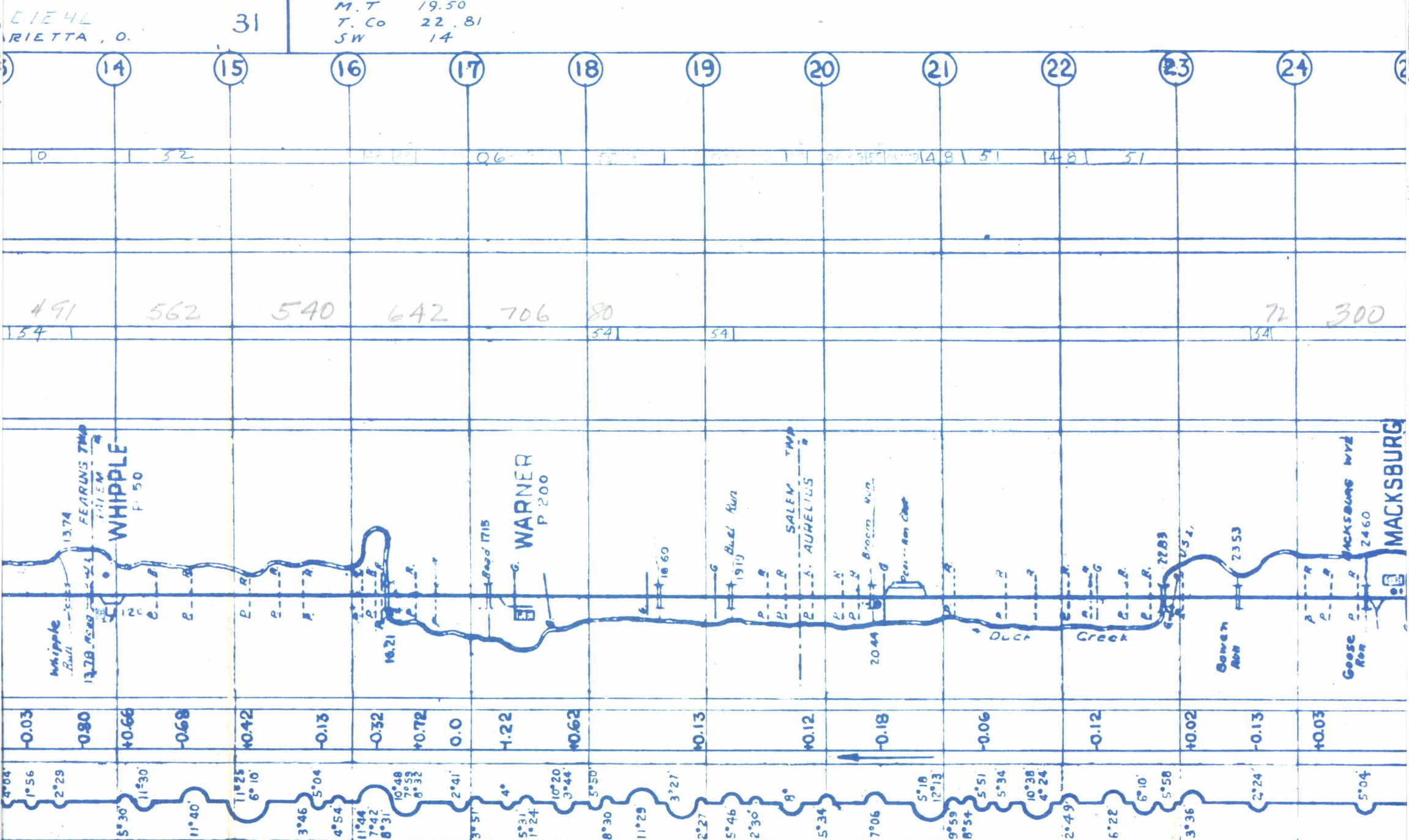

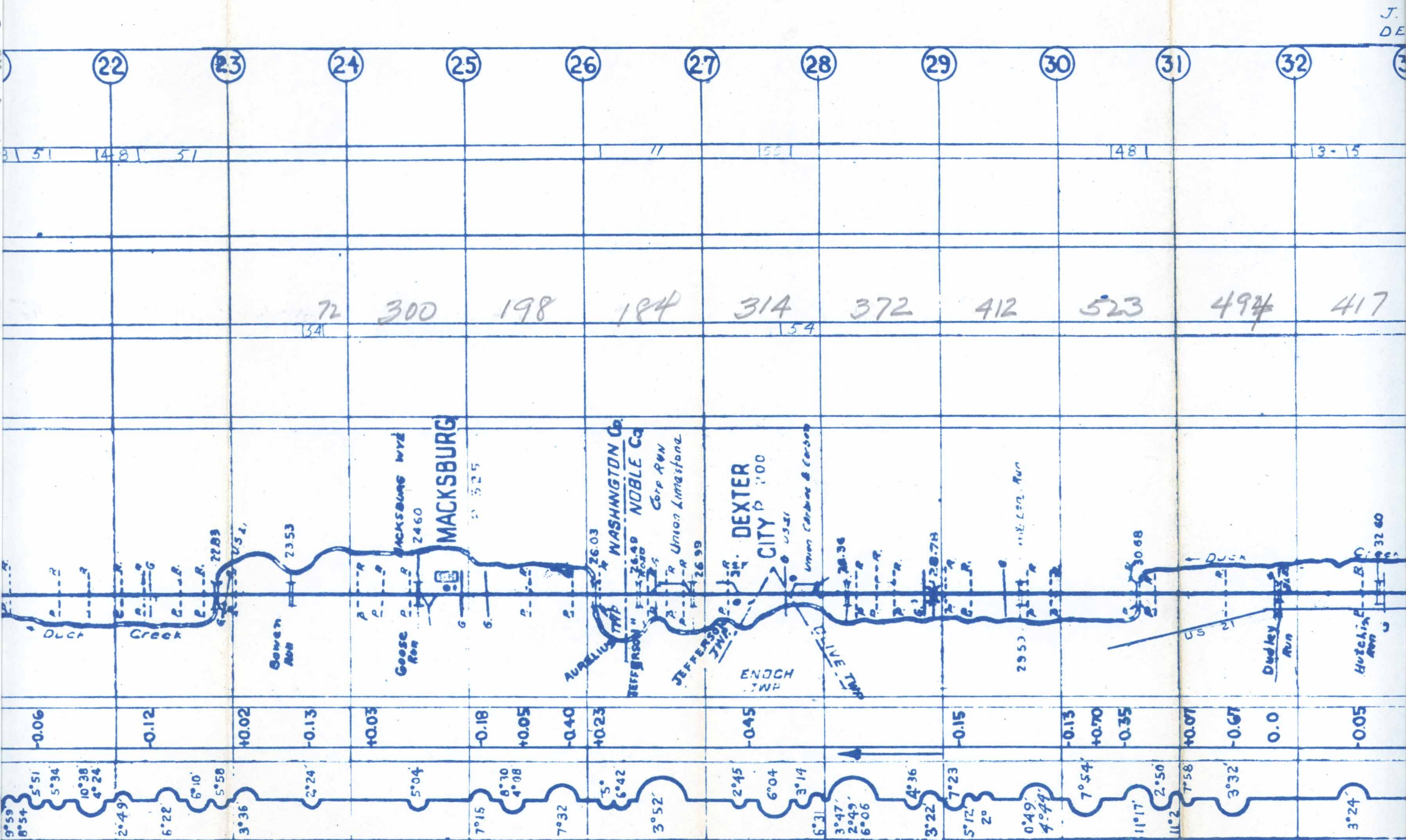

J. H. BATES
DEXTER CITY, O.

32

M.T. 18.50
T. Co 20.64
SW 22

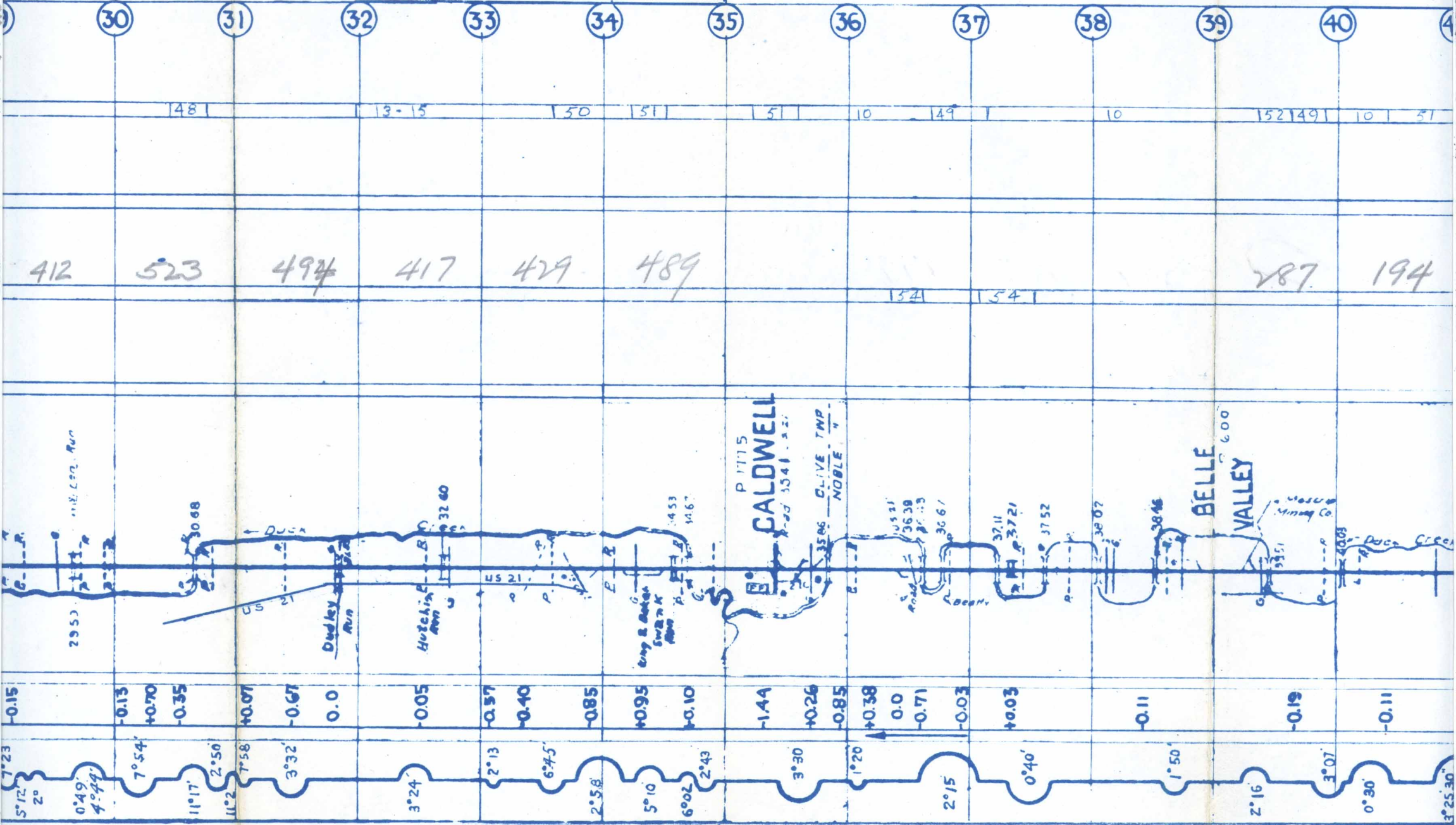

F. A. DEVER

SUPERVISOR

CA

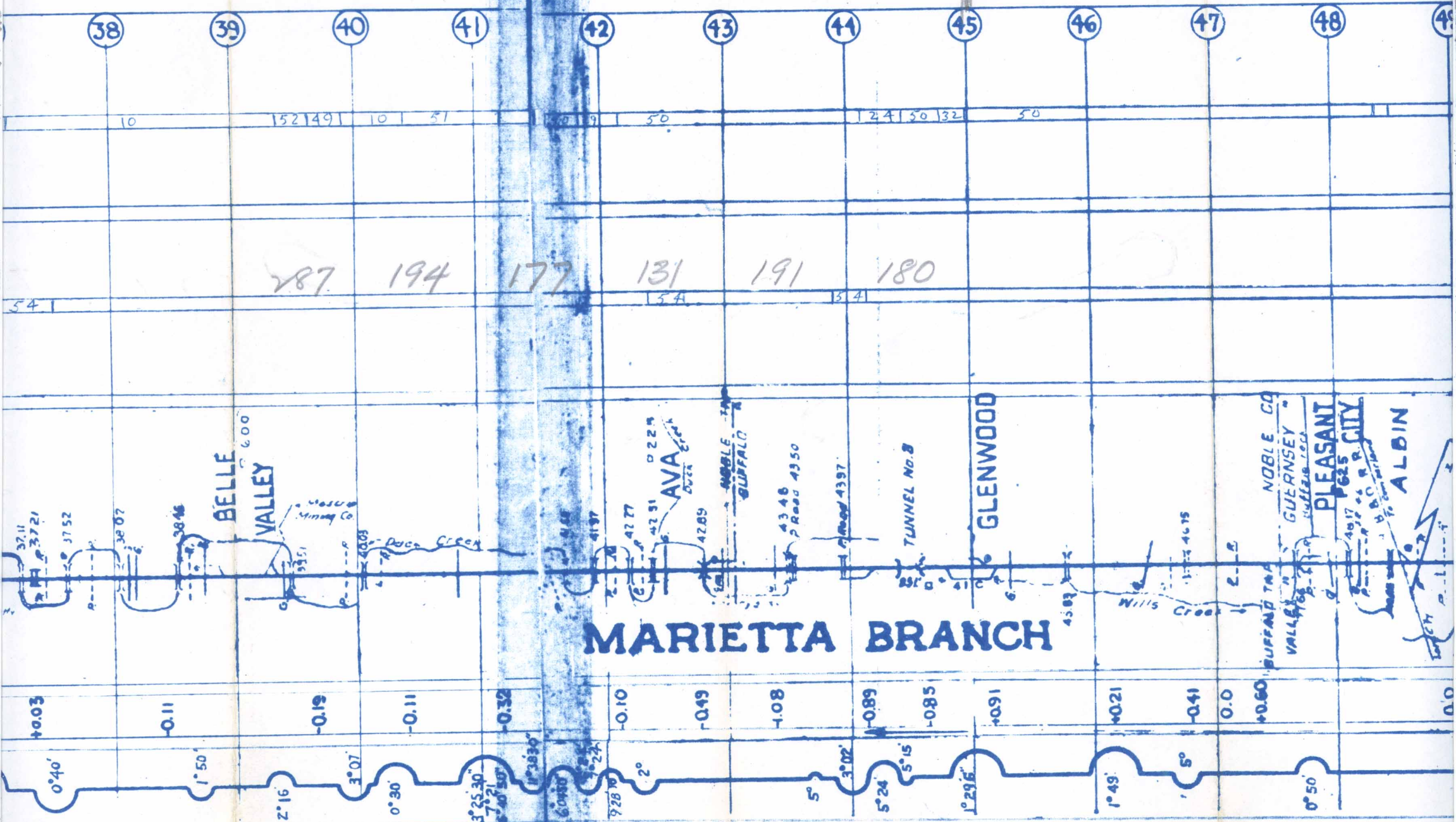

F.A. DEVER

SUPERVISOR

CAMBRIDGE, Ohio

L.H. SPROUT
GLENWOOD, O.

33

M.T.
T. CO.
SW

16.96
31.01
70

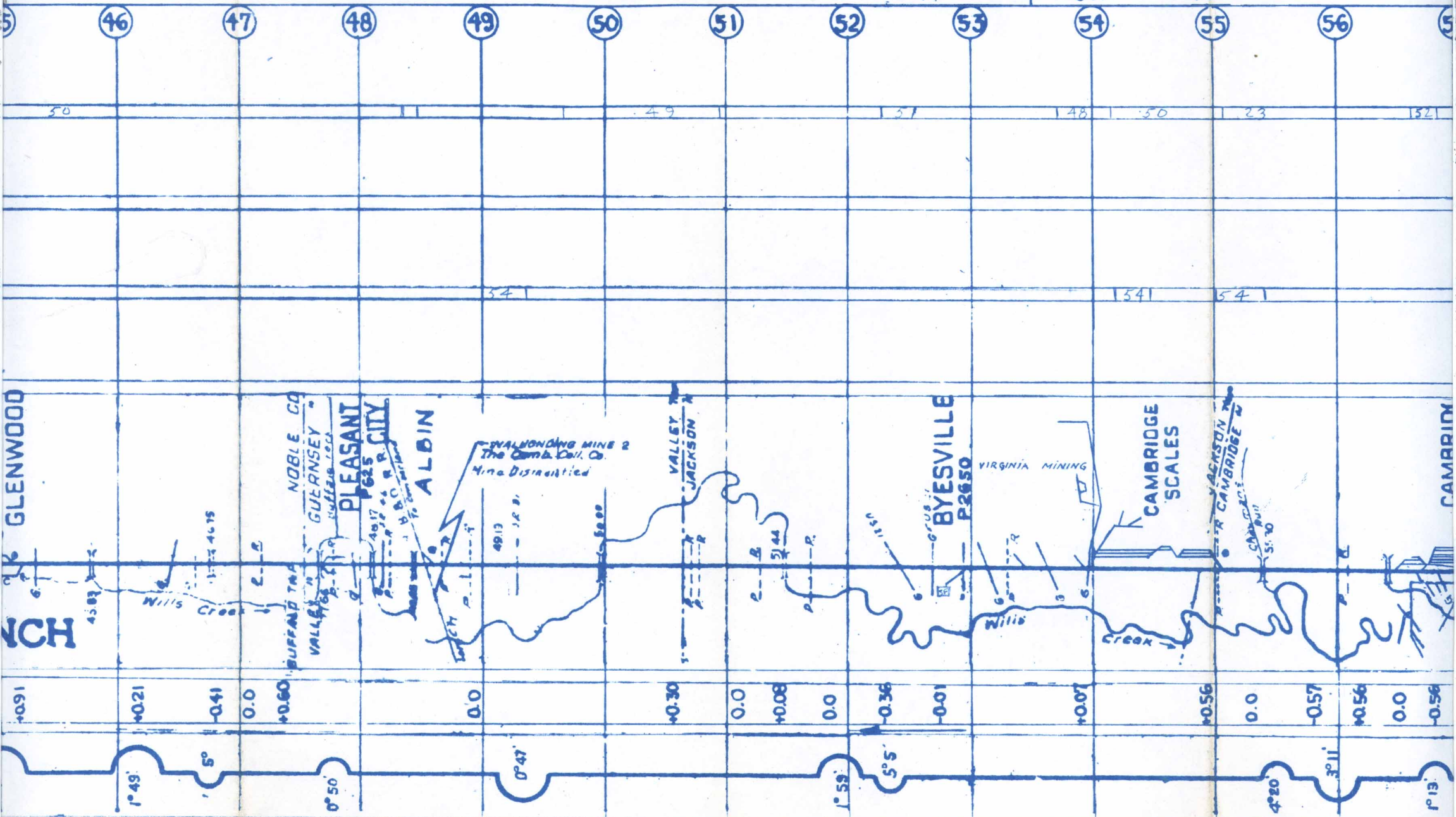

M.T.	16.96
T. CO.	31.01
SW	70

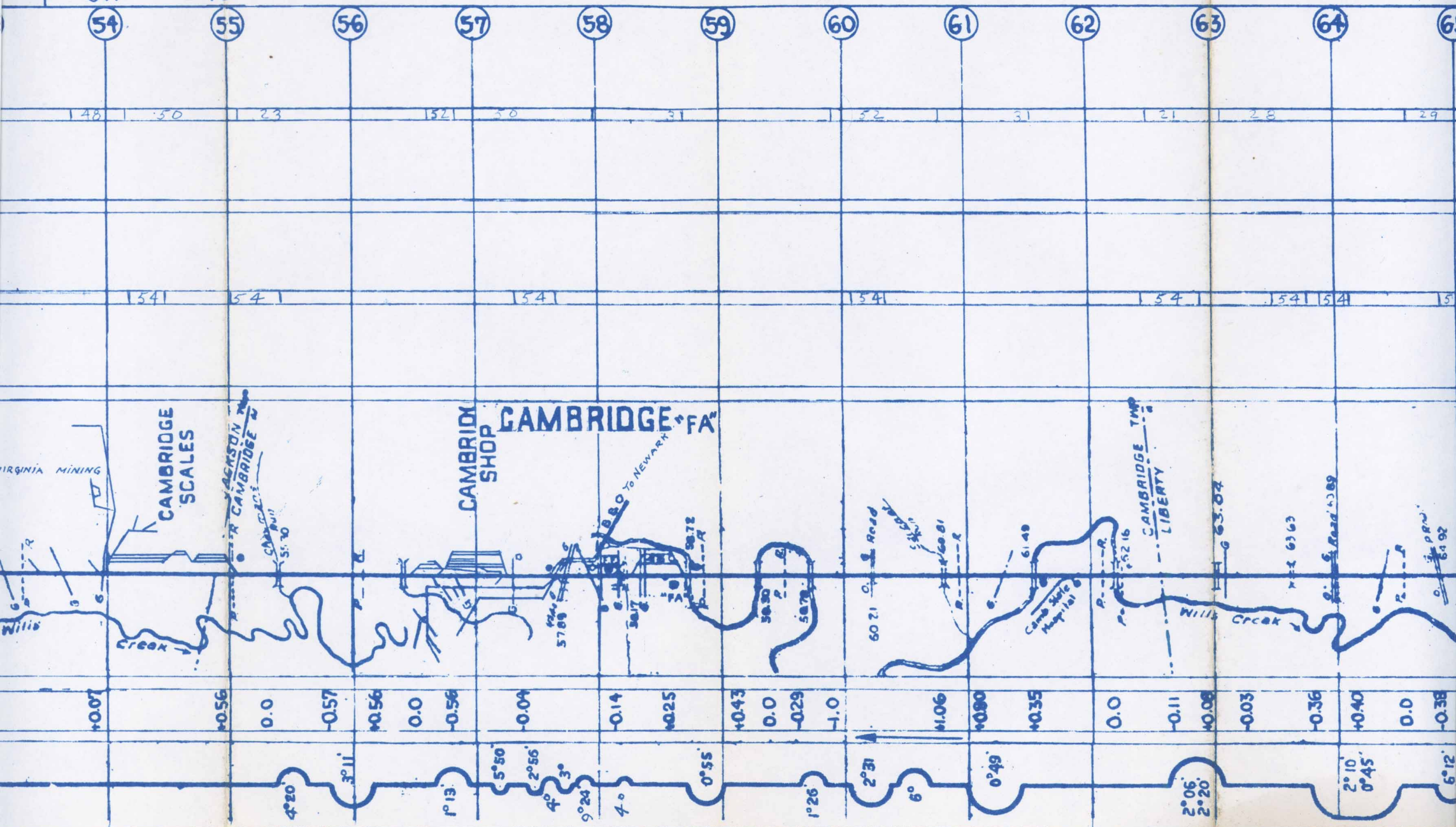

W. D. DURBEN

34

M. T. 18.73
T. CO. 23.72
SW 34

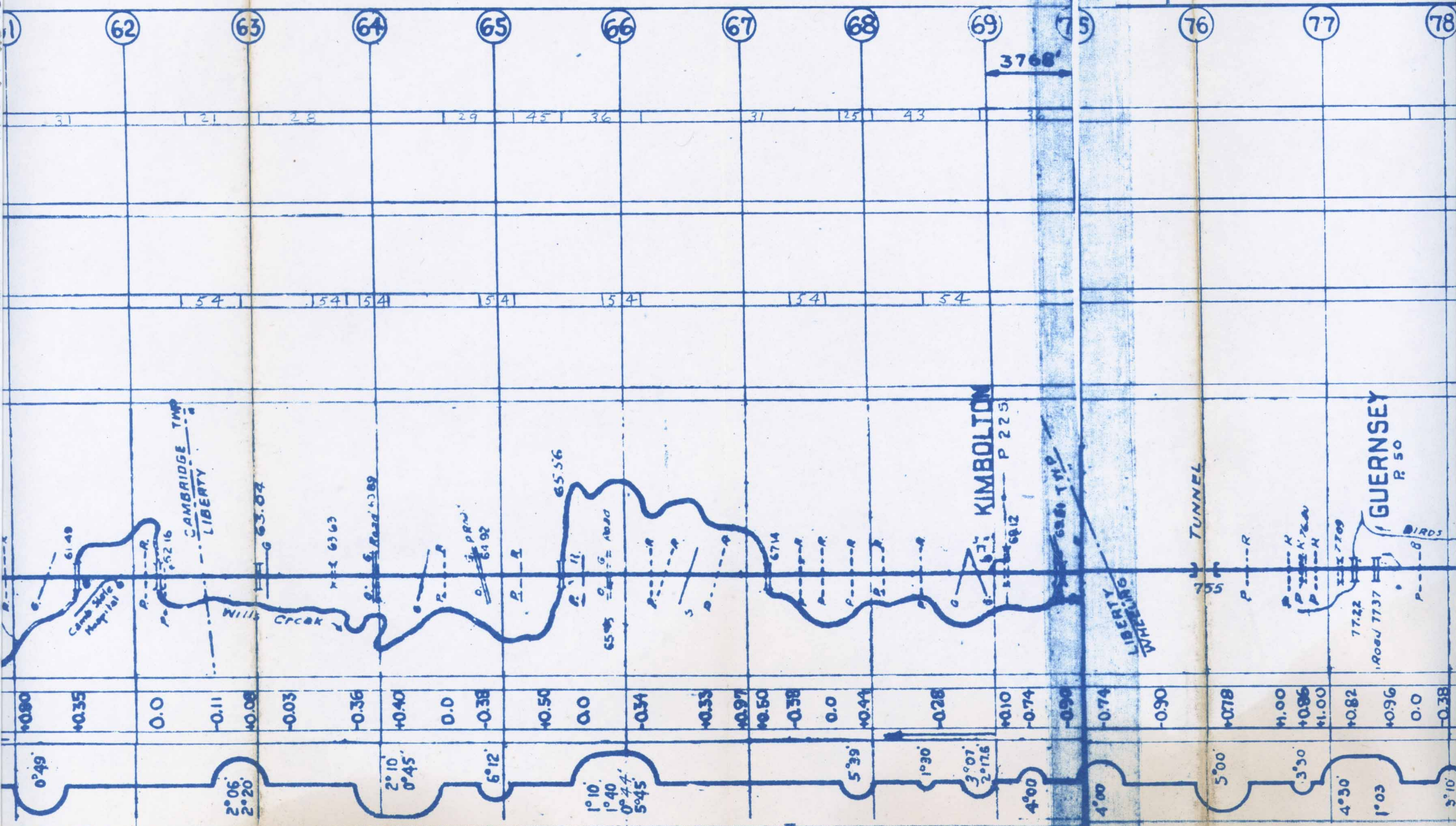

F. A. DEVER - SUPERVISOR

CAMBRIDGE - OHIO

F. J. TORGLER
NEW COMERSTOWN

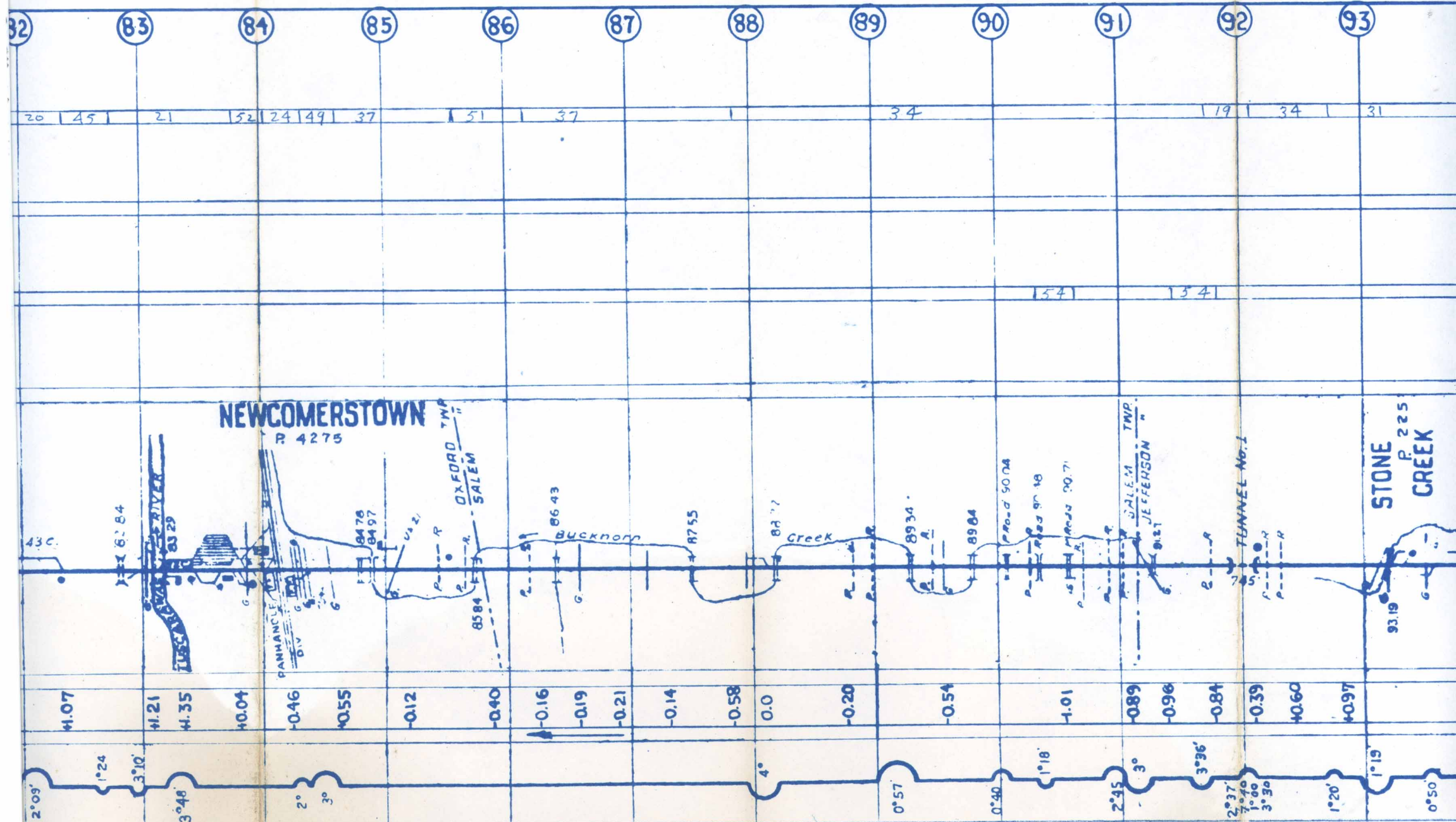

CAMBRIDGE - OHIO

F. J. TORGLER 35
NEW COMERSTOWN, O.

M.T. 21.17
T. CO. 34.48
SW 77

E. L.
DOV

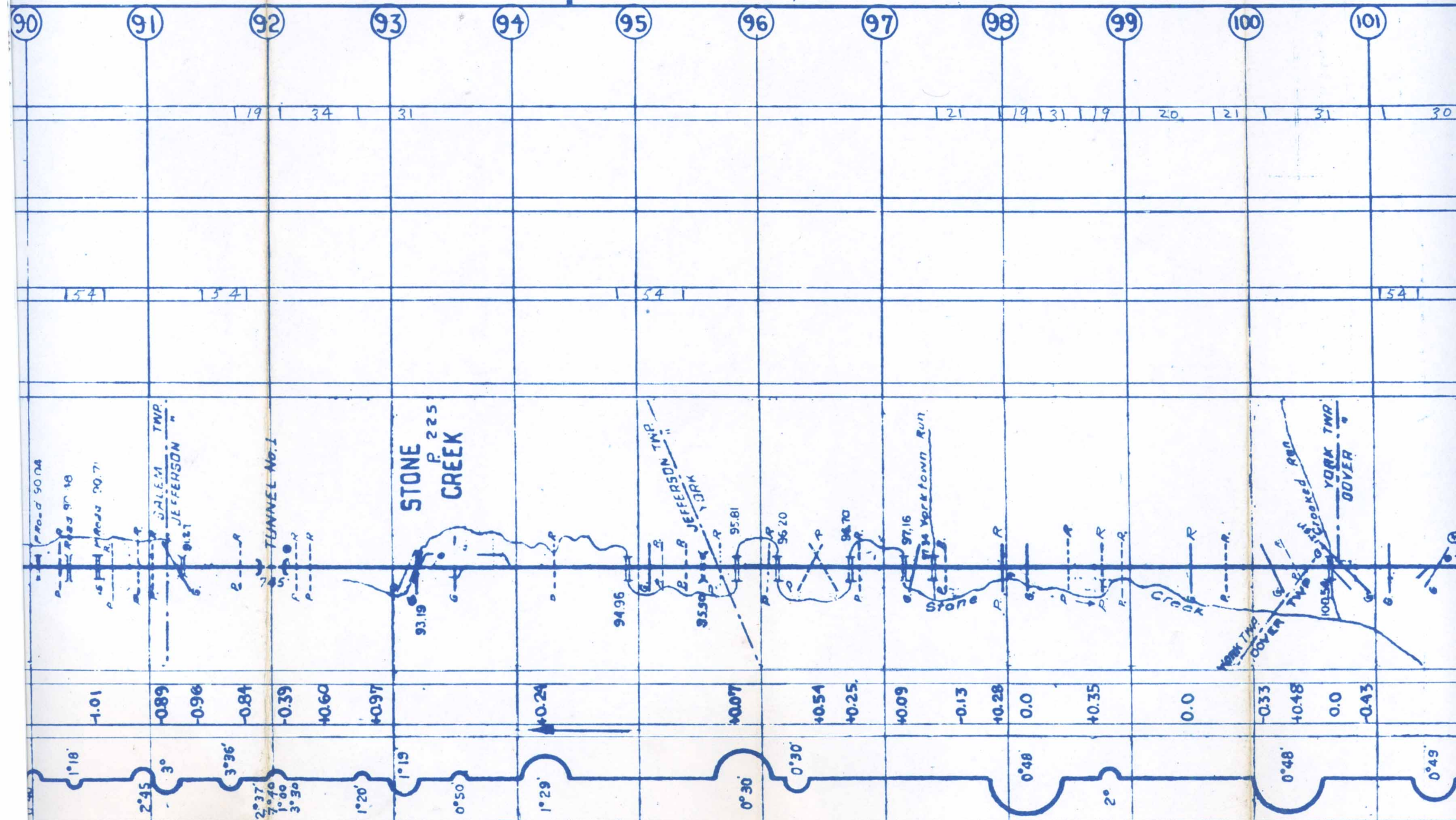

A. DEVER - SUPERVISOR - CAMBRIDGE, Ohio

SUB-DIVISION No 3

E. L. FINLEY
DOVER, O.

36

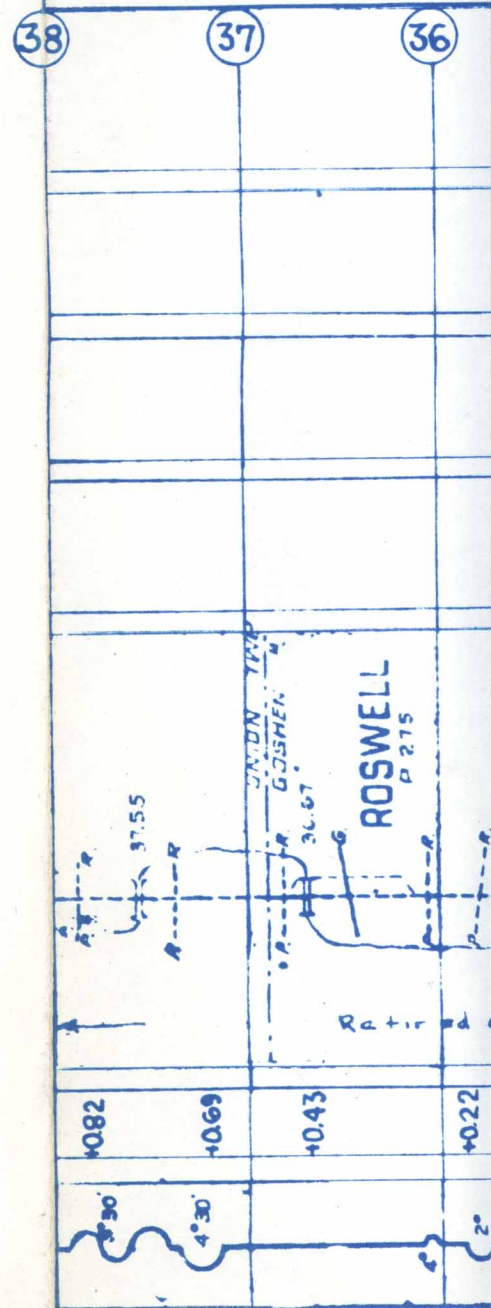
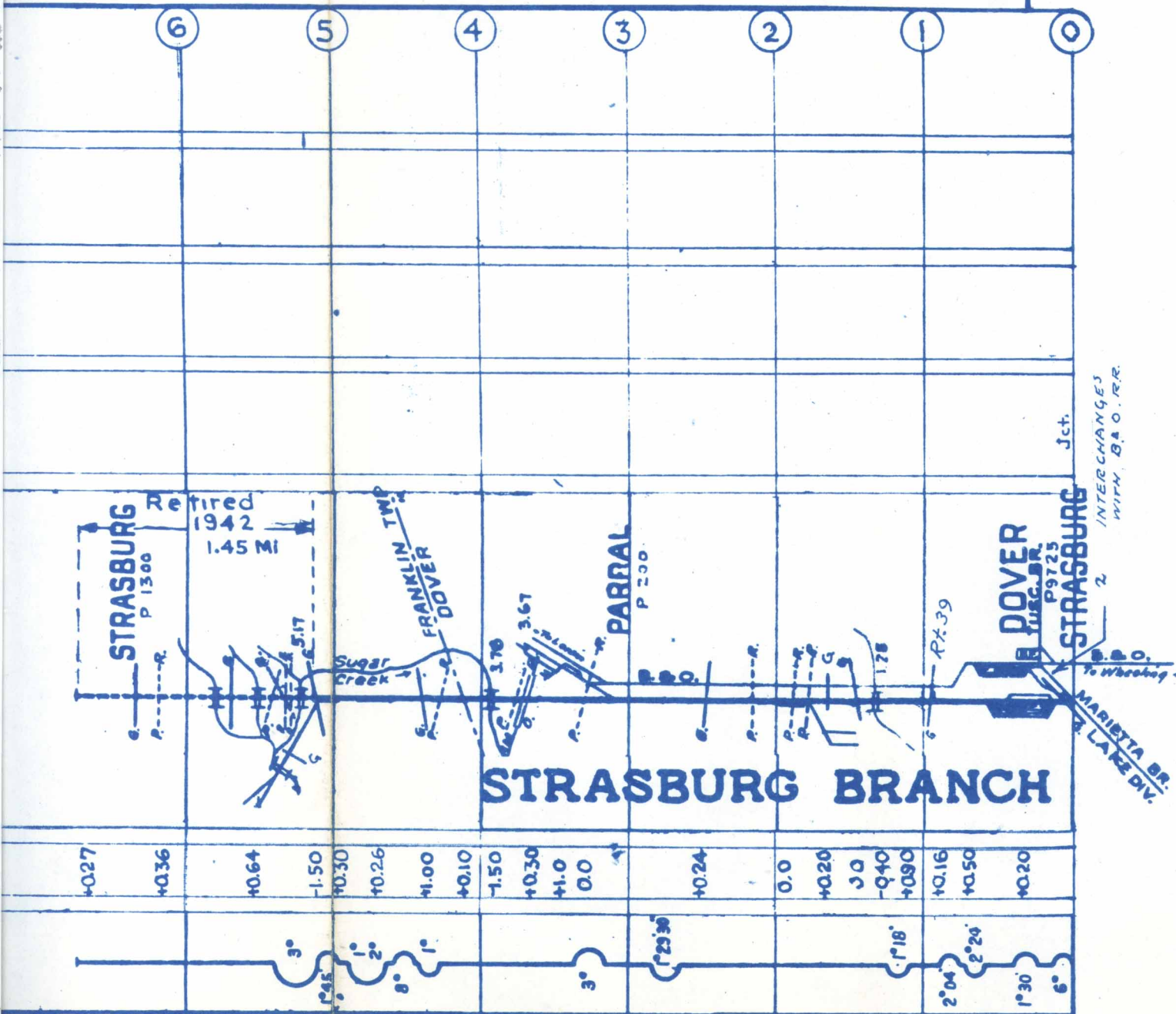

SUB - DIVISION No 3

E.L. FINLEY
Dover, O.

36

