

REVISED TO: JAN 1, 1992

# MULFORD LINE

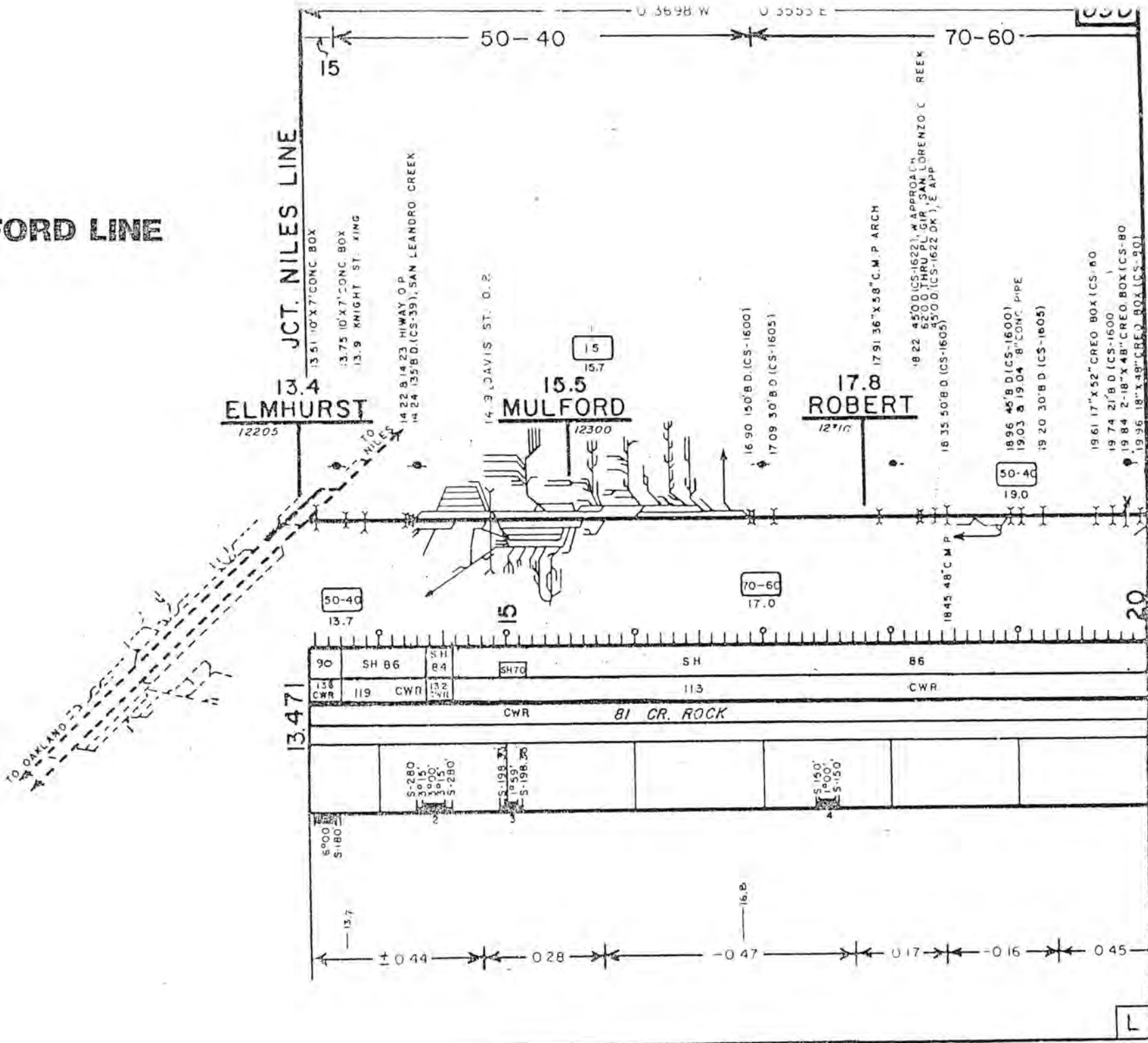

REVISED TO: JAN 1, 1992

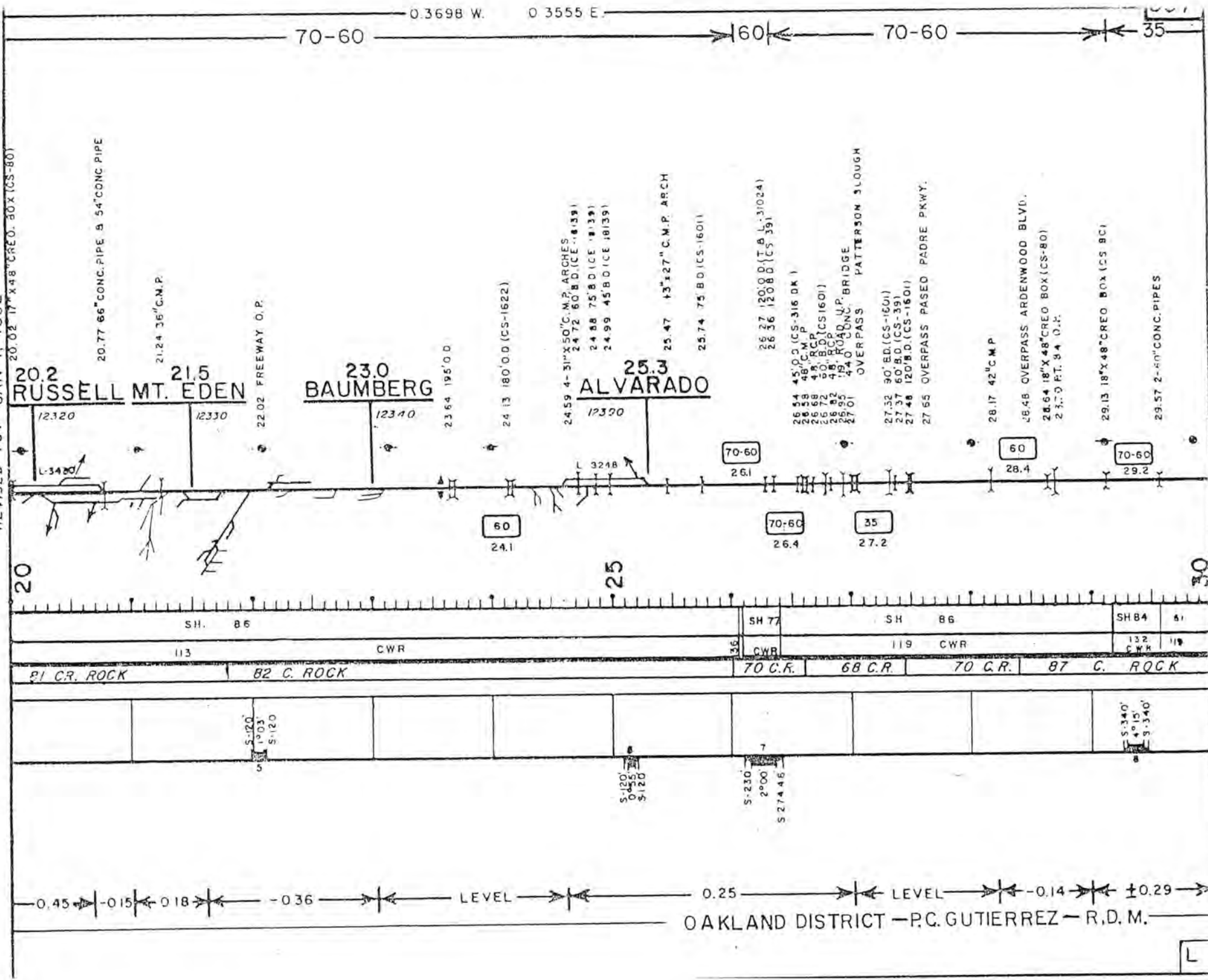

SH. 85	SH 77	SH 86	SH 84
113	36	119	132
C1 C.R. ROCK	CWR	70 C.R.	68 C.R.
B2 C. ROCK		70 C.R.	87 C. ROCK
S-120 0+45 1+03 S-120	S-230 0+55 2+00 S-274.46	S-340 4+15 S-340	
0.45	0.25	0.14	±0.29
-0.15	0.18	-0.36	
LEVEL			

OAKLAND DISTRICT - P.C. GUTIERREZ - R.D.M.

L

REVISED TO: JAN 1, 1992

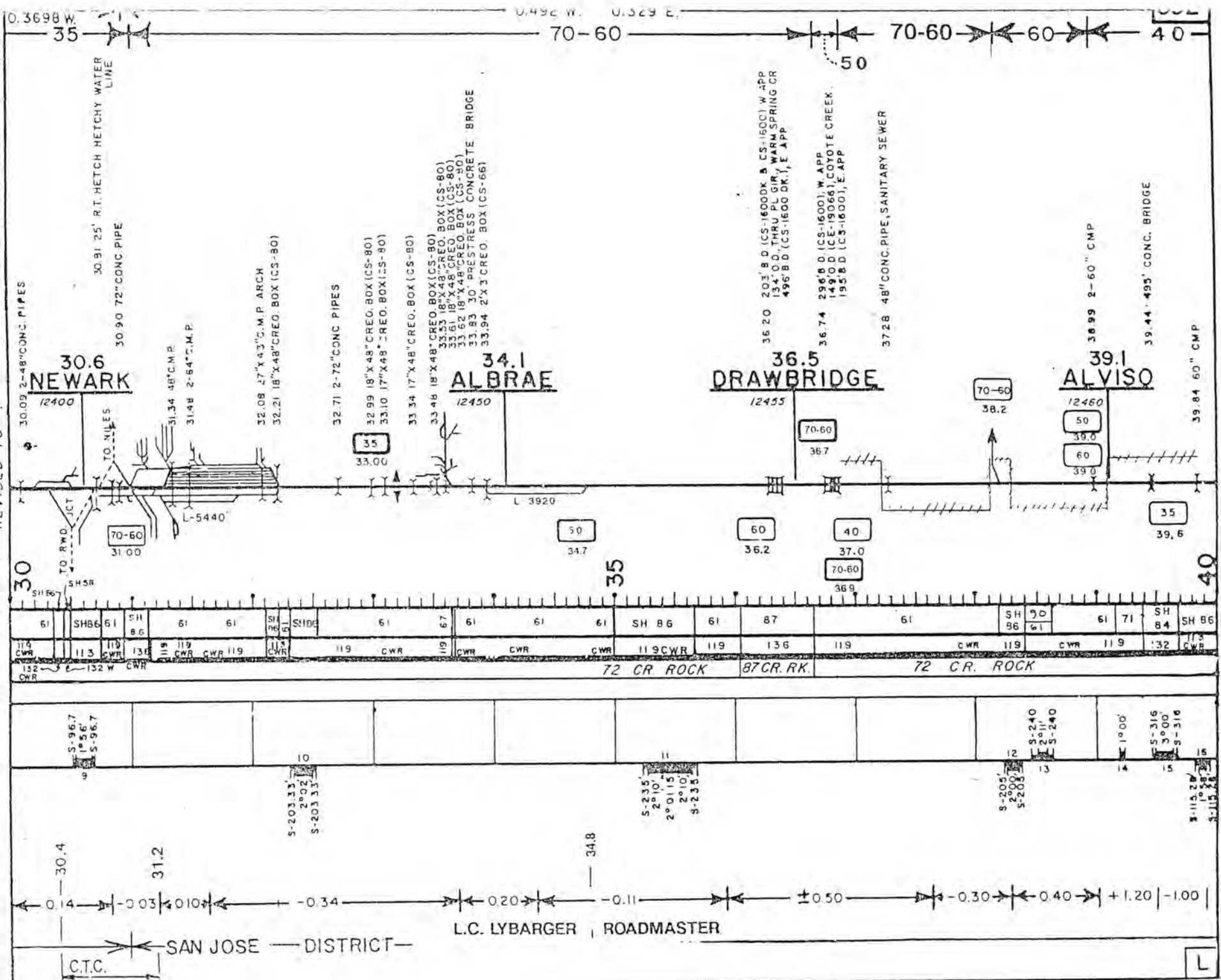

0.3698 W. 35 70-60 70-60 60 40 50

30.09 2-48" CONC. PIPES  
 30.91 25' RT. HETCH HETCHY WATER LINE  
 30.90 72" CONC. PIPE  
 31.34 48" C.M.P.  
 31.48 2-54" C.M.P.  
 32.08 27" X 43" C.M.P. ARCH  
 32.21 18" X 48" CREO. BOX (CS-80)  
 32.71 2-72" CONC. PIPES  
 32.99 18" X 48" CREO. BOX (CS-80)  
 33.10 17" X 48" CREO. BOX (CS-80)  
 33.34 17" X 48" CREO. BOX (CS-80)  
 33.48 18" X 48" CREO. BOX (CS-80)  
 33.53 18" X 48" CREO. BOX (CS-80)  
 33.61 18" X 48" CREO. BOX (CS-80)  
 33.62 18" X 48" CREO. BOX (CS-80)  
 33.83 30" PRESTRESS CONCRETE BRIDGE  
 33.94 2' X 3' CREO. BOX (CS-66)  
 36.20 203' B.D. (CS-16000K & CS-16001) W. APP  
 134' O.D. TRU. PL. GR. WARM SPRING CR  
 496' B.D. (CS-1600 DK.), E. APP  
 36.74 296' B.D. (CS-16001) W. APP  
 149' O.D. (CE-19066), COTYOTE CREEK  
 195' B.D. (CS-16001), E. APP  
 37.28 48" CONC. PIPE, SANITARY SEWER  
 38.99 2-60" C.M.P.  
 39.44 493' CONC. BRIDGE  
 39.84 60" C.M.P.

61	SH 86	61	SH 86	61	61	SH 86	61	61	61	SH 86	61	87	61	61	SH 86	61	71	SH 84	SH 86
119	113	119	136	119	119	119	119	119	119	119	119	136	119	119	119	119	119	119	119

72 CR. ROCK 87 CR. RK. 72 CR. ROCK

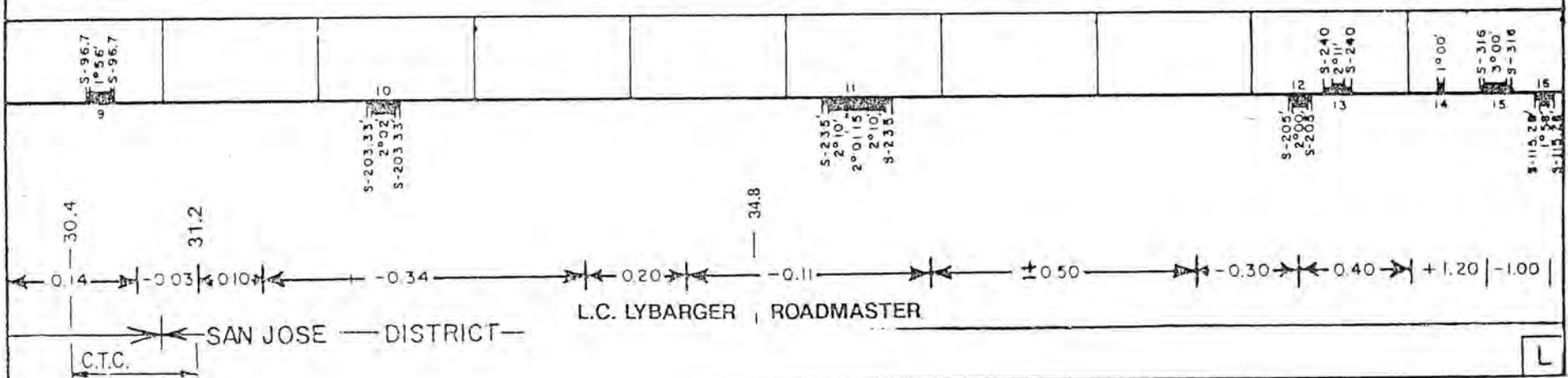

0.4 30.4 0.03 31.2 0.01 0.34 0.20 34.8 0.11 1+0.50 -0.30 0.40 +1.20 -1.00

L.C. LYBARGER, ROADMASTER

SAN JOSE DISTRICT

C.T.C.

L

REVISED TO: JAN 1, 1992

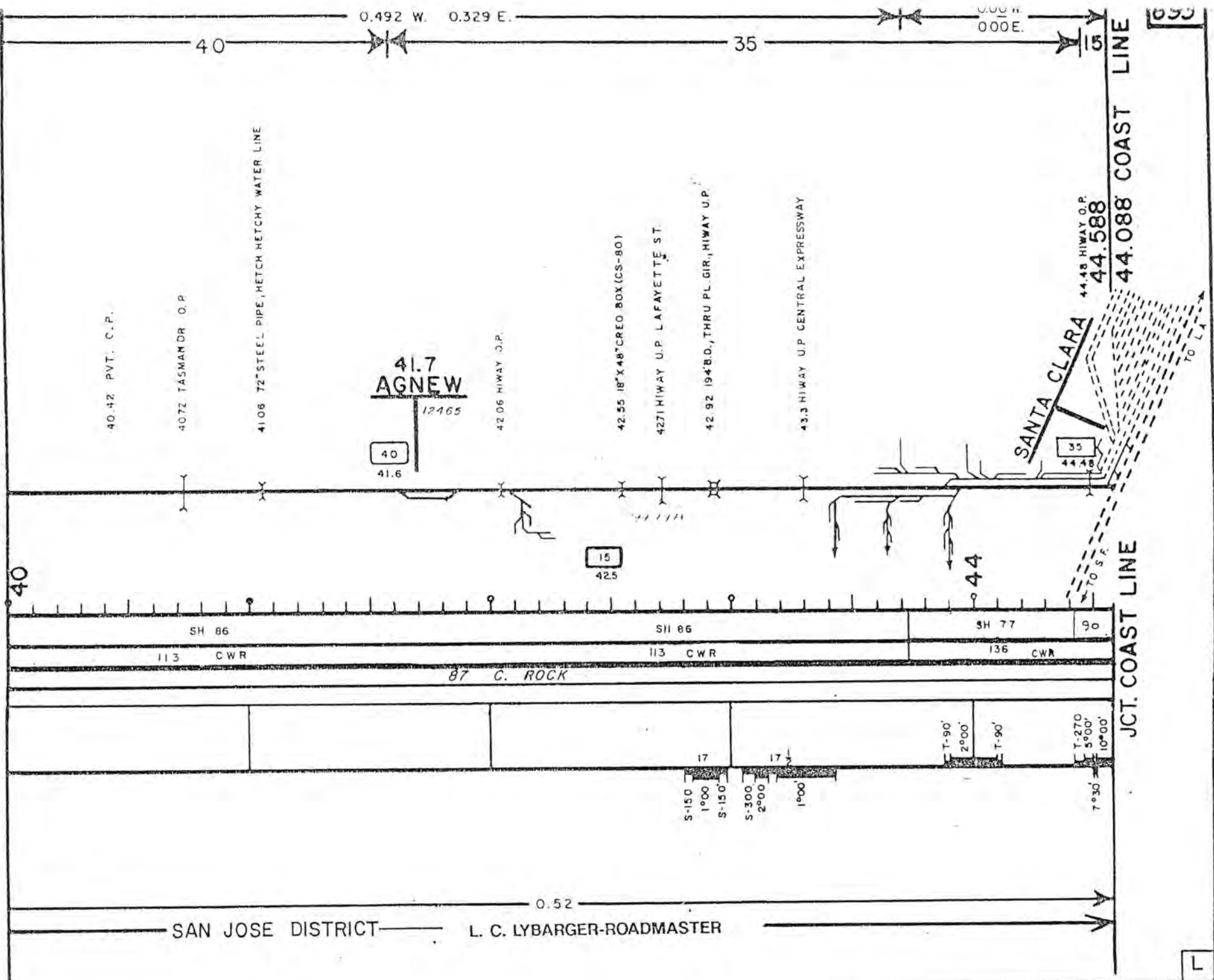

699

L